

Caster Giffin
Tract 3

Description of 5.000 acres

Situated in Section 15, Fraction 1, Town 10, Range 15, Lee Township, Athens County, Ohio and being more particularly described as follows;

Commencing at the northwest corner of Said Fraction 1; thence along the north line of the fraction S 86°23'15" E 651.09 feet to an iron pin set; thence continuing S 86°23'15" E 718.55 feet to an iron pin set in the center of County Road 10 (passing an iron pin set at 698.53 feet); thence along the center of Said Road S 5°55'12" W 300.00 feet to an iron pin set ; thence continuing S 5°55'12" W 248.13 feet to an iron pin set; thence S 26°25'30" W 51.87 feet to an iron pin set at the point of beginning of the tract herein described; thence continuing S 26°25'30" W 300.00 feet to an iron pin set; thence leaving the road N 86°23'15" W 742.44 feet to an iron pin set; thence N 8°58'44" E 277.75 feet to an iron pin set; thence S 86°23'15" E 832.78 feet (passing iron pins set at 105.11 feet and 809.08 feet) to the point of beginning containing 5.000 acres.

Prior deed reference Volume 238, Page 503 Athens County Deed Records.

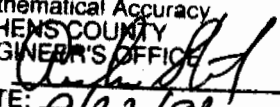

Gregory K. Wright
Registered Surveyor S-6535
17498 South Canaan Road
Athens, Ohio 45701

Description checked for
Mathematical Accuracy
ATHENS COUNTY
ENGINEER'S OFFICE
BY: 
DATE: 9/22/92

Lee #15

1

TO WHOM IT MAY CONCERN:

The following is a computer printout of the coordinates of the attached description. Copies of the plat, the description, and this sheet should be presented to the County Engineer for approval.

DEED COORDINATES AND AREA CALCULATION

Caster Giffin Tract 3

| N/S | DEG | ' | " | E/W | DIST | NORTH | EAST | AREA | DESCRIPTION |
|-----|-----|----|----|-----|--------|----------|----------|---------|-------------|
| S | 26 | 25 | 30 | W | 300.00 | 731.345 | 866.492 | -0.0000 | |
| N | 86 | 23 | 15 | W | 742.44 | 778.125 | 125.527 | 2.3566 | |
| N | 8 | 58 | 44 | E | 277.75 | 1052.471 | 168.876 | 5.0000 | |
| S | 86 | 23 | 15 | E | 832.78 | 999.999 | 1000.001 | 5.0000 | |

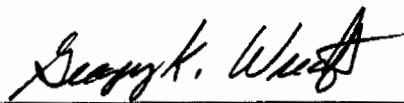

Gregory K. Wright
Registered Surveyor S-6535
17498 South Canaan Road
Athens, Ohio 45701

Caster Giffin
Tract 1

Description of 5.000 acres

Situated in Section 15, Fraction 1, Town 10, Range 15, Lee Township, Athens County, Ohio and being more particularly described as follows;

Commencing at the northwest corner of Said Fraction 1; thence along the north line of the fraction S 86°23'15" E 651.09 feet to an iron pin set at the point of beginning of the tract herein described; thence continuing S 86°23'15" E 718.55 feet to an iron pin set in the center of County Road 10 (passing an iron pin set at 698.53 feet); thence along the center of Said Road S 5°55'12" W 300.00 feet to an iron pin set; thence leaving the road N 86°23'15" W 734.63 feet to an iron pin set (passing iron pins set at 20.02 feet and 729.99 feet); thence N 8°58'44" E 301.08 feet to the point of beginning containing 5.000 acres.

Prior deed reference Volume 238, Page 503 Athens County Deed Records.

Gregory K. Wright

Gregory K. Wright
Registered Surveyor S-6535
17498 South Canaan Road
Athens, Ohio 45701

Description
Mathematical Accuracy
ATHENS COUNTY
ENGINEER'S OFFICE
BY: _____
DATE: _____

Description checked for
Mathematical Accuracy
ATHENS COUNTY
ENGINEER'S OFFICE
BY: *Charles D. Stutz*
DATE: 9/22/92

TO WHOM IT MAY CONCERN:

The following is a computer printout of the coordinates of the attached description. Copies of the plat, the description, and this sheet should be presented to the County Engineer for approval.

DEED COORDINATES AND AREA CALCULATION
Caster Giffin Tract 1

| N/S | DEG | ' | " | E/W | DIST | NORTH | EAST | AREA DESCRIPTION |
|-----|-----|----|----|-----|--------|----------|----------|------------------|
| S | 86 | 23 | 15 | E | 718.55 | 954.725 | 1717.122 | -0.0000 |
| S | 5 | 55 | 12 | W | 300.00 | 656.325 | 1686.180 | 2.4723 |
| N | 86 | 23 | 15 | W | 734.63 | 702.613 | 953.010 | 5.0000 |
| N | 8 | 58 | 44 | E | 301.08 | 1000.004 | 1000.000 | 5.0000 |

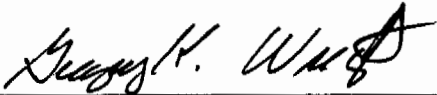

Gregory K. Wright
Registered Surveyor S-6535
17498 South Canaan Road
Athens, Ohio 45701

Fr. 36
Fr. 31 Fr. 1

Lawrence W. &
Marjorie J. Bean
294-337

William E. &
Barbara J. Boggess
327-789

Caster D. & Mary V. Giffin
238-503

Tract 1
217,800 sq. ft.
5.000 acres

Garry Linn & Jennifer Lynn
Ennis
349-107

Tract 2
217,800 sq. ft.
5.000 acres

Tract 3
217,800 sq. ft.
5.000 acres

TRACT 4
308,275 sq. ft.
7.077 acres

Plat of Survey of 4 Tracts
Situated in Section 15, Fraction 1,
Town 10, Range 15, Lee Township,
Athens County, Ohio
Surveyed August 1992 for:

Caster Giffin

Gregory K. Wright
Gregory K. Wright
Registered Surveyor S-6535

Caster D. & Mary V. Giffin
238-503

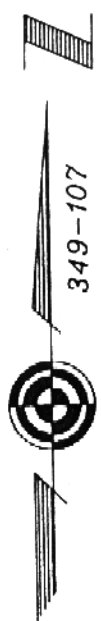

● = Iron Pin Set

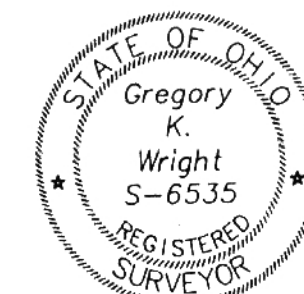
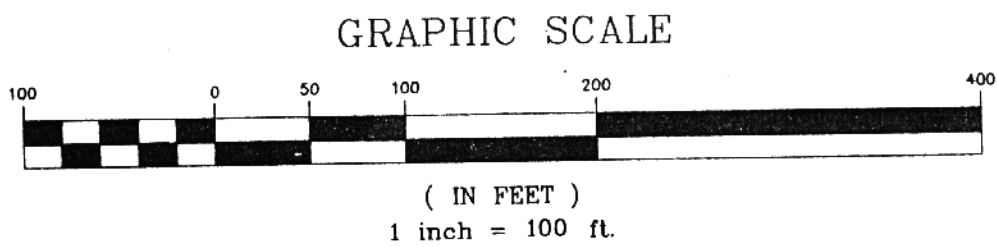

Gregory K. Wright
Professional Engineer
Professional Surveyor
17498 South Canaan Road
Athens, Ohio 45701
614-662-2130

County Road 10

County Road 10

58

78

78