

EXHIBIT "A"

Tract I

Being a part of the tract of land that is now or formerly in the name of Robert & Linda Clark as recorded in Deed Book 308 at page 899, Athens County Recorder's Office, said tract being part of Section 16, T10N, R15W, Lee Township, Athens County, State of Ohio and being more particularly described as follows:

Beginning at a 5/8" X 30" iron pin with a plastic identification cap set on the south line of Section 16 and the grantor's line from which the southeast corner of said section bears South 89 degrees 06 minutes 57 seconds East a distance of 1474.30 feet;

Thence along a grantor's line and the south line of Section 16, North 89 degrees 06 minutes 57 seconds West, passing through a 5/8" X 30" iron pin with a plastic identification cap set at 420.57 feet, going a total distance of 450.57 feet to a point in the center of an existing creek and a grantor's corner;

Thence along a grantor's line and the center of said creek the following six courses:

1. North 07 degrees 02 minutes 34 seconds West a distance of 48.88 feet to a point;
2. North 61 degrees 41 minutes 18 seconds East a distance of 55.37 feet to a point;
3. North 50 degrees 09 minutes 38 seconds West a distance of 83.40 feet to a point;
4. North 51 degrees 26 minutes 27 seconds East a distance of 88.36 feet to a point;
5. North 64 degrees 17 minutes 40 seconds West a distance of 87.88 feet to a point, and;
6. North 22 degrees 21 minutes 28 seconds East a distance of 77.13 feet to a point;

Thence leaving the center of said creek and continuing along the grantor's line the following three courses:

1. North 47 degrees 12 minutes 43 seconds West, passing through a 5/8" X 30" iron pin with a plastic identification cap set at 30.00 feet, going a total distance of 792.00 feet to a 5/8" X 30" iron pin with a plastic identification cap set;
2. South 61 degrees 24 minutes 20 seconds West a distance of 181.50 feet to a 5/8" X 30" iron pin with a plastic identification cap set, and;
3. North 01 degree 24 minutes 20 seconds East, passing through a 5/8" X 30" iron pin with a plastic identification cap set at 68.34 feet, going a total distance of 98.34 feet to a point in the center of County Road 10 and a grantor's corner;

Thence along the center of said road and a grantor's line, North 42 degrees 21 minutes 32 seconds East a distance of 204.17 feet to a point;

Thence leaving the center of said road and continuing along a grantor's line the following two courses:

1. South 65 degrees 15 minutes 33 seconds East, passing through a 5/8" X 30" iron pin with a plastic identification cap set at 30.00 feet, going a total distance of 287.69 feet to a 5/8" X 30" iron pin with a plastic identification cap set, and;
2. North 85 degrees 38 minutes 00 seconds East a distance of 1420.74 feet to a 5/8" X 30" iron pin with a plastic identification cap set on a grantor's corner;

Thence with a new line through the grantor's land, South 00 degrees 52 minutes 21 seconds West a distance of 997.27 feet to a 5/8" X 30" iron pin with a plastic identification cap set on the south line of Section 16;

Thence along the south line of Section 16 North 89 degrees 06 minutes 57 seconds West a distance of 609.63 feet to the point of beginning, containing 28.299 acres, more or less, and subject to the right-of-way of County Road 10 and all easements of record.

All 5/8" X 30" iron pins with plastic identification caps set are stamped "Seymour & Associates".

The bearings used in the above described tract were assumed, and are for the determination of angles only.

The above described tract was surveyed by George F. Seymour, Ohio Professional Surveyor No. 6044, March 31, 1998.

George F. Seymour
George F. Seymour, P.S. #6044

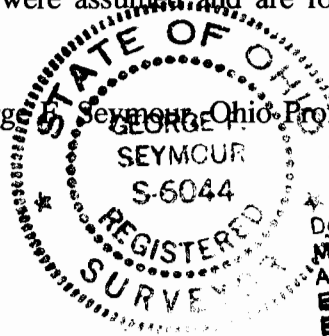

Description checked for
Mathematical Accuracy
ATHENS COUNTY
ENGINEER'S OFFICE
BY: *S. Blawie*
DATE: 5-21-98

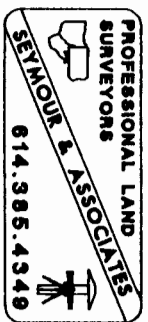

63
LEE #6

EXHIBIT "A"

Tract II

Being a part of the tract of land that is now or formerly in the name of Robert & Linda Clark as recorded in Deed Book 308 at page 899 and Official Record 116 at page 479, Athens County Recorder's Office, said tract being part of Section 16, T10N, R15W, Lee Township, Athens County, State of Ohio and being more particularly described as follows:

Beginning at the southeast corner of Section 16, the northeast corner of Fractional Lot 6 and a grantor's line;

Thence along the south line of Section 16, North 89 degrees 06 minutes 57 seconds West, passing through a 5/8" X 30" iron pin with a plastic identification cap set at 30.00 feet, going a total distance of 864.67 feet to a 5/8" X 30" iron pin with a plastic identification cap set;

Thence leaving the south line of Section 16, North 00 degrees 52 minutes 21 seconds East, passing through a 5/8" X 30" iron pin with a plastic identification cap set at 997.27 feet, going a total distance of 1315.43 feet to an iron pin found on a grantor's corner;

Thence along a grantor's line, South 89 degrees 07 minutes 38 seconds East a distance of 877.06 feet to an iron pin found on the east line of Section 16 and a grantor's corner;

Thence along the east line of Section 16 and a grantor's line, South 01 degree 24 minutes 42 seconds West, passing through a stone found at 336.90 feet, going a total distance of 1315.66 feet to the point of beginning, containing 26.300 acres, more or less, and subject to all easements of record.

All 5/8" X 30" iron pins with plastic identification caps set are stamped "Seymour & Associates".

The bearings used in the above described tract were assumed and are for the determination of angles only.

The above described tract was surveyed by George F. Seymour, Ohio Professional Surveyor No. 6044, March 31, 1998.

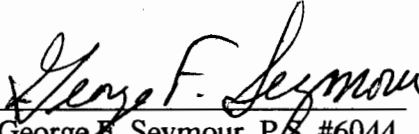
George F. Seymour, P.S. #6044



Description checked for
Mathematical Accuracy
ATHENS COUNTY
ENGINEER'S OFFICE
BY: S. Blause
DATE: 5-21-98

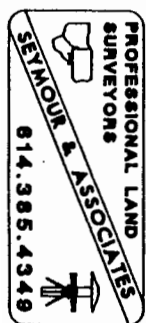

65

EXHIBIT "A"
Tract III

Being a part of the tract of land that is now or formerly in the name of Robert & Linda Clark as recorded in Official Record 116 at page 479, Athens County Recorder's Office, said tract being part of Fraction 12 in Section 9 and part of Fraction 6 in Section 15 T10N, R15W, Lee Township, Athens County, State of Ohio and being more particularly described as follows:

Beginning at the southeast corner of Section 16, the northeast corner of Fractional Lot 6 and a grantor's line;

Thence along the east line of Fractional Lot 6 and a grantor's line, South 01 degree 24 minutes 42 seconds West a distance of 126.74 feet to a 5/8" X 30" iron pin with a plastic identification cap set on a grantor's corner;

Thence along a grantor's line the following two courses:

1. South 88 degrees 36 minutes 11 seconds East a distance of 1118.57 feet to a 5/8" X 30" iron pin with a plastic identification cap set, and;
2. South 01 degree 16 minutes 34 seconds West a distance of 1105.50 feet to an iron pin found on the grantor's southeasterly corner;

Thence along the grantor's south line, North 86 degrees 56 minutes 57 seconds West a distance of 2596.37 feet to an iron pin found on the grantor's southwesterly corner;

Thence along a grantor's line North 01 degree 24 minutes 20 seconds East a distance of 1144.12 feet to a 5/8" X 30" iron pin with a plastic identification cap set on the north line of Fraction 6;

Thence along the north line of Fraction 6, South 89 degrees 06 minutes 57 seconds East, passing through 5/8" X 30" iron pins with plastic identification caps set at 609.63 feet and 1444.30 feet, going a total distance of 1474.30 feet to the point of beginning, containing 39.666 acres in Fractional Lot 6, Section 15 and 28.002 acres in Fractional Lot 12, Section 9, for a total of 67.668 acres, more or less, and subject to the right-of-way of County Road 10 and all easements of record.

All 5/8" X 30" iron pins with plastic identification caps set are stamped "Seymour & Associates".

The bearings used in the above described tract were assumed and are for the determination of angles only.

The above described tract was surveyed by George F. Seymour, Ohio Professional Surveyor No. 6044, March 31, 1998.

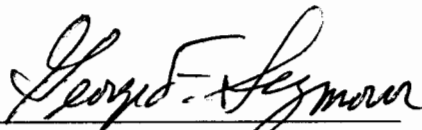
George F. Seymour, P.S. #6044

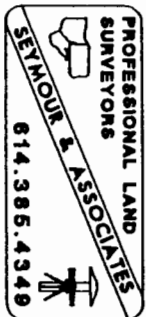

Description checked for
Mathematical Accuracy
ATHENS COUNTY
ENGINEER'S OFFICE
BY: S. Blause
DATE: 5-21-98

67

NOTE: BEARINGS ARE ASSUMED AND ARE FOR THE DETERMINATION OF ANGLES ONLY.

E. MEERS
302-415
S 65° 15' 33" E
287.12'
S 60° 00' 10"
237.44'
N 101° 24' 20" E
98.34'
N 47° 12' 43" W
112.00'
S 22° 21' 28" E
77.13'
N 64° 17' 40" W
87.88'
N 50° 09' 38" W
83.40'
N 07° 02' 54" W
48.88'

J.S. SMITH ETAL
226-205 O.R.

T.T. WAGNER TRUSTEES
141-148 O.R.

R.L. CLARK
308-899

TRACT I
28.299 ACRES
SEC. 16

TRACT II
26.300 ACRES I

R.L. CLARK
308-899

T.T. WAGNER TRUSTEES
141-148 O.R.

T.T. WAGNER TRUSTEES
141-148 O.R.

W.H. CLARK
344-417

R.L. CLARK
116-479 O.R.

P.O.B.
SE COR
SEC. 16, T-10, R-15

TRACT III
67.668 ACRES I TOTAL

R.L. CLARK
116-479 O.R.

TRACT I
39.666 ACRES
FRAC. 6, SEC. 15

R.L. CLARK
116-479 O.R.

TRACT I
28.002 ACRES
FRAC. 12, SEC. 9

R.M. ELLIOTT
232-5 O.R.

L.G.A. RESOURCES INC.
129-644 O.R.

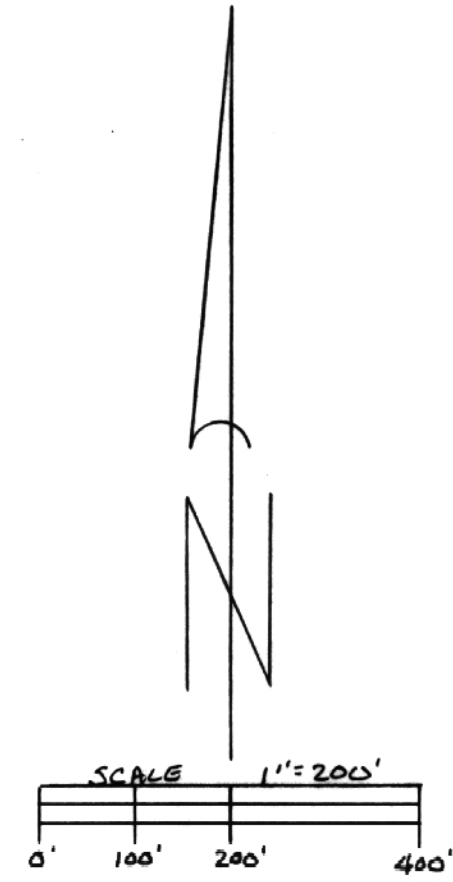

LEGEND

- △ - 3/8" IRON PIN W/ I.D. CAP SET
- ▲ - EXISTING IRON PIN
- - EXISTING STONE
- - POINT

Description checked for
Mathematical Accuracy
ATHENS COUNTY
ENGINEERS OFFICE
BY: S. P. HANSEN
DATE: 5-21-98

REFERENCES

CURRENT TAX PLATS
OLD SURVEY BOOKS
AERIAL PHOTOGRAPHS
DEEDS: AS NOTED ON PLAT

PLAT PREPARED FROM AN ACTUAL
SURVEY MADE ON THE 31ST DAY OF
MARCH, 1998 BY



George F. Seymour
OHIO PROFESSIONAL SURVEYOR
No. 6044

70
seymour and associates consultants
(614) 388-4545
legon, ohio 43138
830 west lumbar street

72
SURVEYED & PLATED AT THE REQUEST OF: LINDA CLARK
BEING A PART OF FRACTION 12 OF SECTION 9, FRACTION 6 OF SECTION 10, AND SECTION 16,
TOWNSHIP 10-NORTH, RANGE 15-WEST, LEE TOWNSHIP, ATHENS COUNTY, STATE OF OHIO.

DATE	5-21-98
BY	S. P. HANSEN
FOR	L.G.A. RESOURCES INC.
FILE	1804 C.T.S. 13304