

HIGHLAND SURVEYING  
80 FAYETTE STREET  
NELSONVILLE OHIO 45764  
614-753-1264

**Description of a 37.369 Acre Tract**

Situate in Section 24, T-10, R-15, Lee Township, Athens County, State of Ohio and being a part of an 80 acre tract as described in Volume 81, Page 429 of the Official Records of Athens County and being more particularly described as follows;

Commencing at the southwest corner of section 24 thence North 19.5 Rods (deed), thence South  $86^{\circ}25'32''$  East, 1484.98 feet to a point in the center of TR-528 said point being the point of beginning of this tract,

THENCE along the center of said road North  $5^{\circ}04'21''$  East, 368.61 feet to a point in the intersection of TR-528 and TR-11,

THENCE along the center of TR-11 South  $84^{\circ}42'53''$  East, 347.75 feet to a Railroad Spike found,

THENCE leaving said road North  $5^{\circ}25'47''$  East, 553.27 feet to an iron pin found at the northeast corner of a 5.02 acre tract (OR171-382)

THENCE North  $89^{\circ}17'53''$  West, 436.26 to an iron pin (calc. location) at the northwest corner of said tract,

THENCE South  $86^{\circ}08'44''$  West, 447.07 feet to an iron pin (calc. location) at the northwest corner of a 5.03 acre tract (OR242-394),

THENCE North  $0^{\circ}11'02''$  East, 456.06 feet to an iron pin (calc. location) at the northeast corner of a 23.79 acre tract (OR170-342),

THENCE South  $86^{\circ}40'31''$  East, 1776.00 feet to an iron pin set at the northeast corner of this original 80 acre tract,

THENCE along the east line of said tract South  $3^{\circ}40'20''$  West, 1294.42 feet to an iron pin set at the southeast corner of said tract,

THENCE North  $86^{\circ}25'32''$  West, 1242.92 feet to the point of beginning of this tract and containing 37.369 acres.

Subject to all Easements and Rights of Way of record

Bearings used are to an assumed meridian and are of irregular determination only

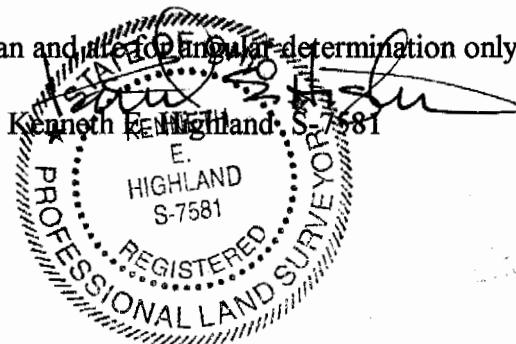

*S. Blaine*  
3-24-97

42

