

SOUTHEASTERN LAND SURVEYS

THOMAS C. TRANTINA
REGISTERED PROFESSIONAL LAND SURVEYOR

RM.301 SCCA BLDG., 2380 OLD RT.33
SHADE, OHIO 45776 740/593-8701

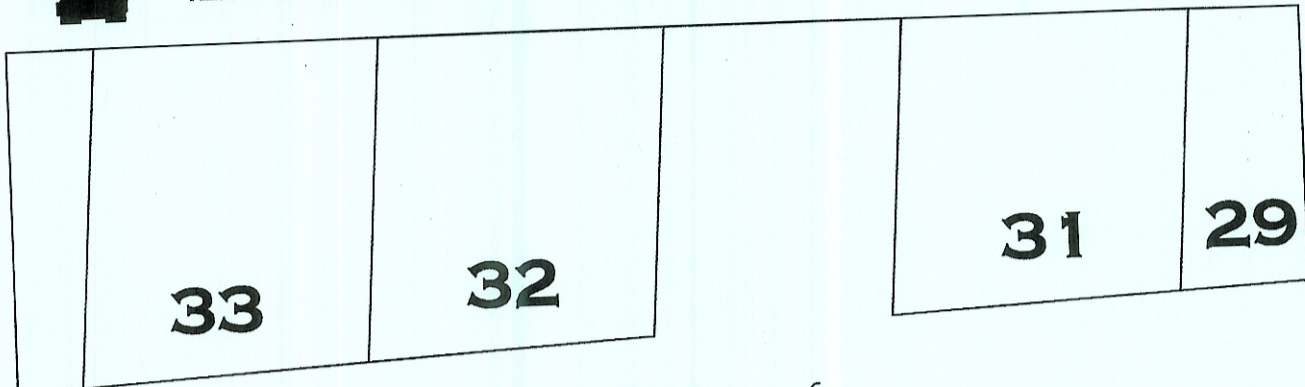

ALTON ST.

POINT OF COMMENCEMENT &
TRUE POINT OF BEGINNING
THE N.W. CORNER OF LOT 47

RICHARD G. &
BERNITA I. STOTTS
386-39

46

0.138 AC. 399
(5992.277 SQ. FT.)

47

ROBERT L. & SALLY J.
WILEY
-2146 D. R.

48

GENERAL TELEPHONE COMPANY
OF OHIO
247-579

65

66

WASHINGTON ROAD



LINE	BEARING	DISTANCE
L1	N 87°00'00" E	86.55'
L2	S 03°45'00" W	48.54'
L3	S 33°06'36" W	40.06'
L4	N 56°30'19" W	13.00'
L5	N 85°53'55" W	55.02'
L6	N 03°45'00" E	66.50'

SURVEY NOTES:

- ALL SET IRON PINS ARE 5/8" DIA. REBAR, 30" LONG WITH YELLOW PLASTIC I. D. CAP INSCRIBED: "TOM TRANTINA RLS-8320"
- BASIS OF BEARING IS N 87°00' E ALONG ALTON STREET.
- BEARINGS ARE TO AN ASSUMED MERIDIAN AND USED TO DENOTE ANGULAR RELATIONSHIP ONLY.
- REFERENCES USED: SURVEYS BY HAROLD WHALEY, GERALD BAYHA, MICHAEL KINNISON, E. H. MOORE & S. B. PRUDEN AND A SURVEY MADE IN APRIL 23, 1907 BY S. H. HIBBARD, ATHENS COUNTY SURVEYOR, & OTHER COUNTY SURVEYS OF RECORD. -TAX PLATS AND DEEDS OF RECORD -EXISTING MONUMENTATION

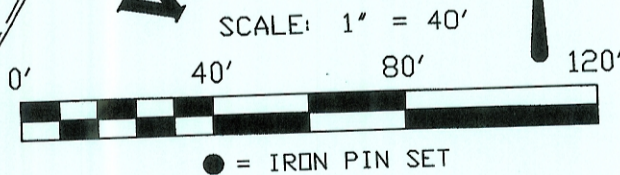

THIS SURVEY WAS PERFORMED WITHOUT THE BENEFIT OF A LAWYER'S TITLE SEARCH IN REGARD TO UTILITY LINES AND RIGHT OF WAYS. BEFORE ANY CONSTRUCTION CONTACT THE OHIO UTILITY PROTECTION SERVICE (1/800-362-2764) FOR THE LOCATION OF ANY UNMARKED UTILITY LINES.

Plat of SURVEY OF A 0.138 ACRE TRACT **Scale:** 1" = 40'

Surveyed for: ROBERT J. & SALLY JO WILEY **Date:** 12/07/06

Subdivision LOT 47, 48 AND LOT 65, VILLAGE OF ALBANY

Township LEE **Section** 2 **Town** 10 **Range** 15

Corporation VILLAGE OF ALBANY **County** ATHENS **Ohio**

Thomas C. Trantina **Job No.** 11012306

Thomas C. Trantina Reg. P.L.S. No. 8320