

EXHIBIT A  
**BRANNER SURVEYING**  
**12500 N. PEACH RIDGE ROAD**  
**ATHENS, OHIO 45701**  
**740-592-5778**

**DESCRIPTION OF A 5.013 ACRE TRACT**

Situated in Fraction 30, Section 21, T.4, R.13, Lodi Township, Athens County, Ohio and being a part of a tract as described in Volume 341, Page 881 of the Official Records of Athens County and being more particularly described as follows:

Beginning at an iron pipe found at the North-west corner of a 2.98 acre tract (97-128 O.R.) , said pipe bears South 83 degrees 34 minutes 28 seconds East, 1600.50 feet (deed) from the South-west corner of Fraction 30;

Thence, from said point of beginning and along Grantor's South fence-line and the North-line of Gibbs( 300-2377 O.R.),  
N 82°57'24" W, 512.68' to an iron pin set in the fence-line;

Thence, along a new line created by this survey:  
N 50°19'51" E, 583.78' to a point in County Road 44, passing an iron pin set at 532.11' f

Thence, along said County Road 44,  
S 73°37'52" E, 365.52' to a point in Grantor's North-east corner;

Thence, leaving said road and along the west-line of Lilly ( 297-549 O.R.)  
S 7°14'49" W 21.23' to an iron pin found;  
S 15°43'15" W, 346.34' to an iron pin found;

Thence, along Grantor's South-line and the North-line of McCarty (97-128 O.R.)  
N 83°34'28" W, 195.97' to the point of beginning and containing **5.013 acres**.

Subject to all easements and rights of way of record.

All iron pins set are 5/8" by 30" long rebar.

Bearings are assumed and are to be used to denote interior angles only.

The above description is based on a survey by John M. Branner P.S. 6805 completed October 2008

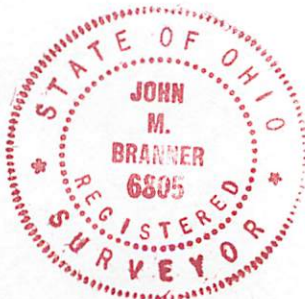
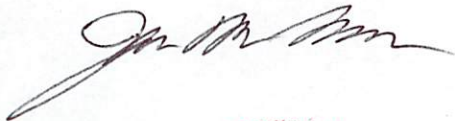

Description Checked for  
Mathematical Accuracy  
Athens County  
ENGINEER'S OFFICE  
BY: Cathy Cantata  
DATE: 10/31/08

GRAVEL DRIVE TO CELL TOWER

BARINGER RENTALS LTD

341-881 O.R.

+532.11'

S 73°37'52"E  
365.52'

COUNTY ROAD 44

S 7°14'49"W  
21.23'

LILLY DENZIL E & DIANA  
1.77AC.  
297-549 O.R.

5.013 Acres

N 50°19'51"E  
583.78'

N 82°57'24"W  
512.68'

GIBBS MARJORIE ANN TRUSTEE  
89.66 AC.  
300-23770R

FENCE-LINE

P.O.B BEARS S 83-34-28 E 1600.50'  
FROM S.W COR OF FR. 30 (DEED)

N 83°34'28"W  
195.97'

MCCARTY MICHAEL A & KELLY D  
2.96 AC.  
97-128 O.R.

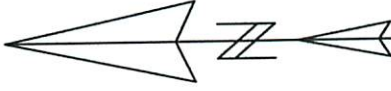

- = IRON PIN FOUND
  - = IRON PIN SET (5/8" X 30" LONG REBAR)
- BEARINGS ASSUMED AND ARE TO BE USED TO DENOTE INTERIOR ANGLES ONLY

SURVEY OF A 5.013 ACRE TRACT IN SECTION 21  
T.4 N., R.13 W, LODI TWP, ATHENS COUNTY, OHIO  
SURVEYED OCTOBER 2008

BY: *[Signature]*  
JOHN M. BRANNER P.S. 6805  
12500 N. PEACH RIDGE ROAD,  
ATHENS, OHIO 45701 (740) 592-5778

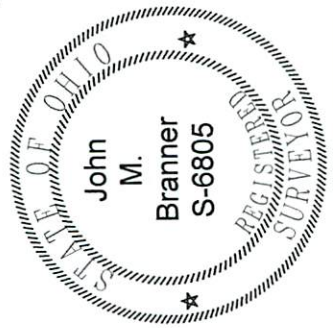

Description Checked for  
Mathematical Accuracy  
Athens County  
ENGINEER'S OFFICE

BY: *[Signature]*  
DATE: 10-31-08