

Stewart-MacDonald Manufacturing Company  
307-245

Reference Iron Pin  
Found at 15'

John David and  
Audrey Young  
266-59

Gregg J. & Vicki L.  
Watson  
343-269

Section 36  
Section 35

TRACT 1  
217,800 sq. ft.  
5.0000 acres

74,660 sq. ft.  
1.7140 acres

TRACT 3  
217,800 sq. ft.  
5.0000 acres

Jerry L.  
Titko  
324-197

TRACT 2  
217,800 sq. ft.  
5.0000 acres

58,325 sq. ft.  
1.3390 acres

Apartment  
48,861 sq. ft.  
1.1217 acres

TRACT 4  
360,611 sq. ft.  
8.2785 acres

Craig H. & Loran E.  
Conley  
351-367

LINE	DIRECTION	DISTANCE
L1	S 23°01'29" W	73.88'
L2	S 73°43'26" W	49.38'
L3	N 88°00'05" W	28.00'
L4	N 70°56'56" W	50.84'
L5	N 49°57'32" W	41.82'
L6	N 31°11'47" W	37.31'

30 Foot Ingress/Egress Easement

- △ = P.K. Nail Found
- ▲ = P.K. Nail Set
- = Iron Pin Found
- = Iron Pin Set

Plat of Survey of Four Tracts  
Situated in Section 35, Town 4, Range 13,  
Lodi Township, Athens County, Ohio  
Surveyed Feb. 22, 1992 for;

Alan Holter

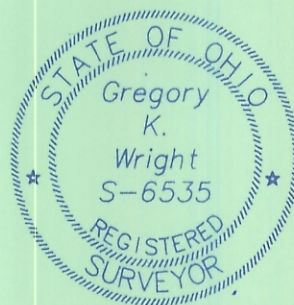

*Gregory K. Wright*  
Gregory K. Wright  
Registered Surveyor S-6535

GRAPHIC SCALE

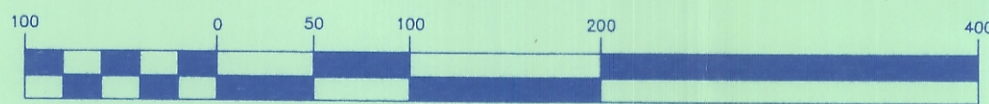

( IN FEET )  
1 inch = 100 ft.