

BY: Priscilla Wilton
DATE: 7/24/20

Exhibit A
0.238 ACRES

Description of a parcel of land situate Ohio Company Purchase, Town 4, Range 13, Section 3, Lodi Township, Athens County, Ohio and being more fully described as follows:
Being part of a tract deeded to Richard Paul Howard and Nancy Elizabeth Howard,
Official Record Book 556,-pages 223-226.

Commencing at the southeast corner of Section 3;
Thence N88°54'00"W 2651.52 feet to an iron pin set;
Thence N57°38'09"E 318.58 feet to an iron pin set;
Thence N36°48'11"W 1051.62 feet to an iron pin set at the point of beginning of the tract herein described;

- 1.) Thence N08°29'34"E 195.84 feet over the lands of Howard 556-223 to an iron pin set;
- 2.) Thence N37°23'48"E 219.13 feet over the lands of Howard 556-223 to an iron pin set;
- 3.) Thence S23°46'23"W 401.88 feet along a common boundary to Howard 556-223 and Radford 519-1802 to the point of beginning containing a total of 0.238 acres.

Said tract is to remain continuous and contiguous with the 13.298 acres now deeded to Radford 528-696.

Plat of Survey is attached herewith and made a part thereof.
Subject to all easements, rights-of-way, and covenants and agreements of record.
All Iron Pins set are 30 inches in length #5 rebar capped" NEWMAN PS 8043"
Basis of bearings the denoted south line of Section 3.
A true Meridian has not been determined.
Survey completed by Charles T. Newman, Licensed Professional Surveyor 8043 on July 22, 2020.

Charles T. Newman
Charles T. Newman PS
66 Elmwood Place
Athens, Ohio 45701

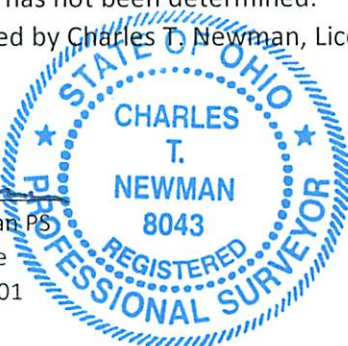

Legal Description Pre-Approval
APPROVED
All transfers are subject to
Athens County Conveyance Standards

JUL 29 2020

Jill Thompson
Athens County Auditor

C. TIM NEWMAN

Professional Surveyor

66 Elmwood Place
Athens, Ohio 45701

740-594-1884
FAX 740-594-9413



Plat of Survey of 0.238 Acres
Situating Ohio Company Purchase Town 4, Range 13, Section 3,
Lodi Township, Athens County, Ohio.
Being a part of the lands deeded to:
Richard Paul Howard and Nancy Elizabeth Howard,
Official Record Book 556, pages 223-226.



Charles T. Newman
Charles T. Newman
Surveyed 7/22/2020

LINE TABLE		
LINE	BEARING	LENGTH
L1	N08°29'34"E	195.84
L2	N37°23'48"E	219.13
L3	S23°46'23"W	401.88

0.238 ACRES



6.602 Acres
Radford 519-1802

Radford 528-696

Howard 556-223

13.298 ACRES

Hogue Hollow
C-47

N 36°48'11" W
1051.62'

Transfer between adjoining owners. Not a subdivision. Health Dept. approval not required. No new building site intended. OK to transfer. Bob Eichenberg 9-14-2020

Legal Description Pre-Approval
APPROVED
All transfers are subject to
Athens County Conveyance Standards

JUL 29 2020

Jill Thompson
Athens County Auditor

Description Checked for
Mathematical Accuracy
Athens County
ENGINEER'S OFFICE
BY: *Robert Williams*
DATE: 7/24/20

N 57°38'09" E
318.58'

N88°54'00"W
2651.52'

Southeast
Corner
Section 3
Lodi Twp.

Section 3
Section 2

GRAPHIC SCALE



(IN FEET)
1 inch = 200 ft.

● = Iron Pin Set