

BY: Brenda Williams  
DATE: 5/20/20

Exhibit A  
Description of 0.089 Acres

Description of a tract of land situate the Ohio Company Purchase Town 15, Range 12,  
City of Nelsonville, Ohio.

Deeded to Athens County Treasurer,

Journal Entry Order of Forfeiture Official Record Book 562, pages 641-643.

Parcels P030160004500, P0301600004600, P030160004700 and P0301600004800.

Commencing at the southeast corner of Lot 884 W.W. Myers Addition to Nelsonville,  
Envelope 87A, a recorded plat of record.

Thence N05°00'00"E 60.00 feet along the west right-of-way of Monroe Street to an iron pin set at the  
point of beginning of the tract herein described;

1.) Thence N79°47'03"W 47.54 along a common boundary to the Athens County Treasurer 652-641 and  
Blair 491-1702 to an iron pin set on the west boundary of said Lot 884;

2.) Thence N66°13'47"W 11.00 feet along a common boundary to the Athens County Treasurer 652-641  
and Crabtree 454-2563 to an iron pin set;

3.) Thence N06°04'12"W 69.80 feet along said common boundary to an iron pin set on the south right-of-  
way of Canal Street;

4.) Thence S66°35'00"E 75.00 feet along the south right-of-way of Canal Street to an iron pin found;

5.) Thence S05°00'00"W 52.67 feet along the west right-of-way of Monroe Street to the point of  
beginning containing a total of 0.089 acres.

Plat of Survey is attached herewith and made a part thereof.

Subject to all easements, rights-of-way, covenants and agreements of record.

Iron pins set are 30 inches length number 5 rebar capped "NEWMAN PS-8043"

Basis of bearings the denoted west boundary of Monroe Street referenced to the Canal Survey 424A.

A true meridian has not been determined.

The above boundary description was based on an actual field survey and completed by

Charles T. Newman Professional Surveyor 8043 on May 18, 2020.

  
Charles T. Newman  
Professional Surveyor  
66 Elmwood Place  
Athens, Ohio 45701

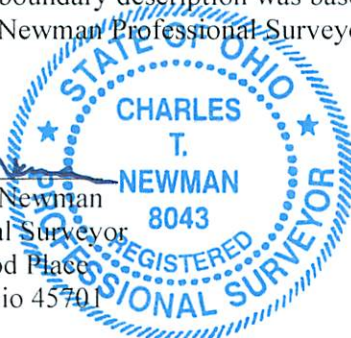

Legal Description Pre-Approval  
**APPROVED**  
All transfers are subject to  
Athens County Conveyance Standards

MAY 20 2020

Jill Thompson  
Athens County Auditor

C. TIM NEWMAN  
Professional Surveyor

66 Elmwood Place  
Athens, Ohio 45701

740-594-1884  
FAX 740-594-9413

Plat of Survey of 0.089 Acres  
Situating Ohio Company Purchase, Range 12, Town 15,  
City of Nelsonville, Ohio.  
Surveyed May 2020

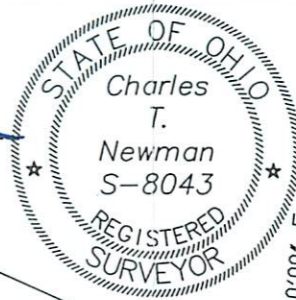

*Charles T. Newman*  
Charles T. Newman

NS Commons  
Kleingers Survey  
524-1595

Old Canal



Basis of Bearings:  
Denoted West R/W Monroe St.  
True North Not Determined

- ⬢ Bolt Found 1"
- ▲ Iron Pin Found pipe 3/4"
- ⊙ Iron Pin Found capped
- Iron Pin Set capped
- △ Iron Pin Found pipe 1.5"

Documents Referenced:  
O.R. 562/641 Journal Entry  
Abandoned Hocking Canal Plat 424A  
W.W. Myers Addition Plat 87C  
Deeds as referenced on plat.

LINE TABLE

LINE	BEARING	LENGTH
L1	N79°47'03"W	47.54
L2	N66°13'47"W	11.00
L3	N06°04'12"W	69.80
L4	S66°35'00"E	75.00
L5	S05°00'00"W	52.67

GRAPHIC SCALE



( IN FEET )  
1 inch = 40 ft.

Description Checked for  
Mathematical Accuracy  
Athens County  
ENGINEER'S OFFICE  
BY: *Bryan Williamson*  
DATE: 5/20/20

