

0.670 Acres

Situate Ohio Company Purchase, Town 11, Range 15, Section 15, Waterloo Township, Athens County, New Marshfield, Ohio.

Being deeded to and a portion of: The Donna B. Dearth Trust, and the George Coe Dearth Trust; Official Record Book 217, pages 264-265.

Commencing at an iron pin found capped Canter at the southwest corner of Lot 3 of the platted Mayhugh's Addition to New Marshfield of Envelope 82C, and now noted on Tax Plat as Lot 52;
Thence N88°38'34"W 57.60 feet to a point;
Thence S00°10'50"E 60.02 feet to an iron pin set at the point of beginning of the tract herein described;

- 1.) Thence S88°38'34"E 219.24 feet along the south boundary of Old State Route 56 to an iron pin set;
- 2.) Thence S01°45'18"E 79.40 feet over the lands of the parent tracts to an iron pin set;
- 3.) Thence along a curve to the right having a radius of 1888.83 feet, length of 240.78 feet, chord bearing of S66°43'51"W, and a chord distance of 240.61 feet to an iron pin set, and being a common boundary to the north right-a-way of CXS 115-500, Track Map of the Baltimore and Ohio V145.1, pg. 28;
- 4.) Thence N00°10'56"W 179.61 feet along a common boundary to Bowles 570-626 to the point of beginning containing a total of 0.670 acres.

Plat of Survey is attached herewith and made a part thereof.

Subject to all easements, rights-of-way, covenants and agreements of record.

Iron Pins Set are number 5 rebar, 30-inches in length capped NEWMAN PS-8043

Basis of bearings : NAD 83 Ohio South

Survey completed by Charles T. Newman, Licensed Professional Surveyor 8043 on September 5, 2023.

Charles T. Newman PS
66 Elmwood Place
Athens, Ohio 45701



Description Checked for
Mathematical Accuracy
Athens County
ENGINEER'S OFFICE

BY: 
DATE: 9/8/23

C. TIM NEWMAN

66 Elmwood Place
Athens, Ohio 45701

740-594-1884
740-591-5269

Professional Surveyor

Plat of Survey of 0.670 Acres and 0.130 Acres.
Situat Ohio Company Purchase, Town 11, Range 15, Section 15,
Waterloo Township, Athens County, New Marshfield, Ohio.
Being the entirety of the lands deeded to:
Donna B. Dearth Trust and the George Coe Dearth Trust,
Official Record Book 217, pages 264-265.

Description Checked for
Mathematical Accuracy
Athens County
ENGINEER'S OFFICE

BY: *Charles T. Newman*
DATE: 9/8/23

Charles T. Newman
Charles T. Newman
Surveyed September 2023

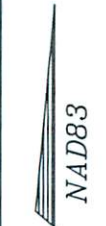
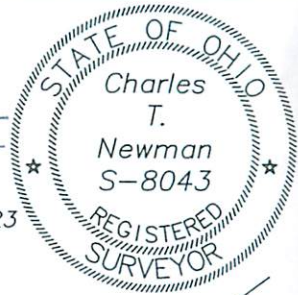

Basis of Bearings:
NAD83 Ohio South

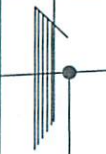

Newman Survey 2021

Highland Survey 1995

N482286.5
E2047365.1

Bowles
570-626

N 00°10'56" W
179.61'

CXS 115-500
Baltimore/Ohio R.R.
Track Map V145.1 pg. 28

N 88°38'34" W
60.02'

57.60'

52
Canter Survey Morris Survey
2013

Old St. Rt. 56

S 88°38'34" E
219.24'

Dearth
217-264
0.670 ACRES

Mayhugh
2nd Addition
82C

L=240.78'
R=1888.83
Chord Bearing S66°43'51"W
Chord Distance 240.61'

S 88°38'34" E
138.17'

0.130 ACRES

L=155.62'
R=1888.83
Chord Bearing S60°43'11"W
Chord Distance 155.58'

N482278.2
E2047722.4

S 01°45'18" E
79.40'

- ▲ Iron Pin Found Highland
- ▲ Iron Pin Found capped Morris
- Iron Pin Found capped Canter
- Iron Pin Set capped Newman
- Stone Found
- ⊕ Iron Pin Found 1" OD

GRAPHIC SCALE



(IN FEET)

1 inch = 60 ft.

Prior Surveys, Deeds, and R.R. Plans uses as noted on Plat