

LEGEND

- SET 5/8" CAPPED IRON REBAR
- FOUND IRON ROD/REBAR
- ⊗ POINT
- P — PROPERTY LINE
- - - - - RIGHT OF WAY
- - - - - LOT LINE
- - - - - TAX PARCEL LINE
- x - - - BARBED WIRE FENCE
- ▤ STRUCTURE

REFERENCES
 BEING A PART OF FRACTION 32
 SECTION 27, TOWN 5, RANGE 11
 COOLVILLE CORPORATION
 TROY TOWNSHIP
 ATHENS COUNTY, OHIO

PARIDS:
 L020040005900 & L020040006000
 OFFICIAL RECORD 496, PAGE 2147

PLATS ON FILE IN THE ATHENS
 COUNTY, OHIO, TAX MAP OFFICE.

LIMITATIONS OF SURVEY:
 THIS SURVEY WAS PERFORMED WITHOUT
 THE BENEFIT OF A TITLE OPINION
 AND THEREFORE IS SUBJECT TO ANY
 STATEMENT OF FACTS REVEALED BY
 EXAMINATION OF SUCH DOCUMENTS AND
 IS SUBJECT TO ALL LEGAL RIGHTS OF
 WAY, EASEMENTS, AND RESTRICTIONS
 OF RECORD. NO OPINION IS MADE OR
 EXPRESSED CONCERNING THE
 EXISTENCE OF WETLANDS, FLOOD
 HAZARDS, ENVIRONMENTAL
 CONDITIONS, HAZARDOUS MATERIALS,
 UTILITIES, OR ITEMS THAT MAY
 EFFECT THE USE OF PROPERTY
 SURVEYED.

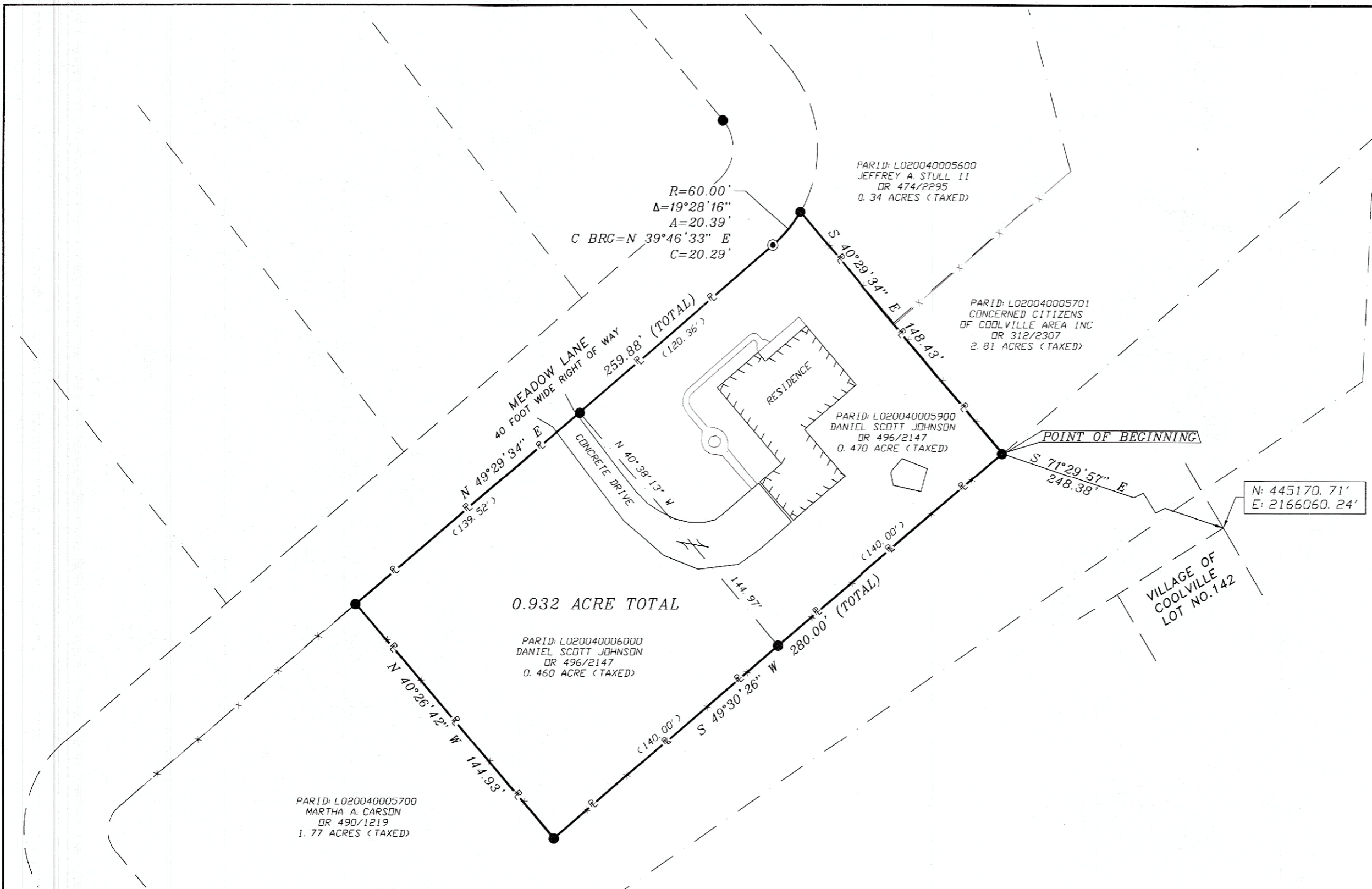

N: 445170.71'
 E: 2166060.24'

Description Checked for
 Mathematical Accuracy
 Athens County
 ENGINEER'S OFFICE
 BY: *Rebecca J. Williams*
 DATE: 9/10/21

STATE OF OHIO
 RANDALL R. CLINE II
 S-8096
Randall R. Cline II
 RANDALL R. CLINE II
 P. S. # 1979WV, 8096DH

PICKERING ASSOCIATES
 Architects • Engineers • Surveyors

11283 EMERSON AVENUE, PARKERSBURG, WV 26104
 (304) 464-5305 PICKERING USA.COM

PART FRACTION 32
 SECTION 27, TOWN 5, RANGE 11
 COOLVILLE CORPORATION, TROY TOWNSHIP
 ATHENS COUNTY, OHIO

BOUNDARY SURVEY
COMBINING EXISTING PARCELS:
0.932 ACRE

08/16/2021
 PROJ: #2212860