

Edward L. & Geneva M. Pitner
250-109

Plat of Survey of 12.1623 Acres
Situated in Section 17,
Town 6, Range 12,
Rome Township,
Athens County, Ohio
Surveyed Nov. 1991 for:

Nellie L. Flowers

12.1623 acres
529,790 sq. ft.

Federal Creek

Featherstone Road

N 08°09'00" W
444.77'

N 82°44'49" E
160.00'

N 82°44'49" E
248.10'

N 59°18'52" E
156.46'

N 64°56'35" E
232.84'

N 84°06'59" E
163.45'

S 12°52'46" E
570.80'

T-192

N 89°45'00" W
113.64'

S 89°52'11" W
194.62'

S 73°56'18" W
269.39'

N 89°32'00" W
108.46'

S 89°59'43" W
143.17'

N 90°00'00" W
146.67'

S 17°33'32" W
58.74'



Deed 324-944

Edward L. & Geneva M. Pitner
250-109

Gregory K. Wright
Gregory K. Wright
Registered Surveyor S-6535

Nellie L. Flowers
324-944

- ▲ = Railroad Spike Set
- = Iron Pin Found
- = Iron Pin Set

GRAPHIC SCALE

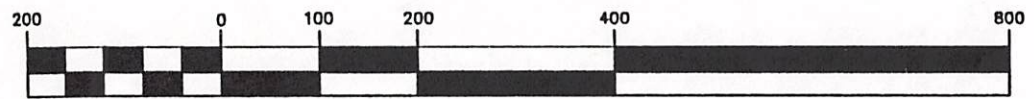

(IN FEET)
1 inch = 200 ft.

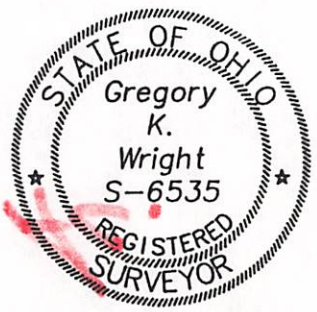

Nflowers.dwg

15.10
10/10/11

7/24