

**Description of a 19.125 acre Tract**

Situated in Section 18, T.6,R.12, Rome Township, Athens County, Ohio and being part of Parcel One as described in Volume 467, Page 448 of the Official Records of Athens County and being more particularly described as follows:

Beginning at an iron pin set in the South-line of section 18, said pin bears North 87 degrees 39 minutes 03 seconds West, 2574 feet from the South-east corner of said section 18 and pin also being the south-west corner of the Martin(84-180 O.R.) 47.50 acre tract;

Thence, along the south-line of Section 18 and the North -line of the Martin 2.50 acre tract ( 204-550 O.R.),N 87° 39' 03" W, 200.52 feet to a point in Federal Creek;

Thence, up Federal Creek the following bearings and distances:

N 26° 49' 22" E, 208.51 feet;

N 21° 22' 32" E, 808.64 feet;

N 17° 19' 46" E, 273.41 feet;

N 9° 41' 51" E, 403.35 feet;

N 4° 34' 42" E, 301.05 feet;

N 13° 16' 24" E, 118.60 feet to the mouth of Big Run;

Thence, up Big Run and being along the south-lines of Purk (457-2460 O.R.) and Mast(477-1381 O.R.) the following bearings and distances:

N 88° 32' 42" E, 246.27 feet;

N 80° 11' 16" E, 116.14 feet;

S 85° 55' 2" E, 119.65 feet;

N 53° 21' 51" E, 147.00 feet;

N 65° 57' 45" E, 233.88 feet;

N 69° 01' 4" E, 97.02 feet to a point in Featherstone Road;

Thence, along said road:

S 0° 14' 17" W, 90.48 feet;

S 35° 00' 30" W,176.56 feet;

S 45° 06' 46" W,72.76 feet;

S 49° 37' 1" W, 157.59 feet to an iron pin set in the Abandoned M&C rail road bed and in the Right of Way of Featherstone Road;

Thence, with said abandoned M&C Railroad bed and the west-lines of the Hill 8 acre tract( 298-1204 O.R.)

S 37° 26' 43" W,131.00 feet to an iron pin set;

S 35° 07' 40" W,277.86 feet to an iron pin set;

S 29° 07' 40" W,747.78 feet to an iron pin set where a Sycamore Tree(original bearing tree as per County Surveyor Records Volume 7, Page 221) bears South 35 degrees West, 22 feet;

Thence, leaving abandoned railroad bed and along the South-line of the Hill 8 acre tract (298-1204 O.R.)

S 89° 32' 1" E, 151.15 feet to an iron pin set;

Thence, along the west-line of the Hill 2.5 ac tract (298-1204 O.R.) and the west-line of the Martin Tract 47.50 acre tract ( 84-180 O.R.)

S 32° 39' 29" W,1048.12 feet to an iron pin set and being the point of beginning and containing 19.125 acres.

Subject to all easements and rights of way of record.

Iron pins set are 5/8' by 30 inch rebar

Bearings: Grid North N.A.D. 1983

The above description is based on a field survey completed October 2012 by

John M. Branner P.S. 6805

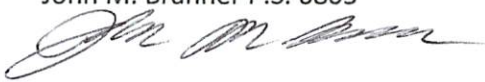

Description Checked for  
Mathematical Accuracy  
Athens County  
ENGINEER'S OFFICE  
*S. Blause*  
DATE: 10-30-12

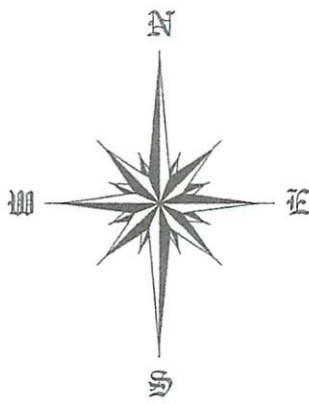

Line	Bearing	Distance
1	S 00° 14' 17" W	90.48'
2	S 35° 00' 30" W	176.56'
3	S 45° 06' 46" W	72.76'

**19.125 Acres**  
**J&L WOODWORKING**  
**MILLER PAUL P -JR**  
**DUNDEE HARDWOODS LLC**  
 467-448 O.R.  
 Part of Parcel 1

S 60° 22' 20" E  
 67.98'  
**J&L WOODWORKING**  
**MILLER PAUL P -JR**  
**DUNDEE HARDWOODS LLC**  
 5.07 Acres  
 475-63 O.R.

**BRUNER LAND COMPANY INC**  
 475-59 O.R.

Robert and Velma Hill  
 298-1204 O.R.  
 (8ac.)

Robert and Velma Hill  
 298-1204 O.R.  
 (2.5 ac.)

Donald E. Martin  
 84-180 O.R.

*John M. Branner*  
**John M. Branner P.S. 6805**  
 62 East First Street  
 The Plains, Ohio  
 740-541-0350

Description Checked for  
 Mathematical Accuracy  
 Athens County  
**ENGINEER'S OFFICE**  
 BY: *S. Blause*  
 DATE: *10-30-12*

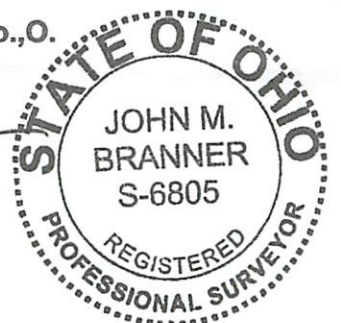

Scale 1 inch = 200 feet  
 ● = iron pin set 5/8"x30" long rebar  
 Bearings: Grid North N.A.D. 83  
 Ref docs.: Tax Plat-Deeds, County Survey V.7, Pg 221

S.E. Cor of  
 Section 18

Martin 200.52'  
 84-180 O.R.  
 2.50 ac.  
 2574' = 39 chains = deed and survey

