

**DESCRIPTION OF A 1.075 ACRE TRACT
(Combining Two Existing Tracts)**

Situated in Section 25, Rome Township, Athens County, Ohio and being all of the Isabella D. Barnhart Tracts (335-373 & 450-1502 O.R.) and being more particularly described as follows:

Commencing at the South-^{WEST} *JMB*-east-corner of Section 25, thence, South 87 degrees 18 minutes 23 seconds East, 1549.80 feet to a point; thence, North 07 degrees 57 minutes 22 seconds West, 272.95 feet to the South-west corner of the Isabella D. Barnhart Tract (Parcel# K01-00100502-00) and being the point of beginning for the tract of land herein described:

Thence, along the lines of a Dane L. and Patricia C. Cogar Tract (285-275 O.R.),
N 7°57'22" W, 247.90 feet;
N 8°22'00" W, 165.30 feet;
N 75°36'07" E, 166.56 feet;
Thence, along the lines of the State of Ohio (right of way for Green Branch Road)
S 4°18'58" E, 65.00 feet;
S 16°49'43" W, 131.05 feet;
S 2°52'05" E, 214.25 feet;
S 60°10'16" W, 92.95 feet to the point of beginning and containing 1.075 acres.

Subject to all easements and rights of way of record.

The above description is based on the ODOT Right of Way Plan 50-25.05 sheet 9 of 13 and not on a field survey.

The above description was prepared by John M. Branner P.S. 6805 completed October 2010.

John M. Branner

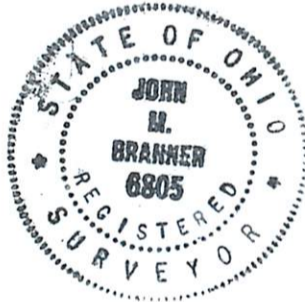

Description Checked for
Mathematical Accuracy
Athens County
ENGINEER'S OFFICE
BY: *S. Blaus*
DATE: 8-3-11

Patricia Cogar
163-777

N 75°36'07"E
166.56'

Isabella D. Barnhart
335-373 &
450-1502 O.R.

K01-00100502-00

1.075 Acres

Total of combined Tracts

S 81°58'16"W (0.572 Ac.)
105.26' (0.503 Ac.)

K01-001-00502-00

COGAR DANE L
& PATRICIA C
285-275OR

N 7°57'22"W
247.90'

S 2°52'05"E
214.25'

S 60°10'16"W
92.95'

N 7°57'22"W
272.95'

S.W. COR. OF SEC. 25

N 87°18'23"W 1549.80'

GREEN BRANCH ROAD
STATE OF OHIO



SCALE 1 INCH = 50 FEET

Bearings are based on
ODOT R/W Plans

Checked for
Mathematical Accuracy

Athens County

ENGINEER'S OFFICE

BY: S. Blause

DATE: 3-8-11

Map based on ODOT R/W

Survey Ath-50-25.05

Sheet 9 of 13 to combine the
residual of the Patricia Cogar
Tracts.

Prepared By:

John M. Branner P.S.6805
12500 N. Peach Ridge Rd.
Athens, Ohio 45701
740-592-5778

