

Description Checked for
Mathematical Accuracy
Athens County
ENGINEER'S OFFICE
BY: Brand William
DATE: 8/31/15

Exhibit A
Description of 0.388 Acres

Description of a parcel of land situate Ohio Company Purchase, Town 11, Range 14, Trimble Township, Section 13, Athens County, Ohio, and being all of Out Lot 135 of Jacksonville (Redtown), recorded plat Book 3, Page 28, Envelope 146B;

Beginning at a point in the center of County Road 67 (Taylor Ridge) and being the northwest corner of said Out Lot 135, and being S86°40'42"E 3722.00 feet from a pin found at the Northwest Corner of the Southwest Quarter of said Section 13;

- 1.) Thence S86°40'42"E 208.85 feet along the north line of Out Lot 135, and the south line of Out Lot 134, of (Moleski D. 234/771 OR) to an iron pin set, passing an iron pin set at 30.00 feet;
- 2.) Thence S03°37'32"W 153.69 feet along the east line of Section 13, and being a common boundary to (D. Moleski 234/771 OR), and (G. Moleski 451/1906) to a point in the center of County Road 67, passing an iron pin set at 123.69 feet;
- 3.) Thence N49°13'53"W 22.70 feet to a point in the center of County Road 67;
- 4.) Thence N53°49'43"W 73.35 feet to a point in the center of County Road 67;
- 5.) Thence N52°00'44"W 68.17 feet to a point in the center of County Road 67;
- 6.) Thence N47°44'07"W 69.12 feet to a point in the center of County Road 67;
- 7.) Thence N42°44'53"W 25.77 feet to the point of beginning containing a total of 0.388 acres.

Prior Deed Referenced: Athens County Official Record Book 234, Page 771
Subject to all easements, rights-of-way, covenants, and agreements of record.

Charles T. Newman
Charles T. Newman
Professional Surveyor
66 Elmwood Place
Athens, Ohio 45701
Surveyed August 28, 2015



Legal Description Pre-Approval
APPROVED
All transfers are subject to
Athens County Conveyance Standards

SEP 01 2015

Jill Thompson
Athens County Auditor



C. TIM NEWMAN
Professional Surveyor

66 Elmwood Place
Athens, Ohio 45701

740-594-1884
FAX 740-594-9413



NW Corner of the
SW Quarter

S86°40'42"E
3722.00"

+3539.95'

+30.00'

Moleski D
234/771 OR
Outlot 134

S86°40'42"E
208.85'

Section 13
Section 7

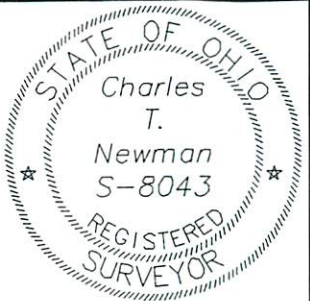

Plat of Survey of 0.388 acres
Situat Ohio Company Purchase, Town 11, Range 14,
Trimble Township, Section 13, Athens County, Ohio
Being all of Out Lot 135 of Jacksonville (Redtown) of
a recorded plat, Athens County Recorder's Envelope 146B

Surveyed August 28, 2015

Charles T. Newman

Charles T. Newman
Professional Surveyor

Moleski D
234/771 OR

Outlot 135
0.388 Acres

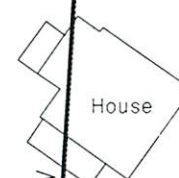

Moleski G
451/1906

Outlot 52

S03°37'32"W
153.69'
+123.69'
(25.76')
(870.69')
(91.78')
S03°37'32"W

LINE TABLE		
LINE	BEARING	LENGTH
L1	N49°13'53"W	22.70
L2	N53°49'43"W	73.35
L3	N52°00'44"W	68.17
L4	N47°44'07"W	69.12
L5	N42°44'53"W	25.77

Description Checked for
Mathematical Accuracy
Athens County
ENGINEER'S OFFICE

BY: *Brian Williams*
DATE: 8/31/15

GRAPHIC SCALE



(IN FEET)

1 inch = 50 ft.

● = Iron Pin Found (PS 8231)

● = Iron Pin Set (PS 8043)

C-67 Taylor Ridge