



**PARCEL 1**

Situate in Section 15, Trimble Township, County of Athens, State of Ohio and Village of Glouster. Being a part of Outlot No. 2 in O.D. Jackson's Addition to the Village of Sedalia (now Glouster) and also being the Athens County Habitat for Humanity 0.38 parcel (Auditor's Parcel M04-01500051-00) as described in O.R. Vol. 297 Page 1776 and being more fully described as follows:

Commencing at the southwest corner of Outlot No. 2 of said O.D. Jackson's Addition, thence S 67°30'00" E 180.00 feet to an iron pin set, thence N 22°30'00" E 98.13 feet to an iron pin set, said iron pin being the **Point-of-Beginning** for the parcel herein described;

Thence from this Point-of-Beginning N 22°30'00" E 138.62 feet to an iron pin set;

Thence S 67°30'00" E 52.00 feet to an iron pin set;

Thence S 24°37'17" W 54.93 feet to an iron pin set;

Thence S 39°02'00" E 29.50 feet to an iron pin set;

Thence S 22°30'00" W 77.85 feet to an iron pin set;

Thence N 61°20'56" W 76.34 feet to the Point-of-Beginning.

Containing 0.213 acres as surveyed under the direction of Robert C. Canter, P.S. 7226.

Plat of survey is attached herewith and made a part thereof.

Subject to all legal easements and right of ways.

Iron pins set are 5/8"x30" rebar with plastic cap stamped "Canter 7226".

Basis of Bearings: Centerline of Morgan Street being S 67°30'00" E. Bearings are used to denote angular relationships only.

*Robert C. Canter*

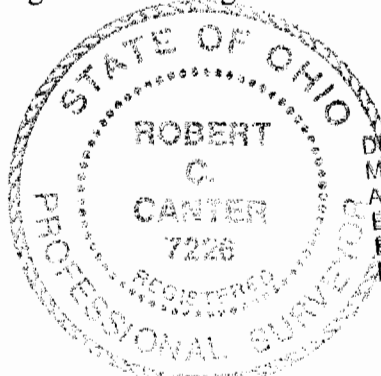

Description checked for  
Mathematical Accuracy  
ATHENS COUNTY  
ENGINEER'S OFFICE  
BY: *[Signature]*  
DATE: *3/16/01*

TRM #15

67

# PLAT of SURVEY for ATHENS COUNTY HABITAT FOR HUMANITY



SITUATE IN SECTION 15, TRIMBLE TWP., COUNTY OF ATHENS, STATE OF OHIO AND VILLAGE OF GLOUSTER, BEING A PART OF OUTLOT NO.2 IN O.D. JACKSON'S ADDITION TO THE VILLAGE OF SEDALIA (NOW GLOUSTER) AND ALSO BEING THE ATHENS COUNTY HABITAT FOR HUMANITY 0.38 PARCEL (AUDITORS PARCEL M04-01500051-00) AS DESCRIBED IN O.R. VOLUME 297 PAGE 1776.

**PARCEL 1**

SITUATE IN SECTION 15, TRIMBLE TWP., COUNTY OF ATHENS, STATE OF OHIO AND VILLAGE OF GLOUSTER, BEING A PART OF OUTLOT NO.2 IN O.D. JACKSON'S ADDITION TO THE VILLAGE OF SEDALIA (NOW GLOUSTER) AND ALSO BEING THE ATHENS COUNTY HABITAT FOR HUMANITY 0.38 PARCEL (AUDITORS PARCEL M04-01500051-00) AS DESCRIBED IN O.R. VOLUME 297 PAGE 1776 AND BEING MORE FULLY DESCRIBED AS FOLLOWS:

COMMENCING AT THE SW CORNER OF OUTLOT NO.2 OF SAID O.D. JACKSON'S ADDITION,

THENCE S 87 30'00"E 180.00 FEET TO AN IRON PIN SET, THENCE N 22 30'00" E 98.13 FEET TO AN IRON PIN SET, SAID IRON PIN BEING THE POINT-OF-BEGINNING FOR THE PARCEL HEREIN DESCRIBED;

THENCE FROM THIS POINT-OF-BEGINNING N 22 30'00" E 138.62 FEET TO AN IRON PIN SET;

THENCE S 87 30'00" E 52.00 FEET TO AN IRON PIN SET;

THENCE S 24 57'17"W 54.93 FEET TO AN IRON PIN SET;

THENCE S 39 02'00" E 28.50 FEET TO AN IRON PIN SET;

THENCE S 22 30'00" W 77.85 FEET TO AN IRON PIN SET;

THENCE N 61 20'56" W 78.34 FEET TO THE POINT-OF-BEGINNING.

CONTAINING 0.213 ACRES AS SURVEYED UNDER THE DIRECTION OF ROBERT C. CANTER, P.S. 7228

SUBJECT TO ALL LEGAL EASEMENTS AND RIGHT OF WAYS.

**PARCEL 1**

WOMEN'S BUILD  
FOUNDATION  
FOR ATHENS COUNTY  
HOUSE

Description checked for  
Mathematical Accuracy  
ATHENS COUNTY  
ENGINEER'S OFFICE  
BY: *[Signature]*  
DATE: 3/16/09

SANDRA KAYE BICKLEY  
O.R. 222-77

BETTIE ROSENTHAL  
O.R. 30-983

### LEGEND

- ⊗ GAS METER
- ⊗ WATER METER
- ⊙ UTILITY POLE
- IRON PIN SET

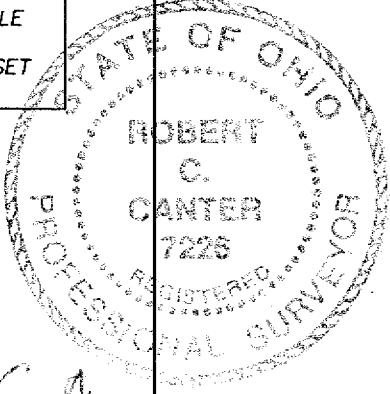

ROBERT C. CANTER, P.S. 7228

DRAWN BY:	MAC	DATE:	07/25/2000
CHECKED BY:	RCC	DRAWING NO.:	20050RECORD
JOB NO.:	20050	SHEET:	1 of 1

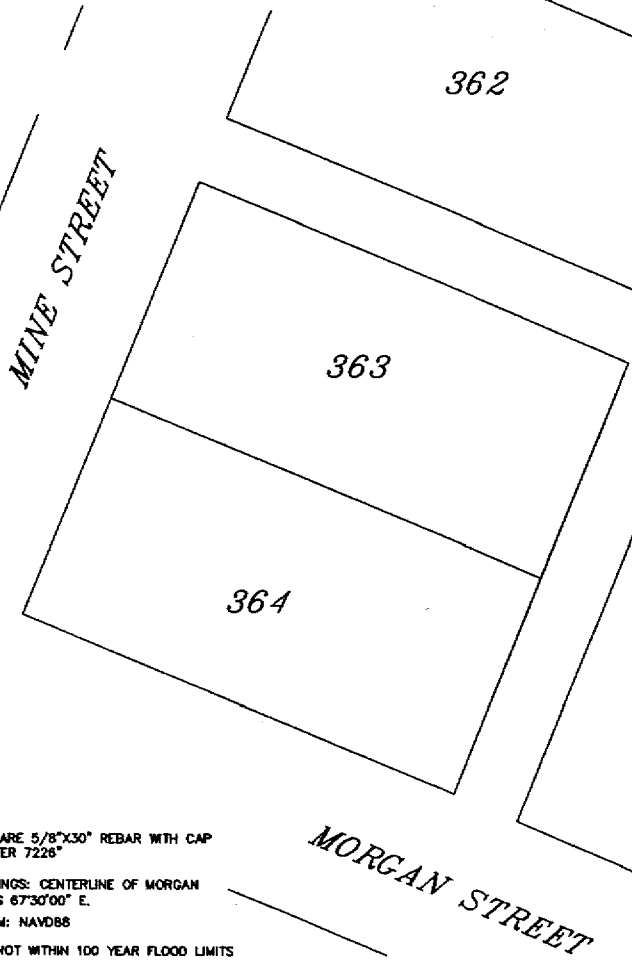

IRON PINS SET ARE 5/8"x30" REBAR WITH CAP STAMPED "CANTER 7228"

BASIS OF BEARINGS: CENTERLINE OF MORGAN STREET BEING S 67'30'00" E.  
VERTICAL DATUM: NAVD88

NOTE: SITE IS NOT WITHIN 100 YEAR FLOOD LIMITS AS DELINEATED BY VILLAGE OF GLOUSTER, OHIO FIA FLOOD HAZARD BOUNDARY MAP NO. H 01, MAY 21, 1978.

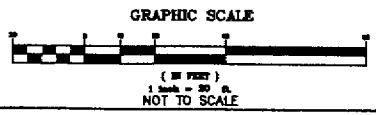

**PARCEL 2**

SITUATE IN SECTION 15, TRIMBLE TWP., COUNTY OF ATHENS, STATE OF OHIO AND VILLAGE OF GLOUSTER, BEING A PART OF OUTLOT NO.2 IN O.D. JACKSON'S ADDITION TO THE VILLAGE OF SEDALIA (NOW GLOUSTER) AND ALSO BEING THE ATHENS COUNTY HABITAT FOR HUMANITY 0.38 PARCEL (AUDITORS PARCEL M04-01500051-00) AS DESCRIBED IN O.R. VOLUME 297 PAGE 1776 AND BEING MORE FULLY DESCRIBED AS FOLLOWS:

COMMENCING AT THE SW CORNER OF OUTLOT NO.2 OF SAID O.D. JACKSON'S ADDITION, THENCE S 87 30'00"E 180.00 FEET TO AN IRON PIN SET, SAID IRON PIN BEING THE POINT-OF-BEGINNING FOR THE PARCEL HEREIN DESCRIBED ;

THENCE FROM THIS POINT-OF-BEGINNING N 22 30'00" E 98.13 FEET TO AN IRON PIN SET;

THENCE S 61 20'56" E 78.34 FEET TO AN IRON PIN SET;

THENCE S 22 30'00" W 88.85 FEET TO A POINT;

THENCE N 67 30'00" W 78.90 FEET TO THE POINT-OF-BEGINNING.

CONTAINING 0.184 ACRES AS SURVEYED UNDER THE DIRECTION OF ROBERT C. CANTER, P.S. 7228.

SUBJECT TO ALL EASEMENTS AND RIGHT OF WAYS.

**PARCEL 2**

Δ BM 1000  
ELEV. 700.45'

7.138 ac. ±  
0.184 acres

368



**PARCEL 2**

Situate in Section 15, Trimble Township, County of Athens, State of Ohio and Village of Glouster. Being a part of Outlot No. 2 in O.D. Jackson's Addition to the Village of Sedalia (now Glouster) and also being the Athens County Habitat for Humanity 0.38 parcel (Auditor's Parcel M04-01500051-00) as described in O.R. Vol. 297 Page 1776 and being more fully described as follows:

Commencing at the southwest corner of Outlot No. 2 of said O.D. Jackson's Addition, thence S 67°30'00" E 180.00 feet to an iron pin set, said iron pin being the **Point-of-Beginning** for the parcel herein described;

Thence from this Point-of-Beginning N 22°30'00" E 98.13 feet to an iron pin set;

Thence S 61°20'56" E 76.34 feet to an iron pin set;

Thence S 22°30'00" W 89.95 feet to a point;

Thence N 67°30'00" W 75.90 feet to the Point-of-Beginning.

Containing 0.164 acres as surveyed under the direction of Robert C. Canter, P.S. 7226.

Plat of survey is attached herewith and made a part thereof.

Subject to all legal easements and right of ways.

Iron pins set are 5/8"x30" rebar with plastic cap stamped "Canter 7226".

Basis of Bearings: Centerline of Morgan Street being S 67°30'00" E. Bearings are used to denote angular relationships only.

*Robert C. Canter*

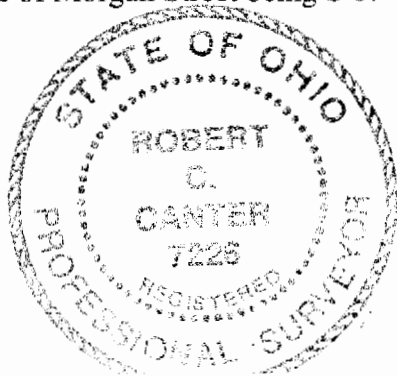

Description checked for  
Mathematical Accuracy  
ATHENS COUNTY  
ENGINEER'S OFFICE  
BY: *R. Canter*  
DATE: 3/16/01

# PLAT of SURVEY

## for ATHENS COUNTY HABITAT FOR HUMANITY



SITUATE IN SECTION 15, TRIMBLE TWP., COUNTY OF ATHENS, STATE OF OHIO AND VILLAGE OF GLOUSTER, BEING A PART OF OUTLOT NO.2 IN O.D. JACKSON'S ADDITION TO THE VILLAGE OF SEDALIA (NOW GLOUSTER) AND ALSO BEING THE ATHENS COUNTY HABITAT FOR HUMANITY 0.38 PARCEL (AUDITORS PARCEL M04-01500051-00) AS DESCRIBED IN O.R. VOLUME 297 PAGE 1776.

PARCEL 1

SITUATE IN SECTION 15, TRIMBLE TWP., COUNTY OF ATHENS, STATE OF OHIO AND VILLAGE OF GLOUSTER, BEING A PART OF OUTLOT NO.2 IN O.D. JACKSON'S ADDITION TO THE VILLAGE OF SEDALIA (NOW GLOUSTER) AND ALSO BEING THE ATHENS COUNTY HABITAT FOR HUMANITY 0.38 PARCEL (AUDITORS PARCEL M04-01500051-00) AS DESCRIBED IN O.R. VOLUME 297 PAGE 1776 AND BEING MORE FULLY DESCRIBED AS FOLLOWS:

COMMENCING AT THE SW CORNER OF OUTLOT NO.2 OF SAID O.D. JACKSON'S ADDITION,  
 THENCE S 87°30'00"E 180.00 FEET TO AN IRON PIN SET, THENCE N 22°30'00" E 98.13 FEET TO AN IRON PIN SET, SAID IRON PIN BEING THE POINT-OF-BEGINNING FOR THE PARCEL HEREIN DESCRIBED;  
 THENCE FROM THIS POINT-OF-BEGINNING N 22°30'00" E 138.82 FEET TO AN IRON PIN SET;  
 THENCE S 87°30'00" E 52.00 FEET TO AN IRON PIN SET;  
 THENCE S 24°37'17"W 54.93 FEET TO AN IRON PIN SET;  
 THENCE S 39°02'00" E 29.50 FEET TO AN IRON PIN SET;  
 THENCE S 22°30'00" W 77.85 FEET TO AN IRON PIN SET;  
 THENCE N 81°20'56" W 78.34 FEET TO THE POINT-OF-BEGINNING.  
 CONTAINING 0.213 ACRES AS SURVEYED UNDER THE DIRECTION OF ROBERT C. CANTER, P.S. 7228  
 SUBJECT TO ALL LEGAL EASEMENTS AND RIGHT OF WAYS.

BETTIE ROSENTHAL  
 O.R. 30-983

PARCEL 1

WOMEN'S BUILD  
 CONULTION  
 BLOCK FOUNDATION  
 FOR ATHENS  
 HOUSE

0.282 ac. fl.  
 0.213 acres

PARCEL 2

SITUATE IN SECTION 15, TRIMBLE TWP., COUNTY OF ATHENS, STATE OF OHIO AND VILLAGE OF GLOUSTER, BEING A PART OF OUTLOT NO.2 IN O.D. JACKSON'S ADDITION TO THE VILLAGE OF SEDALIA (NOW GLOUSTER) AND ALSO BEING THE ATHENS COUNTY HABITAT FOR HUMANITY 0.38 PARCEL (AUDITORS PARCEL M04-01500051-00) AS DESCRIBED IN O.R. VOLUME 297 PAGE 1776 AND BEING MORE FULLY DESCRIBED AS FOLLOWS:

COMMENCING AT THE SW CORNER OF OUTLOT NO.2 OF SAID O.D. JACKSON'S ADDITION, THENCE S 87°30'00"E 180.00 FEET TO AN IRON PIN SET, SAID IRON PIN BEING THE POINT-OF-BEGINNING FOR THE PARCEL HEREIN DESCRIBED ;  
 THENCE FROM THIS POINT-OF-BEGINNING N 22°30'00" E 98.13 FEET TO AN IRON PIN SET;  
 THENCE S 81°20'56" E 78.34 FEET TO AN IRON PIN SET;  
 THENCE S 22°30'00" W 89.95 FEET TO A POINT;  
 THENCE N 87°30'00" W 75.90 FEET TO THE POINT-OF-BEGINNING.  
 CONTAINING 0.184 ACRES AS SURVEYED UNDER THE DIRECTION OF ROBERT C. CANTER, P.S. 7228.  
 SUBJECT TO ALL EASEMENTS AND RIGHT OF WAYS

PARCEL 2

BM 1000  
 ELEV. 700.45'

7.138 ac. fl.  
 0.184 acres

Description checked for  
 Mathematical Accuracy  
 ATHENS COUNTY  
 ENGINEERS OFFICE  
 BY: *[Signature]*  
 DATE: 7/25/2000

SANDRA KAYE BICKLEY  
 O.R. 222-77

### LEGEND

- ⊗ GAS METER
- ⊗ WATER METER
- ⊙ UTILITY POLE
- IRON PIN SET

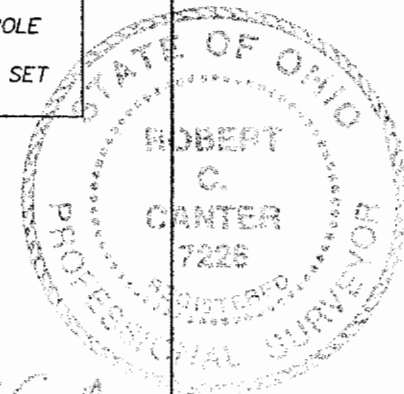

ROBERT C. CANTER, P.S. 7228	
DRAWN BY: MAC	DATE: 07/25/2000
CHECKED BY: RCC	DRAWING NO. 20050RECORD
JOB NO. 20050	SHEET 1 OF 1

MINE STREET

362

363

364

365

366

367

369

368

SW CORNER OUTLOT NO.2

WILLIAMS STREET

MORGAN STREET

IRON PINS SET ARE 5/8"x30" REBAR WITH CAP STAMPED "CANTER 7228"

BASIS OF BEARINGS: CENTERLINE OF MORGAN STREET BEING S 87°30'00" E.  
 VERTICAL DATUM: NAVD88

NOTE: SITE IS NOT WITHIN 100 YEAR FLOOD LIMITS AS DELINEATED BY VILLAGE OF GLOUSTER, OHIO FIA FLOOD HAZARD BOUNDARY MAP NO. H 01, MAY 21, 1976.

GRAPHIC SCALE

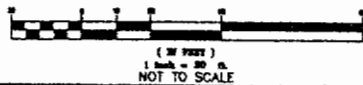

70



SITUATE IN SECTION 15, TRIMBLE TWP., COUNTY OF ATHENS, STATE OF OHIO AND VILLAGE OF GLOUSTER, BEING A PART OF OUTLOT NO.2 IN O.D. JACKSON'S ADDITION TO THE VILLAGE OF SEDALIA (NOW GLOUSTER) AND ALSO BEING THE ATHENS COUNTY HABITAT FOR HUMANITY 0.38 PARCEL (AUDITORS PARCEL M04-01500051-00) AS DESCRIBED IN O.R. VOLUME 297 PAGE 1776.

# PLAT of SURVEY

## for ATHENS COUNTY HABITAT FOR HUMANITY



PARCEL 1

SITUATE IN SECTION 15, TRIMBLE TWP., COUNTY OF ATHENS, STATE OF OHIO AND VILLAGE OF GLOUSTER, BEING A PART OF OUTLOT NO.2 IN O.D. JACKSON'S ADDITION TO THE VILLAGE OF SEDALIA (NOW GLOUSTER) AND ALSO BEING THE ATHENS COUNTY HABITAT FOR HUMANITY 0.38 PARCEL (AUDITORS PARCEL M04-01500051-00) AS DESCRIBED IN O.R. VOLUME 297 PAGE 1776 AND BEING MORE FULLY DESCRIBED AS FOLLOWS:

COMMENCING AT THE SW CORNER OF OUTLOT NO.2 OF SAID O.D. JACKSON'S ADDITION, THENCE S 67°30'00"E 180.00 FEET TO AN IRON PIN SET, THENCE N 22°30'00" E 98.13 FEET TO AN IRON PIN SET, SAID IRON PIN BEING THE POINT-OF-BEGINNING FOR THE PARCEL HEREIN DESCRIBED;

THENCE FROM THIS POINT-OF-BEGINNING N 22°30'00" E 138.62 FEET TO AN IRON PIN SET;

THENCE S 67°30'00" E 52.00 FEET TO AN IRON PIN SET;

THENCE S 24°37'17"W 54.93 FEET TO AN IRON PIN SET;

THENCE S 39°02'00" E 29.50 FEET TO AN IRON PIN SET;

THENCE S 22°30'00" W 77.85 FEET TO AN IRON PIN SET;

THENCE N 61°20'56" W 76.34 FEET TO THE POINT-OF-BEGINNING.

CONTAINING 0.213 ACRES AS SURVEYED UNDER THE DIRECTION OF ROBERT C. CANTER, P.S. 7226

SUBJECT TO ALL LEGAL EASEMENTS AND RIGHT OF WAYS.

PARCEL 1

WOMEN'S BUILD COALITION BLOCK FOUNDATION FOR ACHFH HOUSE

9,282 sq. ft.  
0.213 acres

73

BETTIE ROSENTHAL  
O.R. 30-983

75

SANDRA KAYE BICKLEY  
O.R. 222-77

### LEGEND

- ⊗ GAS METER
- ⊗ WATER METER
- ⊕ UTILITY POLE
- IRON PIN SET

PARCEL 2

△ BM 1000  
ELEV. 700.45'

7,138 sq. ft.  
0.164 acres

PARCEL 2

SITUATE IN SECTION 15, TRIMBLE TWP., COUNTY OF ATHENS, STATE OF OHIO AND VILLAGE OF GLOUSTER, BEING A PART OF OUTLOT NO.2 IN O.D. JACKSON'S ADDITION TO THE VILLAGE OF SEDALIA (NOW GLOUSTER) AND ALSO BEING THE ATHENS COUNTY HABITAT FOR HUMANITY 0.38 PARCEL (AUDITORS PARCEL M04-01500051-00) AS DESCRIBED IN O.R. VOLUME 297 PAGE 1776 AND BEING MORE FULLY DESCRIBED AS FOLLOWS:

COMMENCING AT THE SW CORNER OF OUTLOT NO.2 OF SAID O.D. JACKSON'S ADDITION, THENCE S 67°30'00"E 180.00 FEET TO AN IRON PEN SET, SAID IRON PIN BEING THE POINT-OF-BEGINNING FOR THE PARCEL HEREIN DESCRIBED ;

THENCE FROM THIS POINT-OF-BEGINNING N 22°30'00" E 98.13 FEET TO AN IRON PIN SET;

THENCE S 61°20'56" E 76.34 FEET TO AN IRON PIN SET;

THENCE S 22°30'00" W 89.95 FEET TO A POINT;

THENCE N 67°30'00" W 75.90 FEET TO THE POINT-OF-BEGINNING.

CONTAINING 0.164 ACRES AS SURVEYED UNDER THE DIRECTION OF ROBERT C. CANTER, P.S. 7226.

SUBJECT TO ALL EASEMENTS AND RIGHT OF WAYS

IRON PINS SET ARE 5/8"x30" REBAR WITH CAP STAMPED "CANTER 7226"

BASIS OF BEARINGS: CENTERLINE OF MORGAN STREET BEING S 67°30'00" E.

VERTICAL DATUM: NAVD88

NOTE: SITE IS NOT WITHIN 100 YEAR FLOOD LIMITS AS DELINEATED BY VILLAGE OF GLOUSTER, OHIO FIA FLOOD HAZARD BOUNDARY MAP NO. H 01, MAY 21, 1976.

GRAPHIC SCALE

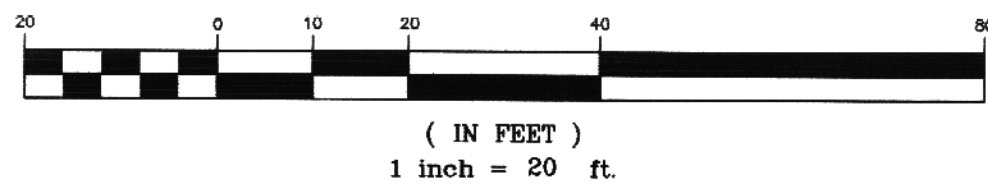

*Robert C. Canter*  
ROBERT C. CANTER, P.S. 7226

DRAWN BY: MAC	DATE: 07/25/2000
CHECKED BY: RCC	DRAWING NO.: 20050RECORD
JOB NO.: 20050	SHEET 1 OF 1