

EXHIBIT A
7.305 Acre Split

Situate in the State of Ohio, Athens County, Trimble Township, Section 35, T11N, R14W, and being part of 962.407 acre parcel recorded in O.R. 488, Page 176 of the Athens County Recorder's office and being more particularly described as follows:

Point of Beginning being the northwest corner of Lot 754 in Smoke Rise 1 recorded in Envelope 75 A & B;

Thence from the **Point of Beginning** South 36 degrees 10 minutes 30 seconds East for a distance of 120.28 feet along the west line of Lot 754 in Smoke Rise 1 recorded in Envelope 75 A & B to the southwest corner of Lot 754 in Smoke Rise 1 recorded in Envelope 75 A & B;

Thence along the existing north right of way line of Sweet Gum Road with a curve to the right 125.12 feet having a radius of 367.19 feet, a delta of 19 degrees 31 minutes 27 seconds and a chord bearing of North 63 degrees 35 minutes 14 seconds East 124.52 feet to the southeast corner of Lot 753;

Thence North 16 degrees 39 minutes 03 seconds West for a distance of 112.46 feet along the east line of Lot 753 in Smoke Rise 1 recorded in Envelope 75 A & B to the northeast corner of Lot 753 in Smoke Rise 1 recorded in Envelope 75 A & B;

Thence North 24 degrees 55 minutes 11 seconds East for a distance of 172.92 feet across the grantor to an iron pin set;

Thence North 86 degrees 38 minutes 08 seconds East for a distance of 609.07 feet across the grantor to an iron pin set;

Thence South 09 degrees 52 minutes 29 seconds East for a distance of 135.19 feet across the grantor to an iron pin set;

Thence North 77 degrees 28 minutes 25 seconds East for a distance of 121.56 feet across the grantor to an iron pin set on the east line of section 35;

Thence South 04 degrees 00 minutes 36 seconds West for a distance of 119.51 feet along the east line of Section 35 to an iron pin set;

Thence South 72 degrees 29 minutes 45 seconds West for a distance of 691.71 feet across the grantor to the southeast corner of Lot 738 in Smoke Rise 1 recorded in Envelope 75 A & B;

Thence North 14 degrees 08 minutes 29 seconds West for a distance of 110.00 feet along the east line of Lot 738 in Smoke Rise 1 recorded in Envelope 75 A & B to a point at the north east corner of Lot 738 in Smoke Rise 1 recorded in Envelope 75 A & B and the existing south right of way line of Sweet Gum Road;

Thence South 75 degrees 51 minutes 31 seconds West for a distance of 70.00 feet along the existing south right of way line of Sweet Gum Road to the northwest corner of Lot 738 in Smoke Rise 1 recorded in Envelope 75 A & B;

Thence South 14 degrees 08 minutes 29 seconds East for a distance of 110.00 feet along the west line of Lot 738 in Smoke Rise 1 recorded in Envelope 75 A & B to the southwest corner of Lot 738 in Smoke Rise 1 recorded in Envelope 75 A & B;

Thence South 55 degrees 33 minutes 15 seconds West for a distance of 252.60 feet across the grantor to an iron pin set;

Thence South 73 degrees 18 minutes 34 seconds West for a distance of 205.10 feet across the grantor to an iron pin set;

Thence North 16 degrees 41 minutes 30 seconds West for a distance of 128.98 feet across the grantor to an iron pin set on the existing south right of way line of Sweet Gum Road;

Thence South 87 degrees 08 minutes 09 seconds East for a distance of 53.18 feet along the existing south right of way line of Sweet Gum Road to a point;

Thence along a curve to the left 61.56 feet having a radius of 241.49 feet, a delta of 14 degrees 36 minutes 17 seconds and a chord bearing of North 85 degrees 33 minutes 42 seconds East 61.39 feet along the existing south right of way line of Sweet Gum Road to an iron pin set;

Thence North 07 degrees 32 minutes 33 seconds West for a distance of 243.61 feet across the grantor to an iron pin set;

Thence North 77 degrees 27 minutes 26 seconds East for a distance of 125.35 feet across the grantor to the **Point of Beginning**.

The above described contains 7.548 acres more or less.

Excepting Lot 747 which contains 0.243 acres more or less.

Containing **7.305** acres after said exceptions and is contained in Auditor's Permanent Parcel Number M020350364600 which presently contains 475.179 acres.

Subject to all legal easements and rights of way including public and private roads as shown on Smoke Rise 1 and 2 as recorded in Athens County Recorder's office in Envelope 75 A & B.

Plat of survey is attached hereto and made a part thereof.

All iron pins set are 3/4"D x 30"L rebar with a cap stamped Canter S 7226.

This description was prepared under the direction and supervision of Robert C. Canter, Registered Surveyor No. 7226 and is based on a field survey made by Canter Surveying/GPS Services, Inc., completed May 2013.

Prior Instrument Reference: O.R. 488, Page 176 of the Athens County Recorder's Office.

Bearings are NAD 83(CORS), Ohio State Plane, South Zone Grid. Based on GPS observations. Reference the east line of Section 35 as being North 04 degrees 00 minutes 36 seconds East.

Robert C. Canter
Robert C. Canter, P.S. 7226

9-6-13
Date



Description Approved
Jill A. Thompson
Athens County Auditor
9/24/13

Description Checked for
Mathematical Accuracy
Athens County
ENGINEER'S OFFICE
BY: Brendan [Signature]
DATE: 9/16/13

SITUATE IN THE STATE OF OHIO, ATHENS COUNTY,
 TRIMBLE TOWNSHIP, SECTION 35, T11N, R14W AND
 BEING PART OF 962.407 ACRE PARCEL
 RECORDED IN O.R. 488, PG. 176

BEARINGS ARE NAD 83(CORS)
 OHIO STATE PLANE, SOUTH ZONE, GRID
 BASED ON GPS OBSERVATIONS.
 REFERENCE THE EAST LINE OF SECTION
 35 AS BEING N04°00'36"E.

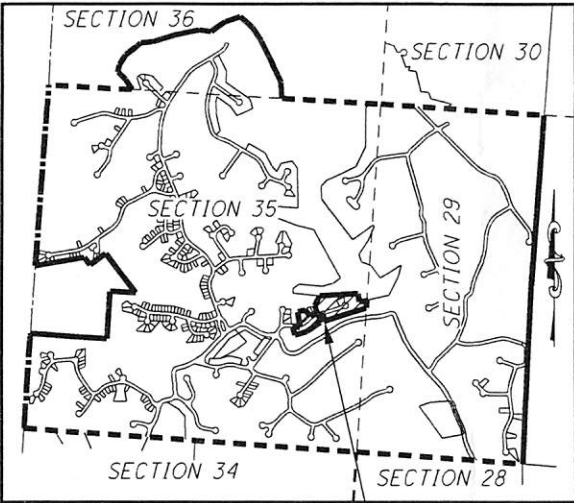

LOCATION MAP
 NOT TO SCALE

7.548 AC.
 - 0.243 AC.
 7.305 AC.

SEMINGSON ENTERPRISES, INC.
 O.488, PG. 176
 M020350364600
 TAXED (475.179 AC.)

SWEET GUM RD. 50' R/W

Description Checked for
 Mathematical Accuracy
 Athens County
 ENGINEER'S OFFICE

BY: *Robert Canter*
 DATE: 9/16/13

SEMINGSON ENTERPRISES, INC.
 O.488, PG. 176
 M020350364600
 TAXED (475.179 AC.)

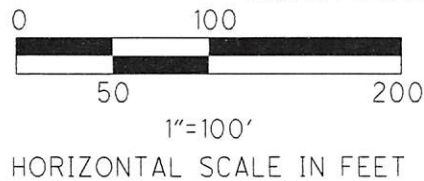

SMOKE RISE 1 ENVELOPE 75 A & A

CURVE	DELTA	RADIUS	LENGTH	CHORD
C1	19°31'27" (RT)	367.19'	125.12'	N63°35'14"E 124.52'
C2	14°36'17" (LT)	241.49'	61.56'	N85°33'42"E 61.39'

LEGEND

- I.P.F. IRON PIN FOUND
- I.P.S. 3/4" x 30" IRON PIN SET WITH A 226 CAP STAMPED CANTER S 7226

SURVEYED MAY 2013 UNDER THE DIRECTION OF
 ROBERT C. CANTER, P.S. 7226. SUBJECT:
 TO ALL LEGAL EASEMENTS, LEASES AND RIGHTS OF WAY.



6801 SR 56
 ATHENS, OHIO 45701
 740-592-5706

13029 SPLIT 4.DGN

ROBERT C. CANTER, PS 7226

9-6-13
 DATE



Robert C. Canter