

DESCRIPTION OF A 3.290 ACRE TRACT
to be continuous and contiguous with M010010034801, Russell (511-973 OR)

Situated in Section 17, T.11, R.14, Trimble Township, Athens County, Ohio and being a part of Parcel M010010034900 as described in Volume 484, Page 1147 of the Official Records of Athens County, Ohio and being more particularly described as follows:

Beginning at a stone found at the Northeast corner of Lot 5 in the Village of McLeish as recorded in envelope 182B of the Athens County Recorder's Office:

Thence along North line of the Village of McLeish,
N 87° 04' 34" W, 696.58 feet to a point in County Road 87 (Antle Orchard Road), passing an iron pin set at 654.25 feet;

Thence along said road the following four courses:

- (1) **N 57° 16' 26" E, 486.30 feet** to a point;
- (2) **N 86° 34' 13" E, 96.47 feet** to a point;
- (3) **S 81° 41' 23" E, 110.25 feet** to a point;
- (4) **S 85° 35' 40" E, 101.99 feet** to a point;

Thence leaving said road and along the West line of Russell (511-973 O.R.),
S 04° 10' 54" W, 281.19 feet to the Point of Beginning, passing an iron pin found at 50.55 feet and **containing 3.290 acres** and to be continuous and contiguous with M010010034801, Russell (511-973 OR)

Subject to all easements and rights of way of record.

Iron pins set are 5/8 inch by 30 inch rebar with I.D. Cap stamped "Branner Surveying 8816"
Bearing: Grid North – N.A.D. 83 – Ohio South Zone

The above description is based on a field survey completed November, 2021 by
Jeb Branner, P.S. 8816

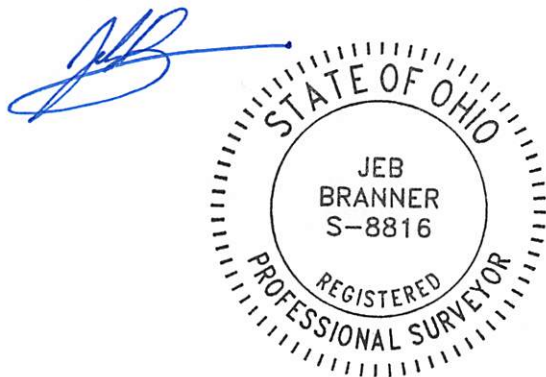

Description Checked for
Mathematical Accuracy
Athens County
ENGINEER'S OFFICE
BY: *Terrance Wilkins*
DATE: 11/22/21

Legal Description Pre-Approval
APPROVED
All transfers are subject to
Athens County Conveyance Standards

NOV 22 2021

Jill Thompson
Athens County Auditor



Grantor
HARVEY
484-1147 OR
M010010034900

CCU COAL &
CONSTRUCTION
LLC
564-1423 OR

COUNTY ROAD 87
ANTLE ORCHARD RD

N 86°34'13" E 96.47'
S 81°41'23" E 110.25'
S 85°35'40" E 101.99'

N 57°16'26" E
486.30'

3.290 Acres

TO BE CONTINUOUS AND CONTIGUOUS WITH
M010010034801, RUSSELL (511-973 OR)

+50.55'

S 04°10'54" W
281.19'

RUSSELL
511-973 OR
M010010034801

P.O.B.
*N:558314.22, E:2082361.55
stone found at the Northeast
corner of Lot 5 in the Village
of McLeish (envelope 182B)

N 87°04'34" W 313.58'

+654.25'

N 87°04'34" W 696.58'

DUNCAN
251-191 OR

COUNTY ROAD 87
ANTLE ORCHARD RD

SPEARS
279-974 OR

ASHTON
214-642 DR

SPEARS
306-805 DR

CCU COAL &
CONSTRUCTION
LLC
564-1423 OR

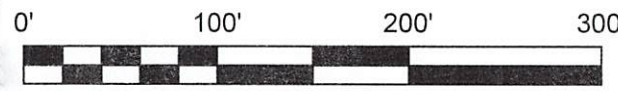

- Scale 1"=100'
- = Iron pin set 5/8" rebar w/ plastic ID cap
- = Iron pin found
- = Stone found

Bearings: N.A.D. 83 - Grid North - Ohio South Zone
Ref. Docs.: Tax Plats, Deeds, Existing Surveys
*Coordinates are to be used GIS purposes only

Description Checked for
Mather: Accuracy
A* nty
F* OFFICE

BY: *Jeb Branner*
DATE: 11/22/21

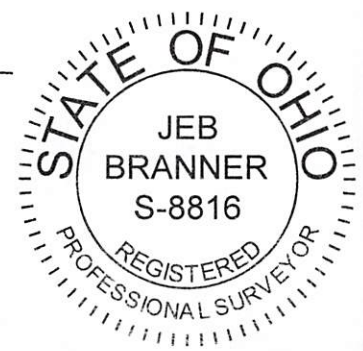

SURVEY OF A 3.290 ACRE TRACT
Situated in Section 17, T.11, R.14,
Trimble Twp., Athens Co., OH
Surveyed November, 2021

By: *Jeb Branner*
Jeb Branner, P.S. 8816
P.O. Box 274
The Plains, OH 45780