

P.O.B. BEARS
 S 06 12 W
 1137.53' FROM
 THE N.E. COR OF
 WEST ONE-HALF OF
 THE NORTH-EAST 1/4
 OF SEC. 3

JEFFERY ALLEN &
 MARY BETH
 COFFMAN
 348-191
 0.48 ACRES

*OK to transfer
 Athens City, to Health Dept
 Dexter Conrad RS
 0.44 AC. 10-796*

"Approved by the Athens
 County Regional Planning
 Commission; No plat
 Required"

Marcia Stanland 10/7/96
 Planning Director Date

*"TO BE HELD CONTIGUOUS
 & contiguous with 0.48 parcel"*

0.07 AC.
 (TRANSFER BETWEEN
 ADJOINING OWNERS)

SURVEY OF TWO TRACTS
 IN SECTION 3, T.11, R.14
 TRIMBLE TOWNSHIP,
 ATHENS CO., OH
 SURVEYED JUNE 1996

JOHN M. BRANNER P.S. 6805
 12500 N. PEACH RIDGE ROAD
 ATHENS, OHIO 592-5778

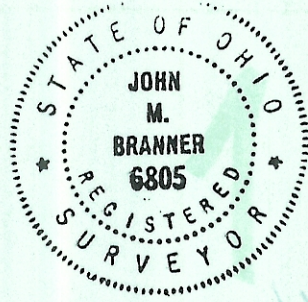

10/4/96