

Description of Parcel No. 4 (9.081 Acres)

The following described parcel is a new split out of a 176.08 acres tract as conveyed to Agri Soils, Ltd. by Official Records Volume 560, Page 874 of the Athens County Recorder's Office.

Situated in the State of Ohio, County of Athens, Township of Trimble, being in Section 7, Range 14 West, Township 11 North, of "The Ohio Company Purchase", and being bounded and described as follows:

Commencing for reference at the southeast corner of Section 7 (Note: Reference bearing on the east line of the southeast quarter of the southeast quarter of Section 7 used as North 04°20'49" East.);

thence, with a the east line of Section 7, North 04°20'49" East a distance of 2,101.66 feet to a 5/8" iron pin set, being **THE TRUE POINT OF BEGINNING** for this description;

thence, from said Point of Beginning leaving the section line and with a new division line through the lands of the grantor, South 86°05'07" West a distance of 760.80 feet to a point in or near the center of County Road No. 27 (Jacksonville Road), passing through two 5/8" iron pins set at distances of plus 630.80 feet and plus 730.80 feet, respectively;

thence, in or near the center of County Road No. 27, the following 6 courses:

1. North 05°00'25" East a distance of 41.76 feet to a point;
2. thence North 09°26'49" East a distance of 81.75 feet to a point;
3. thence North 15°29'06" East a distance of 96.65 feet to a point;
4. thence North 19°22'52" East a distance of 114.88 feet to a point;
5. thence North 19°22'52" East a distance of 169.12 feet to a point;
6. thence North 11°48'32" East a distance of 34.31 feet to a point at the southwest corner of a 5 acres tract as conveyed to James R. and Kathryn Lynn Shafer Trustees by Official Records Volume 511, Page 2098 of the Athens County Recorder's Office;

thence, leaving the road and with said Shafer property, the following 2 courses:

1. South 87°21'26" East a distance of 358.06 feet to a 5/8" iron pin found uncapped, passing through a 5/8" iron pin set at a distance of plus 25.00 feet;
2. thence North 02°38'34" East a distance of 122.50 feet to a 5/8" iron pin set in the south line of a 5 acres tract as conveyed to Rita Downs by Volume 490, Page 2410 of the Athens County Recorder's Office;

thence, with the south line of said Downs 5 acres tract, North 66°52'34" East a distance of 331.48 feet to a 5/8" iron pin set at the southeast corner of said Downs property and in the east line of Section 7;

thence, with the east line of Section 7, South 04°20'49" West a distance of 702.99 feet to **THE POINT OF BEGINNING**;

Description of Parcel No. 4 (9.081 Acres)

containing 9.081 acres, more or less, out of Parcel No. M010010000600.

Subject to all legal right-of-ways, easements, restrictions, reservations, and zoning regulations of record.

Subject to the right-of-way of County Road No. 27 (Jacksonville Road).

Subject to the 100-year Flood Plain restrictions, if applicable.

All iron pins set are 5/8" x 30" rebar capped and labeled "Biedenbach Surveying, LLC. PS 7881".

The bearings in this description are for angle calculations only and are based on the east line of the southeast quarter of the southeast quarter of Section 7 used as a grid bearing of North 04°20'49" East as calculated from a GPS Observation NAD 83 Ohio South Zone.

A plat of the above-described survey has been submitted for file at the County Engineer's Office.

The above description prepared by Gregory A. Biedenbach, Ohio Registered Surveyor No. 7881, based on information obtained from an actual field survey of May 8, 2020. Said survey being subject to any facts that may be disclosed in a full and accurate title search.

Prior Deed: Official Records Volume 560, Page 874.

May 8, 2020 *Gregory A. Biedenbach*

Date Gregory A. Biedenbach
Ohio Registered Surveyor
No. 7881.

Legal Description Pre-Approval
APPROVED
All transfers are subject to
Athens County Conveyance Standards

Cc: Survey File: GB-3339F

JUN 03 2020

Jill Thompson
Athens County Auditor



SURVEY PLAT FOR AGRI SOILS, LTD.

SITUATED IN THE STATE OF OHIO, COUNTY OF ATHENS, TOWNSHIP OF TRIMBLE, BEING IN SECTION 7, RANGE 14 WEST, TOWNSHIP 11 NORTH OF "THE OHIO COMPANY PURCHASE".

THE BEARINGS ON THIS PLAT ARE FOR ANGLE CALCULATIONS ONLY AND ARE BASED ON A GRID BEARING ON THE SOUTH LINE OF THE SOUTHWEST QUARTER OF SECTION 7 CALCULATED FROM A GPS OBSERVATION NAD 83 OHIO SOUTH ZONE.

SUBJECT TO ALL LEGAL RIGHT-OF-WAYS, EASEMENTS, RESTRICTIONS, RESERVATIONS, AND ZONING REGULATIONS OF RECORD. SUBJECT TO 100 YEAR FLOOD PLAIN RESTRICTIONS, IF APPLICABLE. SUBJECT TO ANY FACTS THAT MAY BE DISCLOSED IN A FULL AND ACCURATE TITLE SEARCH.

JOHN A. & TRACY A. DOWNS VOL. 125 PG. 774 50 AC. M010010001800

- PERTINENT DOCUMENTS**
- (1) ALL DEEDS AS SHOWN.
 - (2) COUNTY TAX MAPS.
 - (3) U.S.G.S. QUAD. MAP JACKSONVILLE.
 - (4) SURVEY PLAT BY JOHN M BRANNER.
 - (5) SURVEY PLAT BY WILLIAM J. WHITMAN.
 - (6) SURVEY PLAT BY CHARLES NEWMAN.
 - (7) SURVEY PLAT BY GREGORY WRIGHT.
 - (8) SURVEY PLAT BY WILLIAM WATKINS.

CURRENT DEED:
AGRI SOILS, LTD.
O.R.V. 560 PG. 874
NEW SURVEY ACREAGE
178.165 ACRES TOTAL
P.N. M010010000600

JOHN A. TIPPIE
MAY M. SHUTTLEWORTH
O.R.V. 540 PG. 2383
41.37 AC.
M010010001900

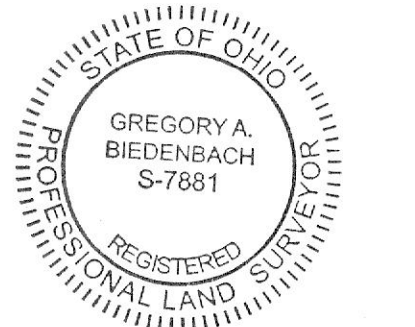

Description Checked for Mathematical Accuracy
Athens County
ENGINEER'S OFFICE
BY: *Gregory A. Biedenbach*
DATE: 9/1/20

SURVEYORS CERTIFICATION:
I HEREBY CERTIFY THAT THIS PLAT IS TRUE AND CORRECT TO THE BEST OF MY KNOWLEDGE AND THAT IT WAS PREPARED FROM AN ACTUAL FIELD SURVEY OF THE PREMISES. TITLE IS NOT GUARANTEED BY THIS SURVEY.

Gregory A. Biedenbach May 8, 2020
GREGORY A. BIENDBACH
OHIO REG. SURVEYOR PS 7881
114 ADAMS AVENUE
WOODSFIELD, OHIO 43793
1.740.472.1262 OFFICE
1.740.472.5298 FAX

NOTE: THIS MAP IS AN ORIGINAL COPY ONLY WITH ORIGINAL SIGNATURE AND SEAL.

- = 5/8" x 30" I.P. Set "Biedenbach Surveying, LLC. PS 7881"
- = survey angle point
- = I.P.F. uncapped (size noted)
- = 1/2" I.P.F. capped "Dunn 6774"
- = 5/8" I.P.F. capped "Hagan"
- ▲ = mag nail found
- ⊙ = 1" pipe found
- = marked stone found
- = white PVC pipe set on line

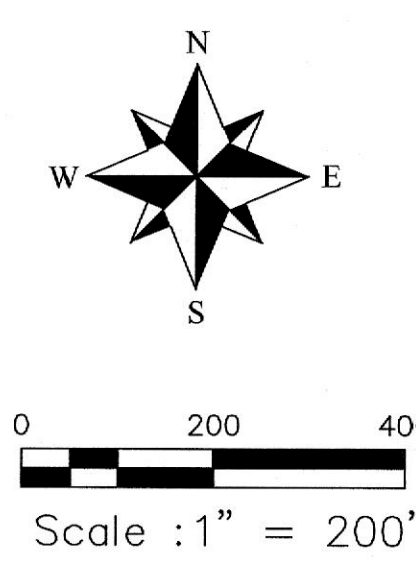

LINE	BEARING	DISTANCE
L1	N 00°00'09" W	460.00'
L2	S 19°22'52" W	114.88'
L3	S 15°29'06" W	96.65'
L4	S 09°26'49" W	81.75'
L5	S 05°00'25" W	151.76'
L6	N 69°45'00" E	335.03'
L7	N 69°45'00" E	167.98'
L8	N 71°54'59" E	316.48'
L9	N 50°51'01" E	84.77'
L10	N 25°22'48" E	68.47'
L11	N 08°24'08" E	193.93'
L12	N 89°55'04" E	242.32'
L13	S 74°18'33" W	52.54'
L14	S 62°26'41" W	247.46'
L15	N 00°43'31" W	30.37'
L16	N 88°03'57" E	24.45'
L17	S 00°55'58" E	450.53'
L18	S 01°47'02" W	169.79'
L19	S 02°31'02" W	71.71'
L20	N 68°12'11" E	357.27'
L21	S 89°55'49" E	216.17'
L22	N 14°20'49" W	158.31'
L23	S 21°41'03" E	23.33'
L24	S 12°12'11" E	46.16'
L25	S 01°17'56" E	68.87'
L26	S 06°15'32" W	117.42'
L27	S 13°52'34" W	10.82'
L28	S 87°21'26" E	358.06'
L29	N 02°38'34" E	122.50'
L30	N 66°52'34" E	331.48'
L31	N 85°43'02" W	355.83'
L32	S 14°21'12" E	64.98'
L33	S 06°19'02" E	65.73'
L34	N 86°28'47" W	175.35'
L35	S 02°55'57" E	124.80'
L36	N 86°28'47" W	224.65'
L37	S 02°55'57" E	100.00'
L38	N 86°28'47" W	300.73'
L39	S 03°31'13" W	300.14'
L40	N 86°29'19" W	402.49'
L41	S 11°48'32" W	34.31'
L42	S 19°22'52" W	169.12'
L43	S 05°29'42" E	62.29'
L44	S 16°12'03" E	70.04'
L45	S 27°20'09" E	75.31'
L46	S 33°55'04" E	172.66'
L47	S 33°55'04" E	200.72'
L48	S 31°34'30" E	73.99'
L49	S 25°36'04" E	97.98'
L50	N 70°49'44" W	48.96'
L51	S 65°53'27" W	34.37'
L52	S 75°19'03" W	251.18'
L53	S 70°44'56" W	59.83'

