

VERNON

VERNON SURVEYING CO. PROFESSIONAL SURVEYORS

January 17, 2001
00-4658

5.3959 Acre Property Description

Situated in the State of Ohio, Athens County, Troy Township, Section 11, Town 5 North Range 11 West, more particularly described as follows:

Beginning at a point in the center of a public road, said point being the southeast corner of the west half of the southwest quarter of Section 11; thence along the center of the public road the following four courses:

S 89-45-39 W a distance of 69.35 feet to a point;
thence N 88-16-22 W a distance of 98.45 feet to a point;
thence N 89-53-35 W a distance of 68.88 feet to a point;
thence N 83-30-33 W a distance of 37.47 feet to a point;

thence along the center of a 15 foot wide private right of way the following thirteen (13) courses:

N 65-42-16 W a distance of 50.10 feet to a point;
thence N 38-44-49 W a distance of 49.06 feet to a point;
thence N 21-29-31 W a distance of 43.44 feet to a point;
thence N 12-30-23 W a distance of 41.41 feet to a point;
thence N 03-42-01 W a distance of 45.59 feet to a point;
thence N 04-45-33 E a distance of 90.99 feet to a point;
thence N 03-52-40 E a distance of 117.71 feet to a point;
thence N 07-21-11 W a distance of 48.34 feet to a point;
thence N 17-00-30 W a distance of 35.18 feet to a point;
thence N 28-33-59 W a distance of 52.82 feet to a point;
thence N 38-41-04 W a distance of 80.98 feet to a point;
thence N 22-24-58 W a distance of 27.51 feet to a point;
thence N 09-43-33 W a distance of 25.64 feet to a point

on the southern right of way line of the old CSX Transportation Railroad (now Hayes Investment Property, Official Record 147, Page 145); thence along the southern right of way line S 85-55-42 E a distance of 470.89 feet to a 5/8-inch capped rebar set, passing a 5/8-inch capped rebar set 7.72 feet distant; thence leaving the said right of way line and along the east line of the west half of the southwest quarter of Section 11 S 00-00-00 E a distance of 608.84 feet, passing a 5/8-inch capped rebar set 593.01 feet distant, to the place of beginning, containing 5.3959 acres, more or less, but subject to all legal highways, easements, and restrictions of record.

VERNON

VERNON SURVEYING CO. PROFESSIONAL SURVEYORS

North is based on an assumed meridian and all bearings shown are used to denote horizontal angles only. All iron pins set are 5/8-inch diameter by 34-inch length rebar with a plastic cap stamped "Vernon OH6282-WV550".

This legal description prepared by Robert G. Vernon, Professional Surveyor No. 6282, based on field surveys in January 2001.

Description checked for
Mathematical Accuracy
ATHENS COUNTY
ENGINEER'S OFFICE
BY: S. Blause
DATE: 2-15-01

Prepared For
 Tim & Chelisa Murphy
 State of Ohio
 Athens County
 Troy Township
 Section 11, T-5N, R-11W

LEGEND

- Center Point Private Road
- Capped Rebar Set
- Property Line
- Edge of Right-of-Way
- Fence Line
- Landhook—Ownership both sides
- POB Point of Beginning for Legal Description

Reference

Official Record 281, Page 169
 Official Record 147, Page 145

NUMBER	DIRECTION	DISTANCE
L1	S 89°45'39" W	69.35'
L2	N 88°16'22" W	98.45'
L3	N 89°53'35" W	68.88'
L4	N 83°30'33" W	37.47'
L5	N 65°42'16" W	50.10'
L6	N 38°44'49" W	49.06'
L7	N 21°29'31" W	43.44'
L8	N 12°30'23" W	41.41'
L9	N 03°42'01" W	45.59'
L10	N 04°45'33" E	90.99'
L11	N 03°52'40" E	117.71'
L12	N 07°21'11" W	48.34'
L13	N 17°00'30" W	35.18'
L14	N 28°33'59" W	52.82'
L15	N 38°41'04" W	80.98'
L16	N 22°24'58" W	27.51'
L17	N 09°43'33" W	25.64'
L18	S 85°55'42" E	470.89'
L19	S 00°00'00" E	608.84'

15 Foot Wide Private Right of Way

5.3959 Acres
 To Be Conveyed

POB
 SE Corner
 West Half
 SW Quarter
 Section 11

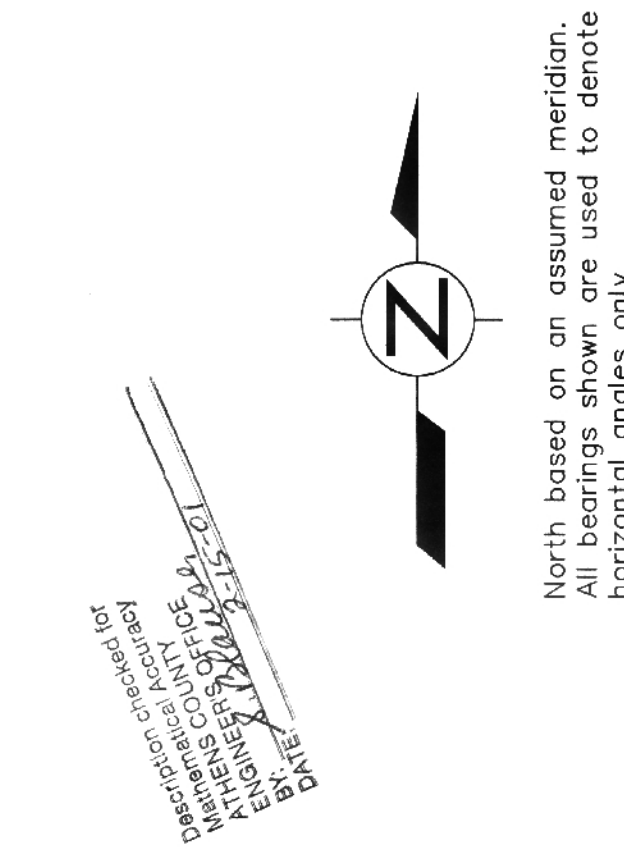

Scale 1" = 50'

Joseph & Vivian
 Godwin
 DB 264, PG 145
 20.0 Acres

William Murphy
 DB 263, PG 91, 93
 55.3 Acres

William L. & Ella M. Murphy
 DB 237, PG 191
 60.0 Acres

Hayes Investment Property
 DB 147, PG 145
 55.3 Acres

Phyllis A. Jones
 DB 281, PG 169
 2.72 Acres

William & Phyllis Dowler
 DB 366, PG 475-477
 5.87 Acres

DRAWN BY: LKM
 DATE: January 16, 2001
 DWG. NO.: _____

APPROVED BY: RGV
 PROJ. NO.: 00-4658
 DWG. FILE: C:\Projects\00-4658\00-4658.dwg

Robert G. Vernon
 Robert G. Vernon
 PS 046282 W4550
 12/13/2001
 Date

POST OFFICE BOX 741
 MARIETTA, OH 45750
 TELEPHONE (740) 373-8397
 FAX (740) 373-8266

VERNON
 VERNON SURVEYING COMPANY PROFESSIONAL SURVEYORS
 SHT. NO. _____