

Phone 740-753-1264
Fax 740-753-1264

Description of a 2.813 Acre Tract

Situated in the Village of Coolville, Sections 21 and 27 Troy Township, Athens County, State of Ohio and being a part of a 4.571 acre tract as described in Volume 349, Page 793 of the Deed Records of Athens County and being more particularly described as follows:

BEGINNING at an iron pin set at Limited Access Right of Way station 1886+28.33, 190.42 feet right (Ath-50-35.45),
THENCE along grantors east line South 5°42'47"West, 497.18 feet to an iron pin set,
THENCE along a new line South 52°45'35"West, 231.03 feet to an iron pin found at the southeast corner of a 0.466 acre tract,
THENCE along the east line of said tract North 37°16'38"West, 80.26 feet to an iron pin found at the southeast corner of a 0.333 acre tract,
THENCE along the east lines of said tract the following 2 courses
North 52°44'07"East, 110.31 feet to an iron pin found,
North 11°42'20"West, 89.58 feet to an iron pin found,
THENCE along the bounds of a 0.147 acre tract the following 3 courses,
North 66°39'27"West, 190.30 feet to an iron pin found,
Thence with a curve to the left having a Radius of 15.00 feet and a Chord bearing of South 9°09'44"West, 21.58 feet to an iron pin found,
South 37°08'32"East, 106.73 feet to an iron pin found,
THENCE South 52°42'38"West, 40.09 feet to an iron pin found on grantors west line,
THENCE along said line North 37°14'06"West, 165.02 feet to a point on the Right of Way line of US RT 50, (an iron pin found bears South 6°09'36"West, 0.91 feet),
THENCE along said line the following 2 courses North 55°59'59"East, 195.96 feet to a point and North 52°02'31"East, 374.68 feet to the point of beginning and containing 2.813 acres of which 1.401 acres is in Section 21 and 1.412 acres is in Section 27.

Bearings are to an assumed meridian and are for angular determination only

Subject to all Easements and Rights of Way of record

Kenneth E. Highland S-7581

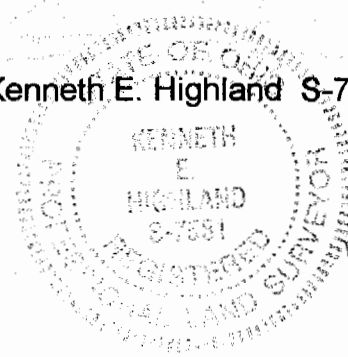

Description checked for
Mathematical Accuracy
ATHENS COUNTY
ENGINEERS OFFICE
S. Blawie
DATE 1-29-01

P.O.B. = Iron Pin Set LA Right
of Way Station 1886+28.33
190.42'Rt (Ath-50-35.45)



US RT 50

2.813 Acres

Iron Pin found
Bears S 6°09'36"W, 0.91'
from corner

Kempton
117-402 OR

Kinney
257-801 OR

Simmon
348-41

Carson
349-793



40' Road

- = Iron Pin Set
- = Iron Pin Found

Description checked for
Mathematical Accuracy
by ENGINEER'S OFFICE
BY: *S. Blausen*
DATE: *1-29-01*

Line	Bearing	Distance
5	N 37°16'38"W	80.26'
6	N 11°42'20"W	89.58'
8	S 52°42'38"W	40.09'

Curve	Delta Angle	Radius	Arc	Tangent	Chord	Chord Bearing
1	92°00'55.5"	15.000	24.090	15.537	21.583	S 9°09'44.0" W

PLAT OF SURVEY OF A 2.813 Ac. TRACT
SURVEYED FOR HERMAN CARSON Jr.

SUBDIVISION -

TOWNSHIP Troy SECTION 21 & 27 TOWN 5 RANGE U

CORPORATION Coolville COUNTY ATHENS STATE OHIO

SCALE 1"= 100' DATE JAN. 2001

Kenneth E. Highland
80 Fayette St.
Nelsonville, Ohio 45764
740-753-1264

Kenneth E. Highland S-7581

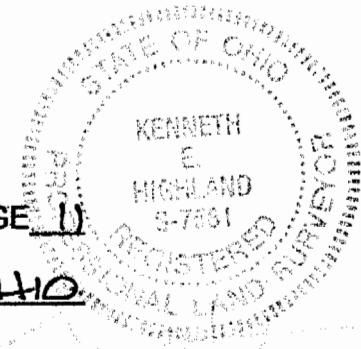

TROY # 21