

Description Checked for  
Mathematical Accuracy  
Athens County  
ENGINEER'S OFFICE  
BY: Bramm H. Miller  
DATE: 5/13/19

Exhibit A  
5.00 Acres

Description of a parcel of land situate Ohio Company Purchase, Town 5, Range 11, Section 13,  
Troy Township, Athens County, Ohio.  
Being the lands deeded to Geneva J. Owens, Official Record Book 542, pages 1224-1226,  
and being more fully described as follows:

Commencing at a point at the southeast corner of said Section 13;  
Thence N89°55'24"W 1233.51 feet (Deed) along the south boundary of Section 13 to a railroad spike  
found in the center of Township Road 161 and being the point of beginning of the parcel herein  
described;

- 1.) Thence N89°55'24"W 144.66 feet along the southern boundary of said Section to a point in the  
center of the Township Road;
- 2.) Thence N13°03'23"E 689.36 feet along a common boundary to D. Smith 153-543,  
passing an iron pin set at 33.54 feet to an iron pin set 6 feet west of a developed spring;
- 3.) Thence S77°46'38"E 411.45 feet along a common boundary to Chutes 327-2201 to a point in the  
center of Township Road 161, passing an iron pin set at 381.45 feet;
- 4.) Thence S23°19'42"W 127.68 feet to a point in the center of Township Road 161;
- 5.) Thence S23°07'04"W 86.53 feet to a point in the center of the Township Road;
- 6.) Thence S20°08'43"W 128.90 feet to a point in the center of the Township Road;
- 7.) Thence S27°16'58"W 56.44 feet to a point in the center of the Township Road;
- 8.) Thence S39°37'18"W 65.25 feet to a point in the center of the Township Road;
- 9.) Thence S49°00'47"W 95.38 feet to a point in the center of the Township Road;
- 10.) Thence S54°21'41"W 178.16 feet to the point of beginning containing a total of 5.00 acres.

Plat of survey is attached herewith and made a part thereof.  
Being subject to all prior easements, rights-of-way, and covenants of record.  
Basis of all bearings was derived from a prior survey being the denoted south boundary of Section 13.  
A True Meridian has NOT been determined.  
Iron Pins set are 30-inch length of number 5 rebar capped NEWMAN PS-8043.  
Survey completed by Charles T. Newman, Registered Professional Surveyor 8043 on May 13, 2019.

  
Charles T. Newman  
Registered Professional Surveyor  
66 Elmwood Place  
Athens, Ohio 45701

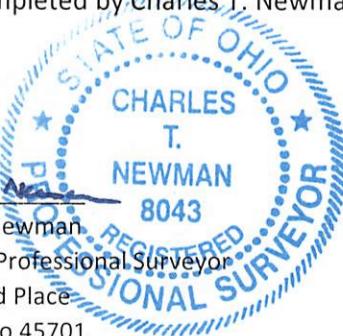

Legal Description Pre-Approval  
APPROVED  
All transfers are subject to  
Athens County Conveyance Standards

MAY 13 2019

Jill Thompson  
Athens County Auditor

C. TIM NEWMAN  
Professional Surveyor

66 Elmwood Place  
Athens, Ohio 45701

740-594-1884  
FAX 740-594-9413

Plat of Survey of 5.00 Acres  
Situating Ohio Company Purchase Town 5, Range 11, Section 13,  
Troy Township, Athens County, Ohio.  
Being the lands deeded to Geneva J. Owens,  
Official Record Book 542, pages 1224-1226.  
Parcel L010010003000

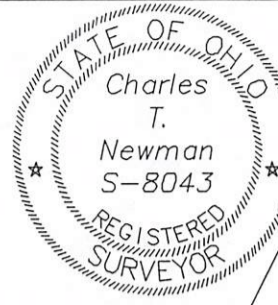

*Charles T. Newman*  
Charles T. Newman  
Surveyed May 13, 2019

Chutes  
327-2201

S 77°46'38" E  
411.45'

IPS 6 Feet West of Spring

+381.45'  
L4

J. Bissell  
501-1924

5.000 ACRES

- ▲ Railroad Spike Found
- Iron Pin Found
- Iron Pin Set
- ▲ Fence Remnant

D. Smith  
153/543

C. Smeeks  
305-2647

Meigs County

N 89°55'24" W  
144.66'

N 89°55'24" W  
1233.51' (Deed)

Southeast  
Corner  
Section 13

LINE TABLE

LINE	BEARING	LENGTH
L4	S23°19'42"W	127.68
L5	S23°07'04"W	86.53
L6	S20°08'43"W	128.90
L7	S27°16'58"W	56.44
L8	S39°37'18"W	65.25
L9	S49°00'47"W	95.38
L10	S54°21'41"W	178.16

Description Checked for  
Mathematical Accuracy  
Athens County  
ENGINEER'S OFFICE  
BY: *Bruce Williams*  
DATE: 5/13/19

GRAPHIC SCALE

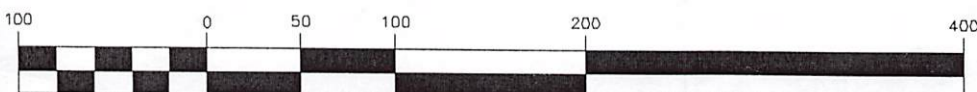

( IN FEET )  
1 inch = 100 ft.