

JAMES A. BROOKS

Situated in the Southeast Quarter of Section 5, Town 11  
Range 5, Waterloo Township, Athens County, Ohio, and be  
particular y described as follows:

Commencing at the Southeast Corner of Section 5;  
thence S 89° 46' W, 866.30 feet to an iron pin on  
the South line of Section 5; thence N 00° 13' W,  
795.72 feet to an iron pin, said pin being the real  
point of beginning for the tract herein described;  
thence continuing along said bearing N 00° 13' 00" W,  
473.98 feet to an iron pin in the center of County  
Road 22, passing an iron pin at 443.98 feet; thence  
N 87° 47' E, 160.79 feet to an iron pin in the center  
of County Road 22; thence leaving said road  
S 00° 59' 30" E, 492.00 feet to an iron pin; thence  
N 85° 59' 30" W, 167.80 feet to the place of  
beginning and containing 1.8183 acres.

Subject to all legal highways and easements on record.

Description prepared by Brian D. McPherson, August, 1977,  
from a survey by Rex E. Maiden, Reg. Surveyor, #006296.

Description checked for  
Mathematical Accuracy  
ATHENS COUNTY  
ENGINEER'S OFFICE

BY: Paul Shields

DATE: Aug 25-77

*Sec. 5*

*Sec 5  
Waterloo*

*26*

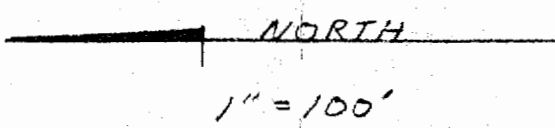

FLOYD R. YOUNG (298-139)

S.E. CORNER SEC. 5  
 ATHENS TWP.

WATERLOO TWP.

S 89° 46' W  
 462.00'

I.P.

JAMES R. & RILDA V. BROOKS  
 (231-571)

11.3400 ACRES

(10.0217 Ac.)

S 39° 46' W  
 404.30'

SEC. 5  
 SEC. 4

I.P.

COUNTY ROAD #22

I.P.(F)

S 00° 59' 30" E  
 492.00'

1.8183 Ac.

N 35° 39' 30" W  
 167.20'

N 00° 13' 00" W  
 473.98'

N 00° 13' W  
 795.72'

BEN E. STALDER  
 (330-605)

N 87° 47' E  
 160.79'

TOWN-11, RANGE-5  
 SECTION 5, WATERLOO  
 TWP., ATHENS CO.  
 (OHIO)

SURVEYED BY:  
 REX E. MAIDEN

SURVEY OF A 1.8183  
 Ac. TRACT FROM A  
 11.3400 Ac. TRACT.  
 AUGUST 1977

SURVEYED FOR:  
 JAMES BROOKS  
 PREPARED BY:  
 BRIAN D. McPHERSON

