



# SOUTHEASTERN LAND SURVEYS

LEONARD F. SWOYER  
REGISTERED PROFESSIONAL LAND SURVEYOR

3428 Pleasant Hill Road  
Athens, Ohio 45701  
740/593-8701

Situated in Fraction 6, Section 15, Town 11, Range 15, Waterloo Township, Athens County, Ohio and described as follows:

Commencing at an iron pin (calculated location) at the northwest corner of said Section 15; thence on an assumed bearing of South 54 degrees 18 minutes 11 seconds East, a distance of 2696.26 feet to an iron pin (calculated location) at the northwest corner of a 38.326 acre tract described in Volume 224 Page 28 of the Athens County Official Deed Records; thence along the north line of said 38.326 acre tract South 86 degrees 12 minutes 54 seconds East, a distance of 1469.75 feet to a found iron pin at the northeast corner of said 38.326 acre tract; thence along the east property line of said 38.326 acre tract South 3 degrees 54 minutes 04 seconds West, a distance of 324.11 feet to a set iron pin, THE TRUE POINT OF BEGINNING; thence continuing South 3 degrees 54 minutes 04 seconds West along said line and the west line of a 95.67 acre tract described in Volume 84 Page 865 of the Athens County Official Deed Records (passing a found iron pin at 633.03 feet) for a total distance of 706.03 feet to a point in the center of State Route 56, the southeast corner of said 38.326 acre tract; thence leaving the west line of said 95.67 acre tract and the east line of said 38.326 acre tract and along the center of said State Route 56 and the south property line of said 38.326 acre tract South 80 degrees 46 minutes 54 seconds West, a distance of 30.80 feet to a point; thence leaving the said State Route 56 and the south line of said 38.326 acre tract North 3 degrees 54 minutes 04 seconds East (passing a set iron pin at 73.00 feet) for a total distance of 381.82 feet to a set iron pin; thence North 86 degrees 05 minutes 56 seconds West, a distance of 594.64 feet to a set iron pin; thence North 3 degrees 54 minutes 04 seconds East, a distance of 331.20 feet to a set iron pin; thence South 86 degrees 05 minutes 56 seconds East, a distance of 624.64 feet to the point of beginning and containing 5.0099 acres, and being a part of a 38.326 acre tract described in Volume 224 Page 28 of the Athens County Official Deed Records.

Note: Unless otherwise noted all set iron pins are 5/8 inch diameter rebar, 30 inches in length and capped with a plastic identification marker inscribed L.F. Swoyer P.L.S. 6765.

30  
WAT #15

PROPERTY

CONSTRUCTION

SUBDIVISIONS

The above description was prepared under the supervision of Leonard F. Swoyer Registered Professional Land Surveyor Number 6765 and based on a field survey performed by Southeastern Land Surveys dated July 15, 1999.

Subject to all easements and right of way of records.

Description checked for  
Mathematical Accuracy  
ATHENS COUNTY  
ENGINEER'S OFFICE  
BY: S. Blausey  
DATE: 7-19-99

31

THE N.W. COR. OF SECTION 15

ETHEL F. ELLIOT  
192-580 227-377 229-5  
238-546 331-337 312-445  
90.93 ACRES

Description checked for  
Mathematical Accuracy  
ATHENS COUNTY  
ENGINEER'S OFFICE  
BY: S. Blawie  
DATE: 7-19-99

REBA WITHERS  
84-865  
95.67 AC.

DENNIS MATHENY  
61-820  
15 ACRES

GREG ANDREWS  
224-28  
38.326 ACRES

5.0099 AC.  
N 03°54'04"E 331.20'  
S 86°05'56"E 624.64'  
N 86°05'56"W 594.64'

(40.0 AC.)

GEORGE & PATTI  
BROOKS  
228-329  
44.07 AC.

STATE RT. 56

ATHENS CO. ROAD 3

N 85°13'44"W 354.26'  
+ 323.47'  
L9 - 3.25 CHAINS SURVEY #598 ATHENS CO. ENGR.

LINE	BEARING	DISTANCE
L 1	S 80°46'54"W	30.80'
L 14	S 80°46'54"W	115.67'
L 2	S 81°08'38"W	182.74'
L 3	S 82°09'52"W	172.05'
L 4	S 85°44'49"W	205.32'
L 5	N 89°46'31"W	215.09'
L 6	N 85°43'34"W	204.07'
L 7	N 80°46'18"W	269.07'
L 8	N 77°34'17"W	84.02'
L 9	S 03°25'16"W	214.50'
L 10	S 03°54'04"W	261.02'
L 11	S 61°48'52"E	128.45'
L 12	S 65°07'51"E	104.30'
L 13	N 89°49'20"E	145.53'

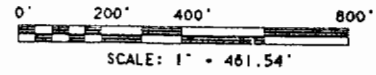
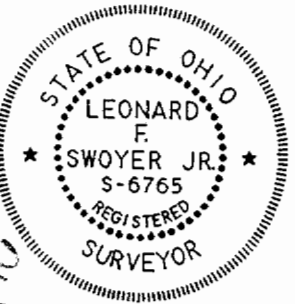

- - I.P. FD.
- - STONE FD.
- ⊙ - I.P. CALC. LOCATION
- - I.P. SET
- ⊗ - R/W MONT. CALC. LOCATION
- - FENCE COR.

PLAT OF SURVEY OF:  
A 5.0099 ACRE TRACT  
SITUATED IN FRACTION 6, SECTION 15, WATERLOO TWP.,  
TOWN 11, RANGE 15, ATHENS COUNTY, OHIO.

PREPARED BY SOUTHEASTERN LAND SURVEYS  
FOR: GREG ANDREWS JULY 15, 1999  
*Leonard F. Swoyer*  
LEONARD F. SWOYER, REG. PROF. LAND SURVEYOR NO. 6765