

HIGHLAND SURVEYING LTD.

80 Fayette St.
Nelsonville, Ohio 45764

Phone 740-753-1264
Fax 740-753-1264

Description of a 139.987 Acre Tract

Situated in Fraction 18, Sections 21 and 22, T-11, R-15, Waterloo Township, Athens County, State of Ohio and being a tract as described in Official records Volume 394, Page 1202 and being more particularly described as follows:

BEGINNING at a stone found at the Northwest corner of the East ½ of Fraction 18,

THENCE along the lines of Dicken (348-2157 OR) and Stobbart (229-189 OR) South 0°09'59"East, 2226.78 feet to an iron pin set, (passing iron pins found at 510.57 feet, 626.81 feet, 678.81 feet, and 1421.52 feet, also an iron pin set at 1556.90 feet and an iron pin found at 2216.24 feet),

THENCE along the lines of Sickles (292-223 OR), Congrove (258-324 OR), Sater (239-770 OR), And Mills (277-180 OR) North 89°38'08"West, 2780.67 feet to an iron pin set, (passing an iron pin found at 66.70 feet , a stone found at 925.41 feet and iron pins set at 1430.67 feet, 1780.67 feet and at 2255.67 feet)

THENCE along the line of Hester (273-1953 OR), North 0°53'33"East, 2201.20 feet to a stone found, (passing iron pins set at 280.19 feet, 976.75 feet and at 1311.88 feet),

THENCE along the line of Holland (219-578 OR), South 89°36'29"East, 966.52 feet to a stone found, (passing iron pins set at 284.11 feet, 608.39 feet, and at 754.44 feet),

THENCE along the line of Hilton,etal, (226-772 OR) North 89°31'24"East, 1773.43 feet to the point of beginning, (passing iron pins found at 379.45 feet, 1163.53 feet and at 1253.58 feet) and containing 139.987 acres.

Bearings are to an assumed meridian and are for angular determination only

Subject to all Easements and Rights of Way of Record

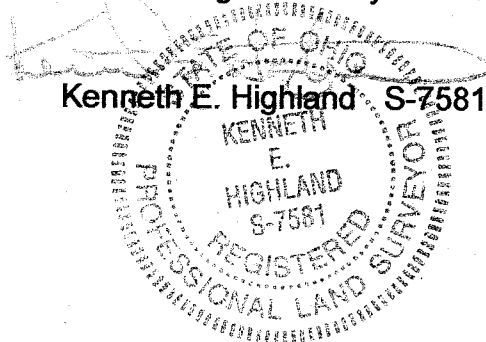

Description Checked for
Mathematical Accuracy
Athens County
ENGINEER'S OFFICE
BY: S. Blaus
DATE: 4-25-08

HOLLAND HILTON ETAL
219-578 OR 226-772 OR

N 89°31'24"E
1773.43'

Fraction 17
Fraction 18

N.W. corner of the East
1/2 of Fraction 18

CONGROVE
394-1202 OR

139.987 Acres

DICKEN
348-2157 OR

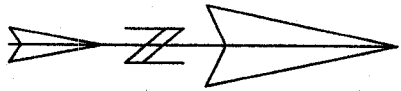

HESTER
273-1953 OR

N 0°53'33"E
2201.20'

- = IRON PIN SET
- = IRON PIN FOUND
- = STONE FOUND
- Ⓐ RADFORD, 254-686 OR
- Ⓑ RADFORD, 336-625 OR
- Ⓒ BURK, 348-2161 OR
- Ⓓ SICKLES, 292-223 OR

- Ⓔ CONGROVE, 258-324 OR
- Ⓕ SATER, 239-770 OR
- Ⓖ MILLS, 277-180 OR
- Ⓗ MILLS, 277-180 OR

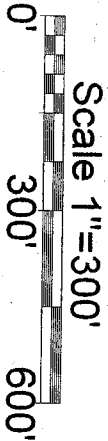

Description Checked for
Mathematical Accuracy
Athens County
BY: *S. H. Quisenberry*
ENGINEER'S OFFICE
DATE: *4-25-08*

STOBART
229-189 OR

PLAT OF SEVEN OF A 139.987 Ac. TRACT
SUBDIVISION FRACTIONS 18

TOWNSHIP WATERLOO SECTION 21, 22 TOWN 11 RANGE 15

CORPORATION COUNTY ATLANTA STATE GA

SCALE 1"= 300' DATE April 2008

Kenneth E. Highland
80 Fayette St.
Nelsonville, Ohio 45764
740-753-1264

