

Description of a 21.432 Acre Tract

Situated in Fraction 18, Sections 21 and 22, T-11, R-15, Waterloo Township, Athens County, State of Ohio and being a part of a tract as described in Volume 306, Page 841 of the Deed Records of Athens County and being more particularly described as follows;

Commencing at an iron pin found at grantors northwest corner that bears South 6°00'04"West, 626.81 feet from a stone found at the Northwest corner of the East ½ of Fraction 18, thence along grantors west line South 5°54'47"West, 45.00 feet to an iron pin set at the POINT OF BEGINNING of this tract,
THENCE South 78°11'37"East, 1332.74 feet to an iron pin set,
THENCE South 83°44'53"East, 87.29 feet to an iron pin set,
THENCE South 41°03'49"West, 149.57 feet to an iron pin set,
THENCE South 62°17'18"West, 164.28 feet to an iron pin set,
THENCE South 21°08'57"West, 329.33 feet to an iron pin set, (passing an iron pin set at 138.77 feet),
THENCE South 89°51'16"East, 930.10 feet to a PK Nail set in the center of SR-56, (passing an iron pin set at 575.00 feet),
THENCE along the center of said road South 18°30'26"East, 208.90 feet to a point,
THENCE North 84°21'37"West, 234.50 feet to a point in the center of CR-6, (passing iron pins found at 73.50 feet and at 219.50 feet),
THENCE along the center of said road North 0°54'04"East, 125.48 feet to an iron pin found,
THENCE leaving said road North 89°51'16"West, 336.12 feet to an iron pin found,
THENCE South 3°43'44"West, 84.98 feet to a point on grantors south line,
THENCE along said line North 83°42'22"West, 1538.68 feet to an iron pin set at grantors southwest corner,
THENCE along grantors west line North 5°54'47"East, 749.71 feet to the point of beginning and containing 21.432 acres.

Bearings are to an assumed meridian and are for angular determination only
Subject to all Easements and Rights of Way of record

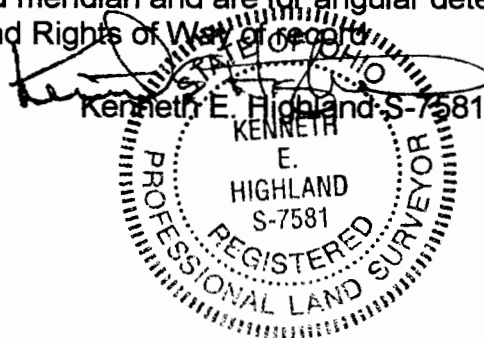

Description checked for
Mathematical Accuracy
ATHENS COUNTY
ENGINEER'S OFFICE
BY: S. Blause
DATE: 5-6-03

Denney
375-1005

Radford
336-625

Dicken
306-841

21.432 AC.

7.894 AC.

- = Iron Pin Set
- = Iron Pin Found
- ▲ = PK Nail Set
- = Stone Found

Line	Bearing	Distance
8	S 5°54'47"W	45.00'
9	S 3°43'44"W	84.96'
10	S 83°44'53"E	87.29'



PLAT OF Survey of Two Tracts

SUBDIVISION FEACTION 18

TOWNSHIP Waterloo SECTION 21 & 22 TOWN 11 RANGE 15

CORPORATION — COUNTY ADAMS STATE OHIO

SCALE 1"= 200' DATE APRIL 2003

Kenneth E. Highland
80 Fayette St.
Nelsonville, Ohio 45764
740-753-1264

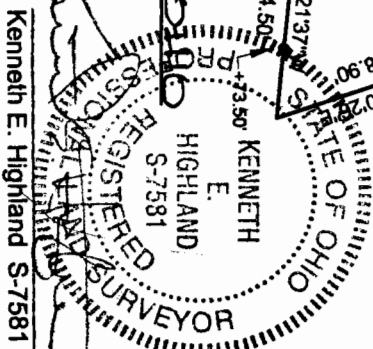

certification requested for
shaded accuracy
HEREIN
DATE 5-6-03
K. E. Highland

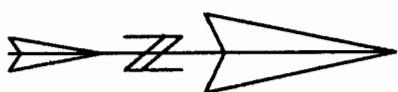

WAT #21