

16.231 Acres  
Contiguous and Continuous Tract

Situate Ohio Company Purchase, Town 11, Range 15, Section 2, Waterloo Township, Athens County, Ohio. Being part of the lands deeded to Larry E. Tong and Brenda Diane Tong, Official Record Book 365, pages 142-144, Parent Parcel N010010008806.

Beginning at an iron pin found of #5 rebar at the northeast corner of the Southwest Quarter of Section 2;

- 1.) Thence N51°05'14"E 1101.70 feet along a common boundary to Lewis 365-145 to an iron pin set;
  - 2.) Thence S53°17'56"E 998.48 feet over the lands of Tong 365-142 to an iron pin set;
  - 3.) Thence S03°43'25"E 209.86 feet over the lands of Tong to an iron pin set;
  - 4.) Thence N86°05'37"W 1675.31 feet along the south boundary of Tong, and being a common boundary to Diles 514-2304, and Lyons 514-2300, (passing iron pins found capped Newman at 513.11 feet, and at 1100.00 feet) to the point of beginning containing a total of 16.231 acres.
- Said tract of 16.231 acres is to remain contiguous and continuous with parcels deeded to Jeffrey L. Lyons and Susan R. McNish of Official Record Book 514, pages 2300-2303.

Plat of Survey is attached herewith and made a part thereof.

Subject to all easements, rights-of-way, covenants and agreements of record.

Iron Pins set are number 5 rebar, 30-inches in length capped NEWMAN PS-8043

Basis of bearings : NAD 83 Ohio South

Survey completed by Charles T. Newman, Licensed Professional Surveyor 8043 on September 2022.

  
Charles T. Newman, PS  
66 Elmwood Place  
Athens, Ohio 45701

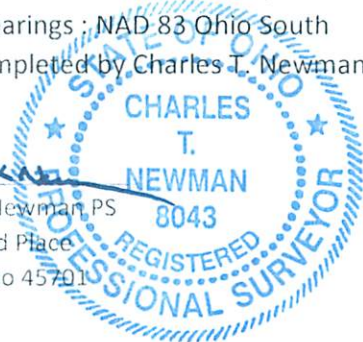

Description Checked for  
Mathematical Accuracy  
Athens County  
ENGINEER'S OFFICE  
BY: *Barbara J. Killeen*  
DATE: 9/14/22

Legal Description Pre-Approval  
APPROVED  
All transfers are subject to  
Athens County Conveyance Standards

SEP 14 2022

Jill Thompson  
Athens County Auditor

C. TIM NEWMAN

Professional Surveyor

66 Elmwood Place  
Athens, Ohio 45701

740-594-1884  
740-591-5269

Plat of Survey of 16.231 Acres  
Situating Ohio Company Purchase, Town 11, Range 15, Section 2,  
Waterloo Township, Athens County, Ohio.  
Being part of the lands deeded to:  
Larry E. Tong and Brenda Diane Tong,  
Official Record Book 365, pages 142-144.  
Parent Parcel N010010008806

Basis of Bearings NAD 83 Ohio South  
Surveys and Deeds used as noted on Plat

- ▲ Iron Pin Found capped Highland
- △ Railroad Spike Found
- Iron Pin Found #5 rebar
- Iron Pin Set capped NEWMAN

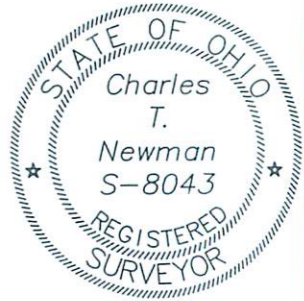

*Charles T. Newman*  
Charles T. Newman  
REVISED 9/12/2022

Description Checked for  
Mathematical Accuracy  
Athens County  
ENGINEER'S OFFICE  
BY: *Deborah J. Miller*  
DATE: 9/14/22

