

DESCRIPTION OF A 30.112 ACRE TRACT

Situated in Section 7, T.11, R.15, Waterloo Township, Athens County, Ohio and being a part of the Jonathan B. Sowash 58.39 acre tract (N010010011800) as described in Volume 369, Page 389 of the Official Records of Athens County, Ohio and being more particularly described as follows:

Commencing at a stone found at the Northeast corner of Section 7, thence N 86° 42' 46" W, 574.69 feet to an iron pin set and also being the **Point of Beginning** for the survey herein described;

Thence along new lines created by this survey,
S 05° 58' 37" W, 1078.56 feet to an iron pin set;
S 28° 36' 13" W, 322.72 feet to an iron pin set;
S 06° 07' 13" E, 441.50 feet to an iron pin set on the North line of Clark/Hawk (81-178 O.R.);
Thence along the North lines of Clark/Hawk;
N 84° 12' 37" W, 217.70 feet to an iron pin set;
S 83° 40' 49" W, 475.86 feet to an iron pin set;
Thence along the East line of Weiss (472-508 O.R.) and Brooks (344-119 O.R.),
N 04° 00' 45" E, 1874.72 feet to a stone found;
Thence along the North line of Section 7 and the South line of Niggemeyer (470-355 O.R.),
S 86° 42' 46" E, 779.40 feet to the point of beginning and **containing 30.112 acres**

Subject to all easements and rights of way of record.

Iron pins set are 5/8 inch by 30 inch long rebar w/ plastic I.D. Cap stamped Branner P.S. 6805

Bearing: Grid North – N.A.D. 83 – Ohio South Zone

The above description is based on a field survey completed May, 2018 by

Jeb Branner, S.I., E.I., under the supervision of:

John M. Branner P.S. 6805

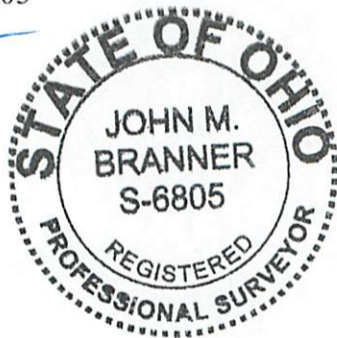

Description Checked for
Mathematical Accuracy
Athens County
ENGINEER'S OFFICE

BY: Perand Wilkin ess
DATE: 5/21/18

Legal Description Pre-Approval
APPROVED
All transfers are subject to
Athens County Conveyance Standards

MAY 29 2018

Jill Thompson
Athens County Auditor

Stephenson
Ronald Sr. & Ruth L.
Trustees
483-637 O.R.

Niggemeyer
Michael
470-355 O.R.

Brooks
Eric M. & Jackie L.
344-119 O.R.

30.112 Acres

30.158 Acres

State
of Ohio
272-426 D.R.

Weiss
Dwight E. Jr.
472-508 O.R.

Clark/Hawk
Karla M./David A.
81-178 O.R.

Sowash
Jonathan B. &
Kassandra L. Watt
5-147 O.R.

Description Checked for
Mathematical Accuracy
Athens County
ENGINEER'S OFFICE
BY: *Jeb Branner*
DATE: 5/21/19

Krubl
John J Et al.
431-2588 O.R.

Eichenberg-Rinaldi
Arianna C.
431-2588 O.R.

S.E. Corner
of the N.E. Quarter
of Section 7

Short Line Table		
LINE	BEARING	DISTANCE
L1	N 84° 12' 37" W	217.70'
L2	N 65° 05' 03" W	141.68'
L3	N 68° 06' 10" W	58.02'
L4	N 54° 05' 39" W	21.84'
L5	N 44° 09' 18" W	93.98'
L6	S 81° 58' 07" W	109.51'
L7	S 58° 56' 37" W	294.94'
L8	N 81° 14' 47" W	47.80'
L9	N 59° 28' 51" E	181.52'
L10	N 53° 49' 37" W	98.80'

Curve Table					
CURVE	ARC LENGTH	RADIUS	DELTA ANGLE	CHORD BEARING	CHORD LENGTH
C1	108.80'	115.00'	54°12'30"	N 70° 54' 44" W	104.79'
C2	56.30'	140.00'	23°02'26"	S 72° 27' 45" W	55.92'

0' 300' 600' 900'



Scale 1"=300'

○ = Iron pin set 5/8" rebar w/ plastic ID cap

● = Iron pin found

□ = Stone Found

Bearings: N.A.D. Grid North - Ohio South Zone

Ref. Docs.: Tax Plats, Deeds, Existing Surveys



Survey of two tracts
Situated in Section 7, T.11, R.15,
Waterloo Twp., Athens Co., OH
Surveyed May, 2018
by Jeb Branner, S.I., E.I.,
under the supervision of:

By: *Jeb Branner*
John M. Branner, P.S. 8605
P.O. Box 274
The Plains, OH 45780