

○ = Iron Pin Set
● = Iron Pin Found

Scale 1"=80'



Description Checked
Mathematical Accuracy
Athens County
ENGINEER'S OFFICE

BY: K. Highland
DATE: 11/21/07

OK TO TRANSFER WITH HEALTH
DEPT. APPROVAL.

Bob Eickenburg 11-26-07

PLAT OF SURVEY OF TWO TRACTS
 SURVEYED FOR MIKE PIDCOCK
 SUBDIVISION RIVER LOTS 658 & 657
 TOWNSHIP YORK SECTION 36 TOWN 12 RANGE 15
 CORPORATION - COUNTY ATHENS STATE OHIO
 SCALE 1"= 80' DATE Nov. 2007

Kenneth E. Highland
80 Fayette St.
Nelsonville, Ohio 45764
740-753-1264

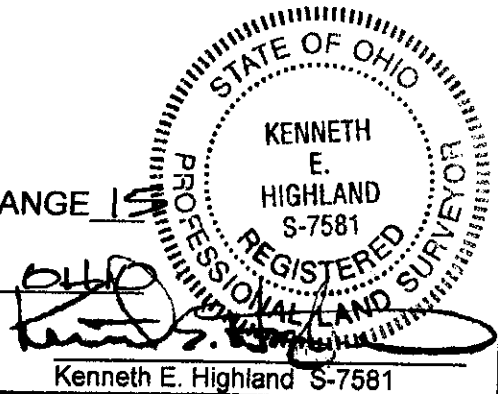

Kenneth E. Highland S-7581