

DESCRIPTION OF PARCEL NO. 1

Situated in the State of Ohio, County of Athens, Township of Trimble, being in the northwest quarter of Section 34, Range 14 West, Township 11 North, of "The Ohio Company Second Purchase", and being bounded and described as follows:

Commencing for Reference at a steel railroad track found in the west line of Athens County at the northwest corner of Section 34 (Note: Reference bearing on the north line of Section 34 used as South 90°00'00" East.);

Thence, with the north line of Section 34, South 90°00'00" East a distance of 1,950.00 feet to a point in the centerline of County Road No. 92 (Hunterdon Road - 60' R/W), being THE TRUE POINT OF BEGINNING for this description;

Thence, from said Point of Beginning and continuing with the north line of Section 34, South 90°00'00" East a distance of 750.08 feet to a 2-1/2" pipe found with a 3-1/4" alum cap "T11N R14W S35 S34 2001 6282" at the northeast corner of the northwest quarter of Section 34, passing through an iron pin set at a distance of plus 30.00 feet;

Thence, with the quarter section line, South 00°03'41" East a distance of 322.00 feet to an iron pin set;

Thence, leaving the quarter section line, North 83°53'35" West a distance of 827.99 feet to a point in the centerline of County Road No. 92 (Hunterdon Road - 60' R/W), passing through two iron pins set at distances of plus 697.99 feet and plus 797.99 feet, respectively;

Thence, with the centerline of County Road No. 92, North 17°18'04" East a distance of 245.00 feet to The Point of Beginning;

Containing 5.056 acres, more or less, being a new split out of Parcel No. 003-00200012-00.

Subject to all legal right-of-ways, easement, restrictions, reservations, and zoning regulations of record.

Subject to the right-of-way of County Road No. 92.

Subject to the 100-Year Flood Plain restrictions, if applicable.

Subject to a 50.00 feet wide easement being reserved unto the grantors (Bruner Land Company, Inc.), their heirs, and or assigns, forever. Said easement being for the purpose of running utilities to other parcels of land on or near County Road No. 92. Said easement runs in a north-south direction across the west end of the above-described property with the west line of said easement being the centerline of County Road No. 92. Containing 0.281 acre, more or less, of easement.

All iron pins set are 5/8" x 30" rebar capped and labeled "Claus 6456".

The bearings in this description are for angle calculations only and are based on the north line of Section 34 used as South 90°00'00" East.

A plat of the above-described survey has been submitted for file at the County Engineer's Office.

The above description prepared by Roger W. Claus, Registered Surveyor No. 6456, based on an actual field survey of November 5, 2003; said survey being subject to any facts that may be disclosed in a full and accurate title search.

Prior deed: Official Records Volume _____, Page _____.

Surveyor: Roger W. Claus

Date: 11-06-03

Description Checked for
Mathematical Accuracy
Athens County
ENGINEER'S OFFICE

BY: S. Blause
DATE: 11-13-03

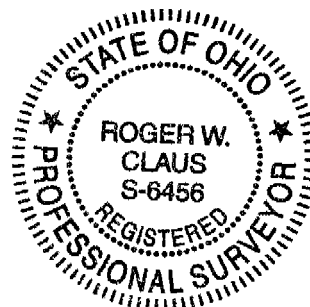

TPM # 34

DESCRIPTION OF PARCEL NO. 2

Situated in the State of Ohio, County of Athens, Township of Trimble, being in the northwest quarter of Section 34, Range 14 West, Township 11 North, of "The Ohio Company Second Purchase", and being bounded and described as follows:

Commencing for Reference at a steel railroad track found in the west line of Athens County at the northwest corner of Section 34 (Note: Reference bearing on the north line of Section 34 used as South 90°00'00" East.);

Thence, with the north line of Section 34, South 90°00'00" East a distance of 2,700.08 feet to a 2-1/2" pipe found with a 3-1/4" alum cap "T11N R14W S35 S34 2001 6282" at the northeast corner of the northwest quarter of Section 34;

Thence, with the quarter section line, South 00°03'41" East a distance of 322.00 feet to an iron pin set, being THE TRUE POINT OF BEGINNING for this description;

Thence, from said Point of Beginning and continuing with the quarter section line, South 00°03'41" East a distance of 268.00 feet to an iron pin set;

Thence, leaving the quarter section line, North 82°30'47" West a distance of 901.61 feet to a point in the centerline of County Road No. 92 (Hunterdon Road - 60' R/W), passing through two iron pins set at distances of plus 771.61 feet and plus 871.61 feet, respectively;

Thence, with the centerline of County Road No. 92, the following two courses:

- (1) North 25°44'38" East a distance of 47.86 feet to a point;
(2) Thence North 14°13'31" East a distance of 201.67 feet to a point;

Thence, leaving the road, South 83°53'35" East a distance of 827.99 feet to The Point of Beginning, passing through two iron pins set at distances of plus 30.00 feet and plus 130.00 feet, respectively;

Containing 5.053 acres, more or less, being a new split out of Parcel No. 003-00200012-00.

Subject to all legal right-of-ways, easement, restrictions, reservations, and zoning regulations of record.

Subject to the right-of-way of County Road No. 92.

Subject to the 100-Year Flood Plain restrictions, if applicable.

Subject to a 50.00 feet wide easement being reserved unto the grantors (Bruner Land Company, Inc.), their heirs, and or assigns, forever. Said easement being for the purpose of running utilities to other parcels of land on or near County Road No. 92. Said easement runs in a north-south direction across the west end of the above-described property with the west line of said easement being the centerline of County Road No. 92. Containing 0.286 acre, more or less, of easement.

All iron pins set are 5/8" x 30" rebar capped and labeled "Claus 6456".

The bearings in this description are for angle calculations only and are based on the north line of Section 34 used as South 90°00'00" East.

A plat of the above-described survey has been submitted for file at the County Engineer's Office.

The above description prepared by Roger W. Claus, Registered Surveyor No. 6456, based on an actual field survey of November 5, 2003; said survey being subject to any facts that may be disclosed in a full and accurate title search.

Prior deed: Official Records Volume _____, Page _____.

Surveyor: [Signature]
Date: Description Checked for Mathematical Accuracy 06-03
Athens County ENGINEER'S OFFICE
BY: [Signature]
DATE: 11-13-03



DESCRIPTION OF PARCEL NO. 3

Situated in the State of Ohio, County of Athens, Township of Trimble, being in the northwest quarter of Section 34, Range 14 West, Township 11 North, of "The Ohio Company Second Purchase", and being bounded and described as follows:

Commencing for Reference at a steel railroad track found in the west line of Athens County at the northwest corner of Section 34 (Note: Reference bearing on the north line of Section 34 used as South 90°00'00" East.);

Thence, with the north line of Section 34, South 90°00'00" East a distance of 2,700.08 feet to a 2-1/2" pipe found with a 3-1/4" alum cap "T11N R14W S35 S34 2001 6282" at the northeast corner of the northwest quarter of Section 34;

Thence, with the quarter section line, South 00°03'41" East a distance of 590.00 feet to an iron pin set, being **THE TRUE POINT OF BEGINNING** for this description;

Thence, from said Point of Beginning and continuing with the quarter section line, South 00°03'41" East a distance of 591.00 feet to an iron pin set;

Thence, leaving the quarter section line, North 59°09'53" West a distance of 1,138.88 feet to a point in the centerline of County Road No. 92 (Hunterdon Road - 60' R/W), passing through two iron pins set at distances of plus 1,008.88 feet and plus 1,108.88 feet, respectively;

Thence, with the centerline of County Road No. 92, North 33°44'52" East a distance of 150.00 feet to a point;

Thence, leaving the road, South 82°30'47" East a distance of 901.61 feet to The Point of Beginning, passing through two iron pins set at distances of plus 30.00 feet and plus 130.00 feet, respectively;

Containing 8.022 acres, more or less, being a new split out of Parcel No. 003-00200012-00.

Subject to all legal right-of-ways, easement, restrictions, reservations, and zoning regulations of record.

Subject to the right-of-way of County Road No. 92.

Subject to the 100-Year Flood Plain restrictions, if applicable.

Subject to a 50.00 feet wide easement being reserved unto the grantors (Bruner Land Company, Inc.), their heirs, and or assigns, forever. Said easement being for the purpose of running utilities to other parcels of land on or near County Road No. 92. Said easement runs in a north-south direction across the west end of the above-described property with the west line of said easement being the centerline of County Road No. 92. Containing 0.173 acre, more or less, of easement.

All iron pins set are 5/8" x 30" rebar capped and labeled "Claus 6456".

The bearings in this description are for angle calculations only and are based on the north line of Section 34 used as South 90°00'00" East.

A plat of the above-described survey has been submitted for file at the County Engineer's Office.

The above description prepared by Roger W. Claus, Registered Surveyor No. 6456, based on an actual field survey of November 5, 2003; said survey being subject to any facts that may be disclosed in a full and accurate title search.

Prior deed: Official Records Volume _____, Page _____.

Surveyor: Roger W. Claus
Date: 11-06-03

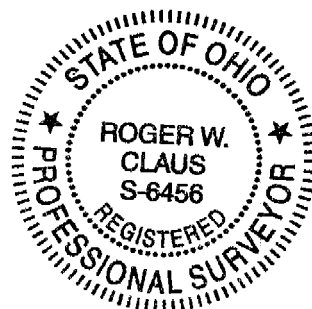

Description Checked for
Mathematical Accuracy
Athens County
ENGINEER'S OFFICE
BY: S. Blaine
DATE: 11-13-03

DESCRIPTION OF PARCEL NO. 4

Situated in the State of Ohio, County of Athens, Township of Trimble, being in the northwest quarter of Section 34, Range 14 West, Township 11 North, of "The Ohio Company Second Purchase", and being bounded and described as follows:

Commencing for Reference at a steel railroad track found in the west line of Athens County at the northwest corner of Section 34 (Note: Reference bearing on the north line of Section 34 used as South 90°00'00" East.);

Thence, with the north line of Section 34, South 90°00'00" East a distance of 2,700.08 feet to a 2-1/2" pipe found with a 3-1/4" alum cap "T11N R14W S35 S34 2001 6282" at the northeast corner of the northwest quarter of Section 34;

Thence, with the quarter section line, South 00°03'41" East a distance of 1,181.00 feet to an iron pin set, being **THE TRUE POINT OF BEGINNING** for this description;

Thence, from said Point of Beginning and continuing with the quarter section line, South 00°03'41" East a distance of 320.00 feet to an iron pin set;

Thence, leaving the quarter section line, North 90°00'00" West a distance of 363.00 feet to an iron pin set;

Thence North 41°56'17" West a distance of 1,050.58 feet to a point in the centerline of County Road No. 92 (Hunterdon Road – 60' R/W), passing through three iron pins set at distances of plus 266.31 feet, plus 920.58 feet, and plus 1,020.58 feet, respectively;

Thence, with the centerline of County Road No. 92, the following two courses:

(1) North 41°54'38" East a distance of 30.51 feet to a point;

(2) Thence North 33°44'52" East a distance of 119.74 feet to a point;

Thence, leaving the road, South 59°09'53" East a distance of 1,138.88 feet to The Point of Beginning, passing through two iron pins set at distances of plus 30.00 feet and plus 130.00 feet, respectively;

Containing 9.114 acres, more or less, being a new split out of Parcel No. 003-00200012-00.

Subject to all legal right-of-ways, easement, restrictions, reservations, and zoning regulations of record.

Subject to the right-of-way of County Road No. 92.

Subject to the 100-Year Flood Plain restrictions, if applicable.

Subject to a 50.00 feet wide easement being reserved unto the grantors (Bruner Land Company, Inc.), their heirs, and or assigns, forever. Said easement being for the purpose of running utilities to other parcels of land on or near County Road No. 92. Said easement runs in a north-south direction across the west end of the above-described property with the west line of said easement being the centerline of County Road No. 92. Containing 0.173 acre, more or less, of easement.

All iron pins set are 5/8" x 30" rebar capped and labeled "Claus 6456".

The bearings in this description are for angle calculations only and are based on the north line of Section 34 used as South 90°00'00" East.

A plat of the above-described survey has been submitted for file at the County Engineer's Office.

The above description prepared by Roger W. Claus, Registered Surveyor No. 6456, based on an actual field survey of November 5, 2003; said survey being subject to any facts that may be disclosed in a full and accurate title search.

Prior deed: Official Records Volume _____, Page _____.

Surveyor: Roger W Claus
Date: 11-06-03

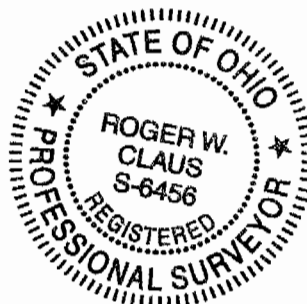

Description Checked for
Mathematical Accuracy
Athens County
ENGINEER'S OFFICE
BY: S. Blause
DATE: 11-13-03

DESCRIPTION OF PARCEL NO. 5

Situated in the State of Ohio, County of Athens, Township of Trimble, being in the northwest quarter of Section 34, Range 14 West, Township 11 North, of "The Ohio Company Second Purchase", and being bounded and described as follows:

Commencing for Reference at a steel railroad track found in the west line of Athens County at the northwest corner of Section 34 (Note: Reference bearing on the north line of Section 34 used as South 90°00'00" East.);

Thence, with the north line of Section 34, South 90°00'00" East a distance of 959.00 feet to an iron pin set;

Thence, leaving the section line, South 25°15'03" East a distance of 898.01 feet to a point in the centerline of County Road No. 92 (Hunterdon Road – 60' R/W), passing through three iron pins set at distances of plus 280.63 feet, plus 768.01 feet, and plus 868.01 feet, respectively;

Thence, with the centerline of County Road No. 92, North 89°18'03" East a distance of 67.82 feet to a point, being **THE TRUE POINT OF BEGINNING** for this description;

Thence, from said Point of Beginning and continuing with the centerline of County Road No. 92, the following four courses:

- (1) North 85°54'39" East a distance of 55.21 feet to a point;
- (2) Thence North 75°15'11" East a distance of 59.52 feet to a point;
- (3) Thence North 63°03'45" East a distance of 65.38 feet to a point;
- (4) Thence North 52°15'30" East a distance of 70.51 feet to a point;

Thence, leaving the road, South 41°56'17" East a distance of 784.27 feet to an iron pin set, passing through two iron pins set at distances of plus 30.00 feet and plus 130.00 feet, respectively;

Thence North 85°55'47" West a distance of 622.37 feet to an iron pin set;

Thence North 16°12'24" West a distance of 465.86 feet to The Point of Beginning, passing through two iron pins set at distances of plus 335.86 feet and plus 435.86 feet, respectively;

Containing 5.106 acres, more or less, being a new split out of Parcel No. 003-00200012-00.

Subject to all legal right-of-ways, easement, restrictions, reservations, and zoning regulations of record.

Subject to the right-of-way of County Road No. 92.

Subject to the 100-Year Flood Plain restrictions, if applicable.

Subject to a 50.00 feet wide easement being reserved unto the grantors (Bruner Land Company, Inc.), their heirs, and or assigns, forever. Said easement being for the purpose of running utilities to other parcels of land on or near County Road No. 92. Said easement runs in an east-west direction across the north end of the above-described property with the north line of said easement being the centerline of County Road No. 92. Containing 0.288 acre, more or less, of easement.

All iron pins set are 5/8" x 30" rebar capped and labeled "Claus 6456".

Page 2 of 2

Description of Parcel No. 5

The bearings in this description are for angle calculations only and are based on the north line of Section 34 used as South 90°00'00" East.

A plat of the above-described survey has been submitted for file at the County Engineer's Office.

The above description prepared by Roger W. Claus, Registered Surveyor No. 6456, based on an actual field survey of November 5, 2003; said survey being subject to any facts that may be disclosed in a full and accurate title search.

Prior deed: Official Records Volume _____, Page _____.

Surveyor: *Roger W Claus*
Date: 11-06-03

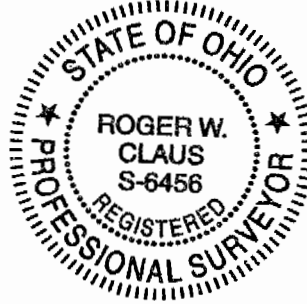

DESCRIPTION OF PARCEL NO. 6

Situated in the State of Ohio, County of Athens, Township of Trimble, being in the northwest quarter of Section 34, Range 14 West, Township 11 North, of "The Ohio Company Second Purchase", and being bounded and described as follows:

Commencing for Reference at a steel railroad track found in the west line of Athens County at the northwest corner of Section 34 (Note: Reference bearing on the north line of Section 34 used as South $90^{\circ}00'00''$ East.);

Thence, with the north line of Section 34, South $90^{\circ}00'00''$ East a distance of 959.00 feet to an iron pin set;

Thence, leaving the section line, South $25^{\circ}15'03''$ East a distance of 898.01 feet to a point in the centerline of County Road No. 92 (Hunterdon Road – 60' R/W), passing through three iron pins set at distances of plus 280.63 feet, plus 768.01 feet, and plus 868.01 feet, respectively, said point in the road being **THE TRUE POINT OF BEGINNING** for this description;

Thence, from said Point of Beginning and running with the centerline of County Road No. 92, North $89^{\circ}18'03''$ East a distance of 67.82 feet to a point;

Thence, leaving the road, South $16^{\circ}12'24''$ East a distance of 465.86 feet to an iron pin set, passing through two iron pins set at distances of plus 30.00 feet and plus 130.00 feet, respectively;

Thence North $85^{\circ}55'47''$ West a distance of 740.00 feet to point in the centerline of County Road No. 92 (Hunterdon Road – 60' R/W), passing through two iron pins set at distances of plus 610.00 feet and plus 710.00 feet, respectively;

Thence, with the centerline of County Road No. 92, the following ten courses:

- (1) North $05^{\circ}10'09''$ East a distance of 41.68 feet to point;
- (2) Thence North $09^{\circ}34'15''$ East a distance of 95.97 feet to point;
- (3) Thence North $18^{\circ}13'36''$ East a distance of 94.38 feet to point;
- (4) Thence North $25^{\circ}11'23''$ East a distance of 67.28 feet to point;
- (5) Thence North $38^{\circ}35'28''$ East a distance of 105.45 feet to point;
- (6) Thence North $56^{\circ}09'35''$ East a distance of 54.14 feet to point;
- (7) Thence North $72^{\circ}03'08''$ East a distance of 54.14 feet to point;
- (8) Thence North $88^{\circ}11'20''$ East a distance of 60.93 feet to point;
- (9) Thence South $82^{\circ}14'40''$ East a distance of 90.30 feet to point;
- (10) Thence South $85^{\circ}32'52''$ East a distance of 150.26 feet to The Point of Beginning;

Containing 6.073 acres, more or less, being a new split out of Parcel No. 003-00200012-00.

Subject to all legal right-of-ways, easement, restrictions, reservations, and zoning regulations of record.

Subject to the right-of-way of County Road No. 92.

Subject to the 100-Year Flood Plain restrictions, if applicable.

Subject to a 50.00 feet wide easement being reserved unto the grantors (Bruner Land Company, Inc.), their heirs, and or assigns, forever. Said easement being for the purpose of running utilities to other parcels of land on or near County Road No. 92. Said easement runs in an east-west direction across the north end of the above-described property with the north line of said easement being the centerline of County Road No. 92. Containing 0.288 acre, more or less, of easement.

All iron pins set are 5/8" x 30" rebar capped and labeled "Claus 6456".

The bearings in this description are for angle calculations only and are based on the north line of Section 34 used as South 90°00'00" East.

A plat of the above-described survey has been submitted for file at the County Engineer's Office.

The above description prepared by Roger W. Claus, Registered Surveyor No. 6456, based on an actual field survey of November 5, 2003; said survey being subject to any facts that may be disclosed in a full and accurate title search.

Prior deed: Official Records Volume _____, Page _____.

Surveyor: *Roger W. Claus*

Date: 11-12-03

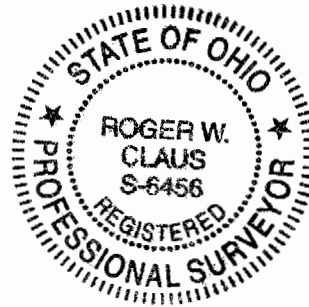

DESCRIPTION OF PARCEL NO. 7

Situated in the State of Ohio, County of Athens, Township of Trimble, being in the northwest quarter of Section 34, Range 14 West, Township 11 North, of "The Ohio Company Second Purchase", and being bounded and described as follows:

Commencing for Reference at a steel railroad track found in the west line of Athens County at the northwest corner of Section 34 (Note: Reference bearing on the north line of Section 34 used as South 90°00'00" East.);

Thence, with the north line of Section 34, South 90°00'00" East a distance of 2,700.08 feet to a 2-1/2" pipe found with a 3-1/4" alum cap "T11N R14W S35 S34 2001 6282" at the northeast corner of the northwest quarter of Section 34;

Thence, with the quarter section line, South 00°03'41" East a distance of 1,501.00 feet to an iron pin set;

Thence, leaving the quarter section line, North 90°00'00" West a distance of 363.00 feet to an iron pin set, being **THE TRUE POINT OF BEGINNING** for this description;

Thence, from said Point of Beginning and continuing, North 90°00'00" West a distance of 1,592.51 feet to a point in the centerline of County Road No. 92 (Hunterdon Road - 60' R/W), passing through three iron pins set at distances of plus 762.51 feet, plus 1,462.51 feet, and plus 1,562.51 feet, respectively;

Thence, with the centerline of County Road No. 92, the following three courses:

- (1) North 17°31'25" East a distance of 83.82 feet to a point;
- (2) Thence North 13°50'03" East a distance of 72.20 feet to a point;
- (3) Thence North 05°10'09" East a distance of 145.36 feet to a point;

Thence, leaving the road, South 85°55'47" East a distance of 1,362.37 feet to an iron pin set, passing through three iron pins set at distances of plus 30.00 feet, plus 130.00 feet, and plus 740.00 feet, respectively;

Thence South 41°56'17" East a distance of 266.31 feet to The Point of Beginning,

Containing 8.229 acres, more or less, being a new split out of Parcel No. 003-00200012-00.

Subject to all legal right-of-ways, easement, restrictions, reservations, and zoning regulations of record.

Subject to the right-of-way of County Road No. 92.

Subject to the 100-Year Flood Plain restrictions, if applicable.

Subject to a 50.00 feet wide easement being reserved unto the grantors (Bruner Land Company, Inc.), their heirs, and or assigns, forever. Said easement being for the purpose of running utilities to other parcels of land on or near County Road No. 92. Said easement runs in a north-south direction across the west end of the above-described property with the west line of said easement being the centerline of County Road No. 92. Containing 0.346 acre, more or less, of easement.

All iron pins set are 5/8" x 30" rebar capped and labeled "Claus 6456".

The bearings in this description are for angle calculations only and are based on the north line of Section 34 used as South 90°00'00" East.

A plat of the above-described survey has been submitted for file at the County Engineer's Office.

The above description prepared by Roger W. Claus, Registered Surveyor No. 6456, based on an actual field survey of November 5, 2003; said survey being subject to any facts that may be disclosed in a full and accurate title search.

Prior deed: Official Records Volume _____, Page _____.

Surveyor: *Roger W Claus*

Date: 11-06-03



DESCRIPTION OF PARCEL NO. 8

Situated in the State of Ohio, County of Athens, Township of Trimble, being in the northwest quarter of Section 34, Range 14 West, Township 11 North, of "The Ohio Company Second Purchase", and being bounded and described as follows:

Commencing for Reference at a steel railroad track found in the west line of Athens County at the northwest corner of Section 34 (Note: Reference bearing on the north line of Section 34 used as South $90^{\circ}00'00''$ East.);

Thence, with the north line of Section 34, South $90^{\circ}00'00''$ East a distance of 2,700.08 feet to a 2-1/2" pipe found with a 3-1/4" alum cap "T11N R14W S35 S34 2001 6282" at the northeast corner of the northwest quarter of Section 34;

Thence, with the quarter section line, South $00^{\circ}03'41''$ East a distance of 1,501.00 feet to an iron pin set, being **THE TRUE POINT OF BEGINNING** for this description;

Thence, from said Point of Beginning and continuing with the quarter section line, South $00^{\circ}03'41''$ East a distance of 325.22 feet to a 3/4" rebar found with a 3-1/4" alum cap "U.S. Dept. of Agriculture Forest Service – unlawful to disturb – cadastral survey – T11 R14 C5 S34" at the northeast corner of a 137.91 acres tract as conveyed to The United States of America by Deed Volume 180, Page 508 of the Athens County Recorder's Office;

Thence, with the north line of said U.S.A. property, South $76^{\circ}31'01''$ West a distance of 1,247.46 feet to a 3/4" rebar found with a 3-1/4" alum cap "U.S. Dept. of Agriculture Forest Service – unlawful to disturb – cadastral survey – T11 R14 C4 S34" at the northeast corner of a 22.81 acres residue parcel of an original 25.31 acres tract as conveyed to William Q. Quinn and Agnes Joan Quinn by Deed Volume 373, Page 327 of the Athens County Recorder's Office, passing through four wood forest service posts found at distances of plus 199.56 feet, plus 387.63 feet, plus 746.29 feet, and plus 980.59 feet, respectively;

Thence, with the north line of said Quinn property, South $76^{\circ}31'01''$ West a distance of 612.24 feet to a point in the centerline of County Road No. 92 (Hunterdon Road – 60' R/W), passing through an iron pin set at a distance of plus 572.24 feet;

Thence, with the centerline of County Road No. 92, the following thirteen courses:

- (1) North $45^{\circ}28'48''$ East a distance of 33.18 feet to a point;
- (2) Thence North $29^{\circ}31'51''$ East a distance of 37.29 feet to a point;
- (3) Thence North $07^{\circ}14'09''$ East a distance of 59.90 feet to a point;
- (4) Thence North $15^{\circ}12'47''$ West a distance of 56.88 feet to a point;
- (5) Thence North $27^{\circ}59'13''$ West a distance of 71.43 feet to a point;
- (6) Thence North $39^{\circ}34'14''$ West a distance of 85.26 feet to a point;
- (7) Thence North $45^{\circ}33'14''$ West a distance of 111.08 feet to a point;
- (8) Thence North $38^{\circ}57'22''$ West a distance of 59.44 feet to a point;
- (9) Thence North $19^{\circ}47'14''$ West a distance of 44.26 feet to a point;
- (10) Thence North $06^{\circ}01'00''$ West a distance of 78.14 feet to a point;

Description Checked for
Mathematical Accuracy
Athens County
ENGINEER'S OFFICE
BY: B. Blausch
DATE: 11-13-03

Description of Parcel No. 8

(11) Thence North 06°38'31" East a distance of 82.66 feet to a point;

(12) Thence North 13°14'24" East a distance of 82.04 feet to a point;

(13) Thence North 17°31'25" East a distance of 57.32 feet to a point;

Thence, leaving the road, South 90°00'00" East a distance of 1,955.51 feet to The Point of Beginning, passing through four iron pins set at distances of plus 30.00 feet, plus 130.00 feet, plus 830.00 feet, and plus 1,592.51 feet, respectively;

Containing 24.071 acres, more or less, being a new split out of Parcel No. 003-00200012-00.

Subject to all legal right-of-ways, easement, restrictions, reservations, and zoning regulations of record.

Subject to the right-of-way of County Road No. 92.

Subject to the 100-Year Flood Plain restrictions, if applicable.

Subject to a 50.00 feet wide easement being reserved unto the grantors (Bruner Land Company, Inc.), their heirs, and or assigns, forever. Said easement being for the purpose of running utilities to other parcels of land on or near County Road No. 92. Said easement runs in a north-south direction across the west end of the above-described property with the west line of said easement being the centerline of County Road No. 92. Containing 0.986 acre, more or less, of easement.

All iron pins set are 5/8" x 30" rebar capped and labeled "Claus 6456".

The bearings in this description are for angle calculations only and are based on the north line of Section 34 used as South 90°00'00" East.

A plat of the above-described survey has been submitted for file at the County Engineer's Office.

The above description prepared by Roger W. Claus, Registered Surveyor No. 6456, based on an actual field survey of November 5, 2003; said survey being subject to any facts that may be disclosed in a full and accurate title search.

Prior deed: Official Records Volume _____, Page _____.

Surveyor: *Roger W Claus*

Date: 11-06-03



DESCRIPTION OF PARCEL NO. 9

Situated in the State of Ohio, County of Athens, Township of Trimble, being in the northwest quarter of Section 34, Range 14 West, Township 11 North, of "The Ohio Company Second Purchase", and being bounded and described as follows:

Commencing for Reference at a steel railroad track found in the west line of Athens County at the northwest corner of Section 34 (Note: Reference bearing on the north line of Section 34 used as South 90°00'00" East.);

Thence, with the County Line, the Range Line, the west line of Section 34, South 00°00'59" West a distance of 2,121.00 feet to an iron pin set, being **THE TRUE POINT OF BEGINNING** for this description;

Thence, from said Point of Beginning and leaving the County Line, North 83°59'20" East a distance of 900.29 feet to a point in the centerline of County Road No. 92 (Hunterdon Road – 60' R/W), passing through two iron pins set at distances of plus 770.29 feet and plus 870.29 feet, respectively;

Thence, with the centerline of County Road No. 92, the following five courses:

- (1) South 27°59'13" East a distance of 71.43 feet to a point;
- (2) Thence South 15°12'47" East a distance of 56.88 feet to a point;
- (3) Thence South 07°14'09" West a distance of 59.90 feet to a point;
- (4) Thence South 29°31'51" West a distance of 37.29 feet to a point;
- (5) Thence South 45°28'48" West a distance of 33.18 feet to a point at the northeast corner of a 21.35 acres tract as conveyed to The United States of America by Deed Volume 180, Page 506 of the Athens County Recorder's Office;

Thence, leaving the road with the north line of said U.S.A. property, South 76°31'01" West a distance of 919.65 feet to a 2-1/2" pipe found with a 3-1/4" alum cap "T13 R15 S4 -- T11 R14 S34 – 19" in the west line of Section 34 and the west line of Athens County, passing through an iron pin set at a distance of plus 60.00 feet, passing through a 3/4" rebar found with 3-1/4" alum cap "U.S. Dept. of Agriculture Forest Service – unlawful to disturb – cadastral survey – T11 R14 C3 S34" at a distance of plus 294.57 feet, and passing through two wood forest service posts found at distances of plus 540.33 feet and plus 774.41 feet, respectively;

Thence, with the County Line, the Range Line, the west line of Section 34, North 00°00'59" East a distance of 353.24 feet to The Point of Beginning;

Containing 6.189 acres, more or less, being a new split out of Parcel No. 003-00200012-00.

Subject to all legal right-of-ways, easement, restrictions, reservations, and zoning regulations of record.

Subject to a 50.00 feet wide easement being reserved unto the grantors (Bruner Land Company, Inc.), their heirs, and or assigns, forever. Said easement being for the purpose of running utilities to other parcels of land on or near County Road No. 92. Said easement runs in a north-south direction across the east end of the above-described property with the east line of said easement being the centerline of County Road No. 92. Containing 0.297 acre, more or less, of easement.

Subject to the right-of-way of County Road No. 92.

Subject to the 100-Year Flood Plain restrictions, if applicable.

All iron pins set are 5/8" x 30" rebar capped and labeled "Claus 6456".

The bearings in this description are for angle calculations only and are based on the north line of Section 34 used as South 90°00'00" East.

A plat of the above-described survey has been submitted for file at the County Engineer's Office.

The above description prepared by Roger W. Claus, Registered Surveyor No. 6456, based on an actual field survey of November 5, 2003; said survey being subject to any facts that may be disclosed in a full and accurate title search.

Prior deed: Official Records Volume _____, Page _____.

Surveyor: *Roger W. Claus*

Date: 11-06-03

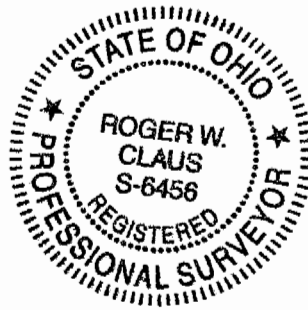

DESCRIPTION OF PARCEL NO. 10

Situated in the State of Ohio, County of Athens, Township of Trimble, being in the northwest quarter of Section 34, Range 14 West, Township 11 North, of "The Ohio Company Second Purchase", and being bounded and described as follows:

Commencing for Reference at a steel railroad track found in the west line of Athens County at the northwest corner of Section 34 (Note: Reference bearing on the north line of Section 34 used as South $90^{\circ}00'00''$ East.);

Thence, with the County Line, the Range Line, the west line of Section 34, South $00^{\circ}00'59''$ West a distance of 1,817.00 feet to an iron pin set, being **THE TRUE POINT OF BEGINNING** for this description;

Thence, from said Point of Beginning and leaving the County Line, North $88^{\circ}15'03''$ East a distance of 709.61 feet to a point in the centerline of County Road No. 92 (Hunterdon Road – 60' R/W), passing through three iron pins set at distances of plus 107.56 feet, plus 579.61 feet, and plus 679.61 feet, respectively;

Thence, with the centerline of County Road No. 92, the following four courses:

- (1) South $19^{\circ}47'14''$ East a distance of 44.26 feet to a point;
- (2) Thence South $38^{\circ}57'22''$ East a distance of 59.44 feet to a point;
- (3) Thence South $45^{\circ}33'14''$ East a distance of 111.08 feet to a point;
- (4) Thence South $39^{\circ}34'14''$ East a distance of 85.26 feet to a point;

Thence, leaving the road, South $83^{\circ}59'20''$ West a distance of 900.29 feet to an iron set in the west line of Section 34 and the west line of Athens County, passing through two iron pins set at distances of plus 30.00 feet and plus 130.00 feet, respectively;

Thence, with the County Line, the Range Line, the west line of Section 34, North $00^{\circ}00'59''$ East a distance of 304.00 feet to The Point of Beginning;

Containing 5.007 acres, more or less, being a new split out of Parcel No. 003-00200012-00.

Subject to all legal right-of-ways, easement, restrictions, reservations, and zoning regulations of record.

Subject to a 50.00 feet wide easement being reserved unto the grantors (Bruner Land Company, Inc.), their heirs, and or assigns, forever. Said easement being for the purpose of running utilities to other parcels of land on or near County Road No. 92. Said easement runs in a north-south direction across the east end of the above-described property with the east line of said easement being the centerline of County Road No. 92. Containing 0.344 acre, more or less, of easement.

Subject to the right-of-way of County Road No. 92.

Subject to the 100-Year Flood Plain restrictions, if applicable.

All iron pins set are $5/8''$ x $30''$ rebar capped and labeled "Claus 6456".

The bearings in this description are for angle calculations only and are based on the north line of Section 34 used as South $90^{\circ}00'00''$ East.

A plat of the above-described survey has been submitted for file at the County Engineer's Office.

The above description prepared by Roger W. Claus, Registered Surveyor No. 6456, based on an actual field survey of November 5, 2003; said survey being subject to any facts that may be disclosed in a full and accurate title search.

Prior deed: Official Records Volume _____, Page _____

Surveyor: *Roger W Claus*

Date: 11-06-03



DESCRIPTION OF PARCEL NO. 11

Situated in the State of Ohio, County of Athens, Township of Trimble, being in the northwest quarter of Section 34, Range 14 West, Township 11 North, of "The Ohio Company Second Purchase", and being bounded and described as follows:

Commencing for Reference at a steel railroad track found in the west line of Athens County at the northwest corner of Section 34 (Note: Reference bearing on the north line of Section 34 used as South 90°00'00" East.);

Thence, with the County Line, the Range Line, the west line of Section 34, South 00°00'59" West a distance of 1,501.00 feet to an iron pin set, being **THE TRUE POINT OF BEGINNING** for this description;

Thence, from said Point of Beginning and leaving the County Line, South 90°00'00" East a distance of 746.61 feet to a point in the centerline of County Road No. 92 (Hunterdon Road – 60' R/W), passing through three iron pins set at distances of plus 148.47 feet, plus 616.61 feet, and plus 716.61 feet, respectively;

Thence, with the centerline of County Road No. 92, the following four courses:

- (1) South 17°31'25" West a distance of 57.32 feet to a point;
- (2) Thence South 13°14'24" West a distance of 82.04 feet to a point;
- (3) Thence South 06°38'31" West a distance of 82.66 feet to a point;
- (4) Thence South 06°01'00" East a distance of 78.14 feet to a point;

Thence, leaving the road, South 88°15'03" West a distance of 709.61 feet to an iron set in the west line of Section 34 and the west line of Athens County, passing through three iron pins set at distances of plus 30.00 feet, plus 130.00 feet, and plus 602.05 feet, respectively;

Thence, with the County Line, the Range Line, the west line of Section 34, North 00°00'59" East a distance of 316.00 feet to The Point of Beginning;

Containing 5.011 acres, more or less, being a new split out of Parcel No. 003-00200012-00.

Subject to all legal right-of-ways, easement, restrictions, reservations, and zoning regulations of record.

Subject to a 50.00 feet wide easement being reserved unto the grantors (Bruner Land Company, Inc.), their heirs, and or assigns, forever. Said easement being for the purpose of running utilities to other parcels of land on or near County Road No. 92. Said easement runs in a north-south direction across the east end of the above-described property with the east line of said easement being the centerline of County Road No. 92. Containing 0.345 acre, more or less, of easement.

Subject to the right-of-way of County Road No. 92.

Subject to the 100-Year Flood Plain restrictions, if applicable.

All iron pins set are 5/8" x 30" rebar capped and labeled "Claus 6456".

The bearings in this description are for angle calculations only and are based on the north line of Section 34 used as South 90°00'00" East.

A plat of the above-described survey has been submitted for file at the County Engineer's Office.

The above description prepared by Roger W. Claus, Registered Surveyor No. 6456, based on an actual field survey of November 5, 2003; said survey being subject to any facts that may be disclosed in a full and accurate title search.

Prior deed: Official Records Volume _____, Page _____.

Surveyor: *Roger W. Claus*

Date: 11-06-03

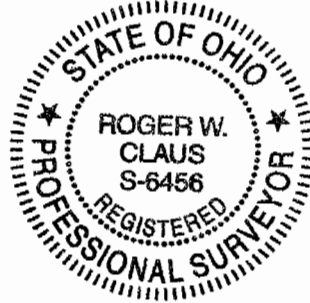

DESCRIPTION OF PARCEL NO. 12

Situated in the State of Ohio, County of Athens, Township of Trimble, being in the northwest quarter of Section 34, Range 14 West, Township 11 North, of "The Ohio Company Second Purchase", and being bounded and described as follows:

Commencing for Reference at a steel railroad track found in the west line of Athens County at the northwest corner of Section 34 (Note: Reference bearing on the north line of Section 34 used as South 90°00'00" East.);

Thence, with the County Line, the Range Line, the west line of Section 34, South 00°00'59" West a distance of 1,201.00 feet to an iron pin set, being **THE TRUE POINT OF BEGINNING** for this description;

Thence, from said Point of Beginning and leaving the County Line, South 89°37'44" East a distance of 802.14 feet to a point in the centerline of County Road No. 92 (Hunterdon Road – 60' R/W), passing through three iron pins set at distances of plus 154.59 feet, plus 672.14 feet, and plus 772.14 feet, respectively;

Thence, with the centerline of County Road No. 92, the following three courses:

- (1) South 05°10'09" West a distance of 145.36 feet to a point;
- (2) Thence South 13°50'03" West a distance of 72.20 feet to a point;
- (3) Thence South 17°31'25" West a distance of 83.82 feet to a point;

Thence, leaving the road, North 90°00'00" West a distance of 746.61 feet to an iron set in the west line of Section 34 and the west line of Athens County, passing through three iron pins set at distances of plus 30.00 feet, plus 130.00 feet, and plus 598.14 feet, respectively;

Thence, with the County Line, the Range Line, the west line of Section 34, North 00°00'59" East a distance of 300.00 feet to The Point of Beginning;

Containing 5.341 acres, more or less, being a new split out of Parcel No. 003-00200012-00.

Subject to all legal right-of-ways, easement, restrictions, reservations, and zoning regulations of record.

Subject to a 50.00 feet wide easement being reserved unto the grantors (Bruner Land Company, Inc.), their heirs, and or assigns, forever. Said easement being for the purpose of running utilities to other parcels of land on or near County Road No. 92. Said easement runs in a north-south direction across the east end of the above-described property with the east line of said easement being the centerline of County Road No. 92. Containing 0.346 acre, more or less, of easement.

Subject to the right-of-way of County Road No. 92.

Subject to the 100-Year Flood Plain restrictions, if applicable.

All iron pins set are 5/8" x 30" rebar capped and labeled "Claus 6456".

The bearings in this description are for angle calculations only and are based on the north line of Section 34 used as South 90°00'00" East.

A plat of the above-described survey has been submitted for file at the County Engineer's Office.

Description of Parcel No. 12

The above description prepared by Roger W. Claus, Registered Surveyor No. 6456, based on an actual field survey of November 5, 2003; said survey being subject to any facts that may be disclosed in a full and accurate title search.

Prior deed: Official Records Volume _____, Page _____.

Surveyor: *Roger W. Claus*

Date: 11-06-03

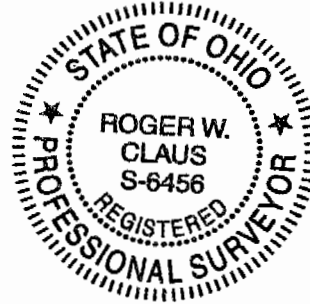

DESCRIPTION OF PARCEL NO. 13

Situated in the State of Ohio, County of Athens, Township of Trimble, being in the northwest quarter of Section 34, Range 14 West, Township 11 North, of "The Ohio Company Second Purchase", and being bounded and described as follows:

Commencing for Reference at a steel railroad track found in the west line of Athens County at the northwest corner of Section 34 (Note: Reference bearing on the north line of Section 34 used as South $90^{\circ}00'00''$ East.);

Thence, with the County Line, the Range Line, the west line of Section 34, South $00^{\circ}00'59''$ West a distance of 861.00 feet to an iron pin set, being **THE TRUE POINT OF BEGINNING** for this description;

Thence, from said Point of Beginning and leaving the County Line, South $86^{\circ}11'39''$ East a distance of 881.83 feet to a point in the centerline of County Road No. 92 (Hunterdon Road – 60' R/W), passing through three iron pins set at distances of plus 172.40 feet, plus 751.83 feet, and plus 851.83 feet, respectively;

Thence, with the centerline of County Road No. 92, the following four courses:

- (1) South $25^{\circ}11'23''$ West a distance of 67.28 feet to a point;
- (2) Thence South $18^{\circ}13'36''$ West a distance of 94.38 feet to a point;
- (3) Thence South $09^{\circ}34'15''$ West a distance of 95.97 feet to a point;
- (4) Thence South $05^{\circ}10'09''$ West a distance of 41.68 feet to a point;

Thence, leaving the road, North $89^{\circ}37'44''$ West a distance of 802.14 feet to an iron set in the west line of Section 34 and the west line of Athens County, passing through three iron pins set at distances of plus 30.00 feet, plus 130.00 feet, and plus 647.55 feet, respectively;

Thence, with the County Line, the Range Line, the west line of Section 34, North $00^{\circ}00'59''$ East a distance of 340.00 feet to The Point of Beginning;

Containing 6.009 acres, more or less, being a new split out of Parcel No. 003-00200012-00.

Subject to all legal right-of-ways, easement, restrictions, reservations, and zoning regulations of record.

Subject to a 50.00 feet wide easement being reserved unto the grantors (Bruner Land Company, Inc.), their heirs, and or assigns, forever. Said easement being for the purpose of running utilities to other parcels of land on or near County Road No. 92. Said easement runs in a north-south direction across the east end of the above-described property with the east line of said easement being the centerline of County Road No. 92. Containing 0.344 acre, more or less, of easement.

Subject to the right-of-way of County Road No. 92.

Subject to the 100-Year Flood Plain restrictions, if applicable.

All iron pins set are 5/8" x 30" rebar capped and labeled "Claus 6456".

The bearings in this description are for angle calculations only and are based on the north line of Section 34 used as South $90^{\circ}00'00''$ East.

A plat of the above-described survey has been submitted for file at the County Engineer's Office.

The above description prepared by Roger W. Claus, Registered Surveyor No. 6456, based on an actual field survey of November 5, 2003; said survey being subject to any facts that may be disclosed in a full and accurate title search.

Prior deed: Official Records Volume _____, Page _____.

Surveyor: *Roger W. Claus*

Date: 11-06-03



DESCRIPTION OF PARCEL NO. 14

Situated in the State of Ohio, County of Athens, Township of Trimble, being in the northwest quarter of Section 34, Range 14 West, Township 11 North, of "The Ohio Company Second Purchase", and being bounded and described as follows:

Beginning at a steel railroad track found in the west line of Athens County at the northwest corner of Section 34 (Note: Reference bearing on the north line of Section 34 used as South 90°00'00" East.);

Thence, from said Point of Beginning and running with the north line of Section 34, South 90°00'00" East a distance of 482.00 feet to an iron pin set;

Thence, leaving the section line, South 35°18'59" East a distance of 968.51 feet to a point in the centerline of County Road No. 92 (Hunterdon Road - 60' R/W), passing through three iron pins set at distances of plus 259.52 feet, plus 838.51 feet, and plus 938.51 feet, respectively;

Thence, with the centerline of County Road No. 92, the following three courses:

- (1) South 72°03'08" West a distance of 54.14 feet to a point;
- (2) Thence South 56°09'35" West a distance of 54.14 feet to a point;
- (3) Thence South 38°35'28" West a distance of 105.45 feet to a point;

Thence, leaving the road, North 86°11'39" West a distance of 881.83 feet to an iron set in the west line of Section 34 and the west line of Athens County, passing through three iron pins set at distances of plus 30.00 feet, plus 130.00 feet, and plus 709.43 feet, respectively;

Thence, with the County Line, the Range Line, the west line of Section 34, North 00°00'59" East a distance of 861.00 feet to The Point of Beginning;

Containing 16.021 acres, more or less, being a new split out of Parcel No. 003-00200012-00.

Subject to all legal right-of-ways, easement, restrictions, reservations, and zoning regulations of record.

Subject to a 50.00 feet wide easement being reserved unto the grantors (Bruner Land Company, Inc.), their heirs, and or assigns, forever. Said easement being for the purpose of running utilities to other parcels of land on or near County Road No. 92. Said easement runs in a southwest to northeast direction across the southeast end of the above-described property with the southeast line of said easement being the centerline of County Road No. 92. Containing 0.245 acre, more or less, of easement.

Subject to the right-of-way of County Road No. 92.

Subject to the 100-Year Flood Plain restrictions, if applicable.

All iron pins set are 5/8" x 30" rebar capped and labeled "Claus 6456".

The bearings in this description are for angle calculations only and are based on the north line of Section 34 used as South 90°00'00" East.

A plat of the above-described survey has been submitted for file at the County Engineer's Office.

The above description prepared by Roger W. Claus, Registered Surveyor No. 6456, based on an actual field survey of November 5, 2003; said survey being subject to any facts that may be disclosed in a full and accurate title search.

Prior deed: Official Records Volume _____, Page _____.

Surveyor: Roger W. Claus

Date: 11-06-03



Description Checked for
Mathematical Accuracy
Athens County
ENGINEER'S OFFICE
BY: S. J. Claus
DATE: 11-13-03

DESCRIPTION OF PARCEL NO. 15

Situated in the State of Ohio, County of Athens, Township of Trimble, being in the northwest quarter of Section 34, Range 14 West, Township 11 North, of "The Ohio Company Second Purchase", and being bounded and described as follows:

Commencing for Reference at a steel railroad track found in the west line of Athens County at the northwest corner of Section 34 (Note: Reference bearing on the north line of Section 34 used as South $90^{\circ}00'00''$ East.);

Thence, with the north line of Section 34, South $90^{\circ}00'00''$ East a distance of 482.00 feet to an iron pin set, being **THE TRUE POINT OF BEGINNING** for this description;

Thence, from said Point of Beginning and continuing with the north line of Section 34, South $90^{\circ}00'00''$ East a distance of 477.00 feet to an iron pin set;

Thence, leaving the section line, South $25^{\circ}15'03''$ East a distance of 898.01 feet to a point in the centerline of County Road No. 92 (Hunterdon Road – 60' R/W), passing through three iron pins set at distances of plus 280.63 feet, plus 768.01 feet, and plus 868.01 feet, respectively;

Thence, with the centerline of County Road No. 92, the following three courses:

- (1) North $85^{\circ}32'52''$ West a distance of 150.26 feet to a point;
- (2) Thence North $82^{\circ}14'40''$ West a distance of 90.30 feet to a point;
- (3) Thence South $88^{\circ}11'20''$ West a distance of 60.93 feet to a point;

Thence, leaving the road, North $35^{\circ}18'59''$ West a distance of 968.51 feet to The Point of Beginning, passing through three iron pins set at distances of plus 30.00 feet, plus 130.00 feet, and plus 708.99 feet, respectively;

Containing 7.016 acres, more or less, being a new split out of Parcel No. 003-00200012-00.

Subject to all legal right-of-ways, easement, restrictions, reservations, and zoning regulations of record.

Subject to a 50.00 feet wide easement being reserved unto the grantors (Bruner Land Company, Inc.), their heirs, and or assigns, forever. Said easement being for the purpose of running utilities to other parcels of land on or near County Road No. 92. Said easement runs in an east-west direction across the south end of the above-described property with the south line of said easement being the centerline of County Road No. 92. Containing 0.346 acre, more or less, of easement.

Subject to the right-of-way of County Road No. 92.

Subject to the 100-Year Flood Plain restrictions, if applicable.

All iron pins set are 5/8" x 30" rebar capped and labeled "Claus 6456".

The bearings in this description are for angle calculations only and are based on the north line of Section 34 used as South $90^{\circ}00'00''$ East.

A plat of the above-described survey has been submitted for file at the County Engineer's Office.

Description Checked for
Mathematical Accuracy
Athens County
ENGINEER'S OFFICE
BY: A. Blause
DATE: 11-13-03

Description of Parcel No. 15

The above description prepared by Roger W. Claus, Registered Surveyor No. 6456, based on an actual field survey of November 5, 2003; said survey being subject to any facts that may be disclosed in a full and accurate title search.

Prior deed: Official Records Volume _____, Page _____.

Surveyor: Roger W Claus

Date: 11-06-03

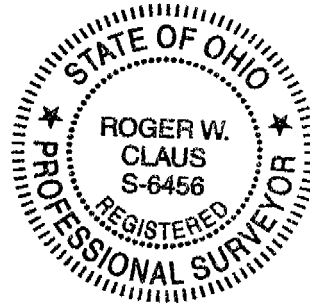

DESCRIPTION OF PARCEL NO. 16

Situated in the State of Ohio, County of Athens, Township of Trimble, being in the northwest quarter of Section 34, Range 14 West, Township 11 North, of "The Ohio Company Second Purchase", and being bounded and described as follows:

Commencing for Reference at a steel railroad track found in the west line of Athens County at the northwest corner of Section 34 (Note: Reference bearing on the north line of Section 34 used as South 90°00'00" East.);

Thence, with the north line of Section 34, South 90°00'00" East a distance of 959.00 feet to an iron pin set;

Thence, leaving the section line, South 25°15'03" East a distance of 280.63 feet to an iron pin set, being **THE TRUE POINT OF BEGINNING** for this description;

Thence, from said Point of Beginning, North 88°34'21" East a distance of 798.68 feet to a point in the centerline of County Road No. 92 (Hunterdon Road – 60' R/W), passing through two iron pins set at distances of plus 668.68 feet and plus 768.68 feet, respectively;

Thence, with the centerline of County Road No. 92, the following ten courses:

- (1) South 14°13'31" West a distance of 201.67 feet to a point;
- (2) Thence South 25°44'38" West a distance of 47.86 feet to a point;
- (3) Thence South 33°44'52" West a distance of 150.00 feet to a point;
- (4) Thence, continuing, South 33°44'52" West a distance of 119.74 feet to a point;
- (5) Thence South 41°54'38" West a distance of 30.51 feet to a point;
- (6) Thence South 52°15'30" West a distance of 70.51 feet to a point;
- (7) Thence South 63°03'45" West a distance of 65.38 feet to a point;
- (8) Thence South 75°15'11" West a distance of 59.52 feet to a point;
- (9) Thence South 85°54'39" West a distance of 55.21 feet to a point;
- (10) Thence South 89°18'03" West a distance of 67.82 feet to a point;

Thence, leaving the road, North 25°15'03" West a distance of 617.38 feet to The Point of Beginning, passing through two iron pins set at distances of plus 30.00 feet and plus 130.00 feet, respectively;

Containing 7.021 acres, more or less, being a new split out of Parcel No. 003-00200012-00.

Subject to all legal right-of-ways, easement, restrictions, reservations, and zoning regulations of record.

Subject to a 50.00 feet wide easement being reserved unto the grantors (Bruner Land Company, Inc.), their heirs, and or assigns, forever. Said easement being for the purpose of running utilities to other parcels of land on or near County Road No. 92. Said easement runs in an east-west direction across the south end of the above-described property with the south line of said easement being the centerline of County Road No. 92. Containing 0.997 acre, more or less, of easement.

Description of Parcel No. 16

Subject to the right-of-way of County Road No. 92.

Subject to the 100-Year Flood Plain restrictions, if applicable.

All iron pins set are 5/8" x 30" rebar capped and labeled "Claus 6456".

The bearings in this description are for angle calculations only and are based on the north line of Section 34 used as South 90°00'00" East.

A plat of the above-described survey has been submitted for file at the County Engineer's Office.

The above description prepared by Roger W. Claus, Registered Surveyor No. 6456, based on an actual field survey of November 5, 2003; said survey being subject to any facts that may be disclosed in a full and accurate title search.

Prior deed: Official Records Volume _____, Page _____.

Surveyor: Roger W. Claus
Date: 11-06-03

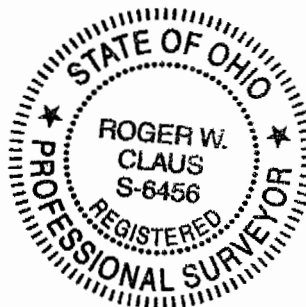

DESCRIPTION OF PARCEL NO. 17

Situated in the State of Ohio, County of Athens, Township of Trimble, being in the northwest quarter of Section 34, Range 14 West, Township 11 North, of "The Ohio Company Second Purchase", and being bounded and described as follows:

Commencing for Reference at a steel railroad track found in the west line of Athens County at the northwest corner of Section 34 (Note: Reference bearing on the north line of Section 34 used as South 90°00'00" East.);

Thence, with the north line of Section 34, South 90°00'00" East a distance of 959.00 feet to an iron pin set, being **THE TRUE POINT OF BEGINNING** for this description;

Thence, from said Point of Beginning and continuing with the north line of Section 34, South 90°00'00" East a distance of 991.00 feet to a point in the centerline of County Road No. 92 (Hunterdon Road - 60' R/W), passing through an iron pin set at a distance of plus 961.00 feet;

Thence, with the centerline of County Road No. 92, South 17°18'04" West a distance of 245.00 feet to a point;

Thence, leaving the road, South 88°34'21" West a distance of 798.68 feet to an iron pin set, passing through two iron pins set at distances of plus 30.00 feet and plus 130.00 feet, respectively;

Thence North 25°15'03" West a distance of 280.63 feet to The Point of Beginning;

Containing 5.014 acres, more or less, being a new split out of Parcel No. 003-00200012-00.

Subject to all legal right-of-ways, easement, restrictions, reservations, and zoning regulations of record.

Subject to a 50.00 feet wide easement being reserved unto the grantors (Bruner Land Company, Inc.), their heirs, and or assigns, forever. Said easement being for the purpose of running utilities to other parcels of land on or near County Road No. 92. Said easement runs in a north-south direction across the east end of the above-described property with the east line of said easement being the centerline of County Road No. 92. Containing 0.281 acre, more or less, of easement.

Subject to the right-of-way of County Road No. 92.

Subject to the 100-Year Flood Plain restrictions, if applicable.

All iron pins set are 5/8" x 30" rebar capped and labeled "Claus 6456".

The bearings in this description are for angle calculations only and are based on the north line of Section 34 used as South 90°00'00" East.

A plat of the above-described survey has been submitted for file at the County Engineer's Office.

The above description prepared by Roger W. Claus, Registered Surveyor No. 6456, based on an actual field survey of November 5, 2003; said survey being subject to any facts that may be disclosed in a full and accurate title search.

Prior deed: Official Records Volume _____, Page _____.

Surveyor: Roger W. Claus

Date: 11-12-03



Description Checked for
Mathematical Accuracy
Athens County
ENGINEER'S OFFICE
BY: S. Blaus
DATE: 11-13-03

Line	Bearing	Distance
1	S 90°00'00"E	30.00'
2	S 90°00'00"E	30.00'
3	S 0°03'41"E	322.00'
4	S 0°03'41"E	268.00'
5	S 0°03'41"E	320.00'
6	S 0°03'41"E	325.22'
7	S 76°31'01"W	199.56'
8	S 76°31'01"W	188.07'
9	S 76°31'01"W	358.66'
10	S 76°31'01"W	234.30'
11	S 76°31'01"W	266.87'
12	S 76°31'01"W	40.00'
13	S 76°31'01"W	60.00'
14	S 76°31'01"W	234.57'
15	S 76°31'01"W	245.76'
16	S 76°31'01"W	234.08'
17	S 76°31'01"W	145.24'
18	N 0°00'59"E	304.00'
19	N 0°00'59"E	316.00'
20	N 0°00'59"E	300.00'
21	N 0°00'59"E	340.00'
22	N 83°53'35"W	100.00'
23	N 83°53'35"W	30.00'
24	N 17°18'04"E	245.00'
25	N 82°30'47"W	100.00'
26	N 82°30'47"W	30.00'
27	N 25°44'38"E	47.86'
28	N 14°13'31"E	201.67'
29	N 59°09'53"W	100.00'
30	N 59°09'53"W	30.00'
31	N 33°44'52"E	150.00'
32	N 90°00'00"W	363.00'
33	N 41°56'17"W	266.31'
34	N 41°56'17"W	100.00'
35	N 41°56'17"W	30.00'
36	N 41°54'38"E	30.51'
37	N 33°44'52"E	119.74'
38	N 85°54'39"E	55.21'
39	N 75°15'11"E	59.52'
40	N 63°03'45"E	65.38'
41	N 52°15'30"E	70.51'
42	N 16°12'24"W	335.86'
43	N 16°12'24"W	100.00'
44	N 16°12'24"W	30.00'
45	N 89°18'03"E	67.82'
46	N 85°55'47"W	100.00'
47	N 85°55'47"W	30.00'
48	N 5°10'09"E	41.68'
49	N 9°34'15"E	95.97'
50	N 18°13'36"E	94.38'
51	N 25°11'23"E	67.28'
52	N 38°35'28"E	105.45'
53	N 56°09'35"E	54.14'
54	N 72°03'08"E	54.14'
55	N 88°11'20"E	60.93'
56	S 82°14'40"E	90.30'
57	S 85°32'52"E	150.26'
58	N 90°00'00"W	100.00'
59	N 90°00'00"W	30.00'
60	N 17°31'25"E	83.82'
61	N 13°50'03"E	72.20'
62	N 5°10'09"E	145.36'
63	S 41°56'17"E	266.31'
64	N 45°28'48"E	33.18'
65	N 29°31'51"E	37.29'
66	N 7°14'09"E	59.90'
67	N 15°12'47"W	56.88'
68	N 27°59'13"W	71.43'
69	N 39°34'14"W	85.26'
70	N 45°33'14"W	111.08'
71	N 38°57'22"W	59.44'
72	N 19°47'14"W	44.26'
73	N 6°01'00"W	78.14'
74	N 6°38'31"E	82.66'
75	N 13°14'24"E	82.04'
76	N 17°31'25"E	57.32'
77	N 83°59'20"E	100.00'
78	N 83°59'20"E	30.00'
79	N 88°15'03"E	107.56'
80	N 88°15'03"E	100.00'
81	N 88°15'03"E	30.00'
82	S 90°00'00"E	148.47'
83	S 90°00'00"E	100.00'
84	S 90°00'00"E	30.00'
85	S 89°37'44"E	154.59'
86	S 89°37'44"E	100.00'
87	S 89°37'44"E	30.00'
88	S 86°11'39"E	172.40'
89	S 86°11'39"E	100.00'
90	S 86°11'39"E	30.00'
91	N 35°18'59"W	100.00'
92	N 35°18'59"W	259.52'
93	N 35°18'59"W	30.00'
94	N 25°15'03"W	100.00'
95	N 25°15'03"W	100.00'
96	S 88°34'21"W	30.00'
97	S 88°34'21"W	100.00'
98	N 25°15'03"W	280.63'
99	S 0°31'52"E	52.13'

HOCKING CO.
WARD TWP.

ATHENS CO.
TRIMBLE TWP.



THE BEARINGS ON THIS PLAT ARE FOR ANGLE CALCULATIONS ONLY AND ARE BASED ON AN ASSUMED BEARING ON THE NORTH LINE OF SECTION 34 USED AS SOUTH 90°00'00" EAST.

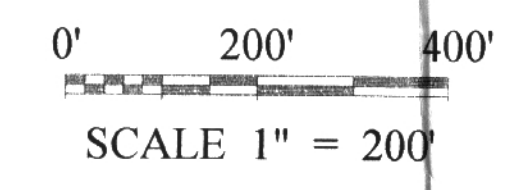

SURVEY PLAT FOR BRUNER LAND CO., INC.

SITUATED IN THE STATE OF OHIO, COUNTY OF ATHENS, TOWNSHIP OF TRIMBLE, BEING IN THE NORTHWEST QUARTER OF SECTION 34, RANGE 14 WEST, TOWNSHIP 11 NORTH, OF "THE OHIO COMPANY SECOND PURCHASE".

PERTINENT DOCUMENTS

- (1) ALL DEEDS AS SHOWN.
- (2) COUNTY TAX MAPS.
- (3) U.S.G.S. QUAD. MAP "NEW STRAITSVILLE
- (4) SURVEY PLAT BY LEVI DAVIS JULY 15, 1901
- (5) SURVEY PLAT BY GEORGE SEYMOUR
- (6) SURVEY PLAT BY GREGORY K. WRIGHT
- (7) TWO SURVEY PLATS BY ALBERT W. SEABRIGHT
- (8) SURVEY PLAT BY DENNIS P. HAGAN

UNITED STATES OF AMERICA
93.00 ACRES PART OF
326.00 ACRES TOTAL
D.V. 82, PG. 606

SUNDAY CREEK COAL CO.
0.20 ACRE
D.V. 51, PG. 326

SUNDAY CREEK COAL CO.
581.63 ACRES
D.V. 51, PG. 328

GREENWAY TRACT NO. 1
26.06 ACRES
SMOKE RISE SUBDIVISION
PLAT BOOK 11, MAP 1
SHEETS 2 OF 18

SEMINGSON ENTERPRISES, INC.
100.85 ACRES

SEE ORIGINAL 1957.59 ACRES
PARCEL 1 OF D.V. 368, PG. 88

SMOKE RISE SUBDIVISION
PLAT BOOK 11, MAP 1
SHEETS 2 AND 3 OF 18

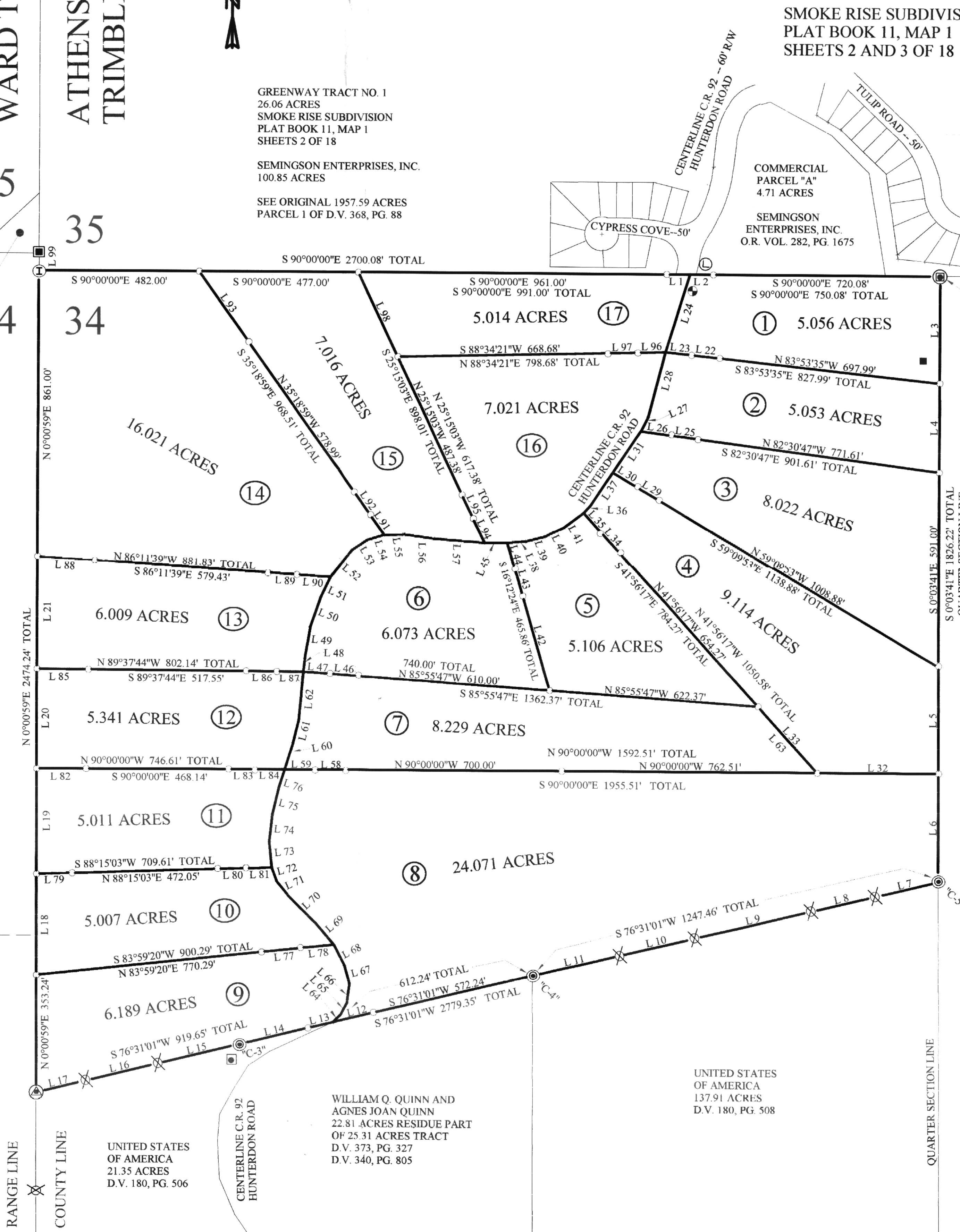

SECTION 35

SECTION 34

N.E. CORNER OF N.W. 1/4 OF SECTION 34

- ⊙ = 3/4" REBAR FOUND WITH 3-1/4" ALUM CAP "U.S. DEPT. OF AGRICULTURE FOREST SERVICE -- UNLAWFUL TO DISTURB CADASTRAL SURVEY -- T11 R14 C S34"
- ⊗ = WOOD POST FOUND -- U.S. FOREST SERVICE.
- ⊕ = ANGLE IRON FOUND UNCAPPED.
- ⊖ = 2-1/2" PIPE FOUND WITH 3-1/4" ALUM CAP "T13 R15 S4 -- T11 R14 S34 -- 19"
- ⊗ = 2-1/2" PIPE FOUND WITH 3-1/4" ALUM CAP "T11 R14 W S35 S34 2001 6282"
- ⊕ = STEEL RAILROAD TRACK FOUND ON END.
- ⊖ = 1" STEEL ROD FOUND UNCAPPED.
- ⊗ = WOOD HUB FOUND.
- ⊕ = 3/4" IRON PIPE FOUND UNCAPPED.
- ⊖ = 5/8" X 30" IRON PIN SET CAPPED "CLAUS 6456"
- ⊗ = 5/8" IRON PIN FOUND UNCAPPED.
- ⊕ = 2" SQUARE HEAD BOLT FOUND UNCAPPED
- ⊖ = " IRON PIN FOUND CAPPED "
- ⊗ = " IRON PIN FOUND CAPPED "
- ⊕ = CONC. MONU. FOUND "ATHENS COUNTY ENGINEER 1995 -- DO NOT DISTURB"
- ⊖ = MARKED STONE FOUND.
- ⊗ = UN-MARKED STONE FOUND
- ⊕ = SURVEY ANGLE POINT
- ⊖ = RAILROAD SPIKE SET
- ⊗ = RAILROAD SPIKE FOUND.
- ⊕ = TREE WITH WIRE FOUND
- ⊖ = EXISTING PROPERTY LINES
- ⊗ = FENCE EVIDENCE FOUND
- ⊕ = LINES OF THIS SURVEY

SUNDAY CREEK COAL CO.
337.76 ACRES
D.V. 127, PG. 633

SEE ITEM 1
AT BOTTOM OF
PAGE 633
85.50 ACRES

Description Checked for
Mathematical Accuracy
Athens County
ENGINEER'S OFFICE
BY: *S. Blaney*
DATE: 11-12-03

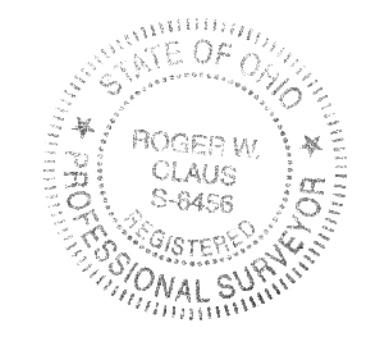

SUBJECT TO ALL LEGAL RIGHT-OF-WAYS, EASEMENTS, RESTRICTIONS, RESERVATIONS, AND ZONING REGULATIONS OF RECORD. SUBJECT TO 100 YEAR FLOOD PLAIN RESTRICTIONS, IF APPLICABLE. SUBJECT TO ANY FACTS THAT MAY BE DISCLOSED IN A FULL AND ACCURATE TITLE SEARCH.

SURVEYORS CERTIFICATION:

I HEREBY CERTIFY THAT THIS PLAT IS TRUE AND CORRECT TO THE BEST OF MY KNOWLEDGE AND THAT IT WAS PREPARED FROM AN ACTUAL FIELD SURVEY OF THE PREMISES.

Roger W. Claus 11-06-03
ROGER W. CLAUS, REG. SURVEYOR 6456 DATE:
33310 CHRISTMAN RIDGE ROAD
LEWISVILLE, OHIO 43754
1-740-567-3168
1-740-567-3106 fax

TOTAL FARM = 133.353 ACRES
PARCEL NO. 003-00200012-00
NEW SURVEY FOR BRUNER LAND CO., INC.
O.R. VOL. _____, PG. _____

PRIOR OWNERS:
JONATHAN R. AND JULIE A. DeVORE
133.26 ACRES DEED
O.R. VOL. 349, PG. 1565
PARCEL NO. 003-00200012-00

REVISIONS	DATE	INITIALS