

ATHENS COUNTY
ATHENS TOWNSHIP

501-29
3-3-95



Sheet No.	Location	Closest Railroad	Length	Remarks
1	At Athens, Ohio	Public		

No.	Grantor	Grantee	Instrument	Date	Record	Cust No.
1	Jewett Hens	O.C.R.R. Co.	Voucher	Feb 13, 1892		77
2	Peter Martin	O.C.R.R. Co.	Voucher	Dec 16, 1891		78
3	Joseph Dorr	O.C.R.R. Co.	Voucher	Feb 16, 1892		79
4	Henry Lohse	O.C.R.R. Co.	Voucher	Dec 4, 1891		80
5	Hiram Armitage	O.C.R.R. Co.	Voucher	Feb 20, 1892		81
6	Hiram Armitage	O.C.R.R. Co.	Voucher	Feb 20, 1892		82

Accounting records show the payment of \$500.00 to Jewett Hens for this parcel but deed cannot be located. Held by adverse possession and claimed by R.V. Co. to Peter Martin for this parcel but deed cannot be located. Accounting records show the payment of \$340.00 to Joseph Dorr Feb 16, 1892. Accounting records show the payment of \$500.00 to Henry Lohse Dec 4, 1891. Accounting records show the payment of \$1000.00 to Hiram Armitage Feb 20, 1892.

BY AGREEMENT OF INTEREST PARTIES DATED DEC. 15, 1907, APPROVED BY THE BOARD OF PUBLIC UTILITIES COMMISSION, JUNE 17, 1908, FIN. AND STOCK NO. 11007, THE KANAWHA AND MICHIGAN RY. CO. WASHINGTON, D.C. THE TOLEDO AND OHIO CENTRAL RAILWAY CO., INVESTING JUNE 30, 1908.

Sheet No 19 of 55 of The Kanawha & Michigan Railway
from Survey Station 10728+00 to Survey Station 10836+00

Land & Rail Agent

THE TOLEDO AND OHIO CENTRAL RAILWAY
RIGHT-OF-WAY AND TRACK MAP
STATION 10728+00 TO STATION 10836+00
SCALE 1 IN. = 200 FT.
JUNE 30, 1918.

OPERATED BY THE NEW YORK CENTRAL RAILROAD COMPANY SUBSEQUENT TO DECEMBER 31, 1917.

OFFICE OF LAND AND TAX AGENT
COLUMBUS, OHIO.

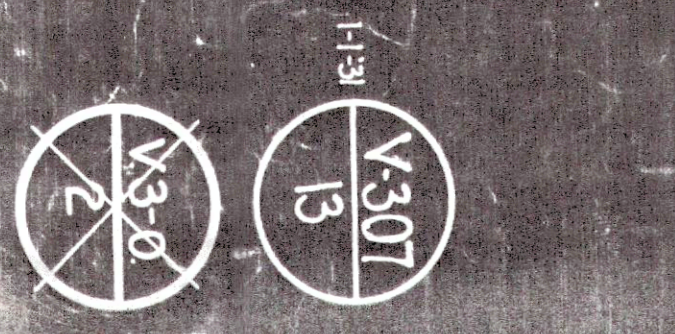

REVISION	DATE	BY	DESCRIPTION
1	1918	J. H.
2	1918	J. H.
3	1918	J. H.
4	1918	J. H.
5	1918	J. H.
6	1918	J. H.
7	1918	J. H.
8	1918	J. H.
9	1918	J. H.
10	1918	J. H.
11	1918	J. H.
12	1918	J. H.
13	1918	J. H.
14	1918	J. H.
15	1918	J. H.
16	1918	J. H.
17	1918	J. H.
18	1918	J. H.
19	1918	J. H.
20	1918	J. H.

Athens
map