

AUTHORITY	DATE INSTALLED OR RETIRED	DESCRIPTION
C-27203 A.E. 1923	July 17-1921	Removal of No. 4 from station 8712+00 to station 8720+00. Lengths are now 2224' and 780' respectively. Also removal of an Block Bridge over Run, east bank of Mill Creek at station 8723+00. Tracks and bridge removed. Caneville Coal Co.
C-24214 A.E. 1924	June 28, 1923	Extension of Eastward Passing Station 1-3, Station 8714+00.
C-22409 A.E. 1925	Feb. 25, 1923	Removal of Culvert, Pole 657/3, Station 8915+30.



91-01145.1(35)

**ATHENS CO. OHIO.  
CANAN TWP.  
TENN. R. 13W.**

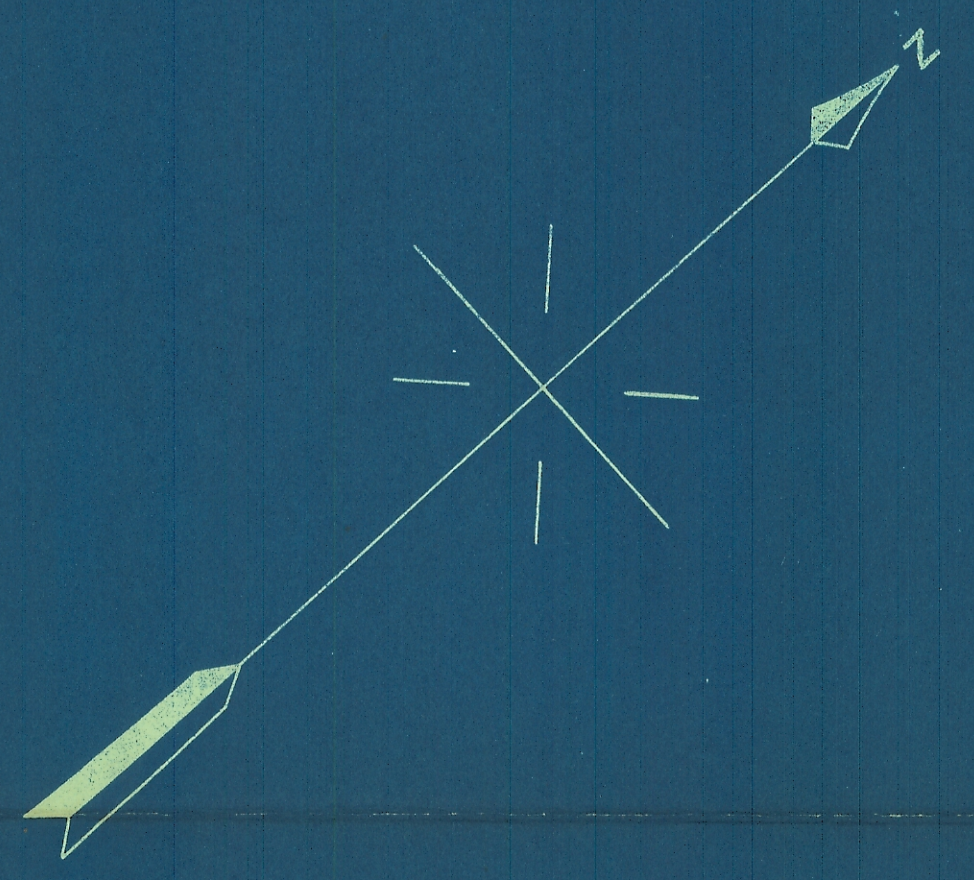

Notes:  
All distances are given on the right hand side and all distances are measured from the center line of track.

Survey:  
E.E. Halbert  
Highway, relocated and two public lines, abandoned Agreement dated 1/28/1921, Cont. No. 844.

**RECORD OF CHANGES AFTER DATE OF VALUATION**

**RIGHT-OF-WAY AND TRACK MAP**

**THE BALTIMORE AND OHIO SOUTHWESTERN RAILROAD COMPANY**  
OPERATED BY  
**THE BALTIMORE AND OHIO RAILROAD COMPANY**  
OHIO DIVISION

STATION 8712+00 TO STATION 8917+00  
SCALE: 1 IN. = 200 FT.  
JUNE 30, 1918  
OFFICE OF VALUATION ENGINEER  
BALTIMORE, MD.

REVISIONS TO

NO.	DATE	DESCRIPTION
1	1918	Original
2	1918	As shown
3	1918	As shown
4	1918	As shown
5	1918	As shown
6	1918	As shown
7	1918	As shown
8	1918	As shown
9	1918	As shown
10	1918	As shown

W451  
35

*Canan*  
*50c 94*  
*2x8*