

REVISION	REFERENCE	DATE PLOTTED	A.F.E.	BY
1	Crossing Trk # 624 Retired	10-11-32	3319-P12	L.G.A.
2	Alterations in Passenger Station	11-17-32	4392	E.W.N.
3	Land Schedule	2-28-34		E.W.N.
4	Express Bldg. Retired	10-4-35	11118	B.O.W.
5	Change RW Lines Parcel No 2	1-31-36		C.V.L.
6	Tracks 625, 625-A, 630 Retired	2-11-36	11231	B.O.W.
7	General Revisions From Field Check	2-1-36		C.V.L.
8	Monumenting Original Center Line	2-10-36		C.V.L.
9	Encroachments by Alfred Richardson et al	2-24-38		C.V.L.
10	Revision Tracks & Contract References	3-24-38		F.A.O.
11	Changes in Watkins Street Crossing	10-15-38	12092	E.W.N.
12	Road Crossing	5-23-39		D.L.A.
13	Land Purchased from State- Parcel No 15	6-13-39	10396	C.V.L.
14	Cont. RW Mns. Parcel No 15	11-21-39	10398	D.E.R.
15	Amalgamating US Route 33 & Trk # 632	4-23-41	14368	D.E.R.
16	Retire Trk # 627 Portion Trk # 231c	6-29-42	15377	F.A.O.
17	Retire Trk # 622 Portion Trk # 623	5-18-43	15727	D.E.R.
18	Retire 120' of Freight Platform	11-1-42	16835	J.A.C.
19	Map Remarks	5-19-48		L.J.H.C.
20	Relocate Bldgs Nos 644 & 687	2-12-52	20626-2	H.J.C.
21	Relocate Bldgs # 645	10-23-52		H.J.C.
22	Relocate Bldgs # 1066	10-29-52		H.J.C.
23	Abol. Parcel No 10	8-15-54		L.H.C.
24	Abol. Parcel No 11	9-11-59	22621	F.A.S.
25	Retire Depot Building # 641	1-19-50	23621	G.A.H.
26	Parcel No 5 Cont.	4-19-59		F.A.S.
27	Parcel No 5 Cont.	1-18-52		F.A.S.
28	Parcel No 5 Cont.	10-29-52	23624	F.A.S.
29	Parcel No 1916	10-14-63	25031	G.A.H.
30	Retire Bldg Nos (as Storage)	7-2-65	25207	F.A.S.
31	Retire Bldg # 641, 687, 703	7-6-65	25208	F.A.S.
32	Retire Bldg # 643 (to 10)	11-1-65	25209	F.A.S.
33	Retired Trk # 628-529	6-27-66	25746	F.A.S.
34	Remove Fulton St Crossing	10-2-61	23245	H.J.C.



NO.	GRANTOR	GRANTEE	INSTRUMENT	DATE	RECORD	CUST. NO.	REMARKS	
1.	L.D. Poston, et al	C. & H.V.R.R.	Grant	Aug. 29, 1867	D. B. 110 P. 137	Sept. 17, 1909	1428	Same as Parcel No 2, Map No. 53
2.	W.B. Brooks	C. & H.V.R.R.	Grant	Jan. 13, 1868	D. B. 110 P. 139	Sept. 17, 1909	1427	
3.	Craig Biddle, et al	C. & H.V.R.R.	Grant	Dec. 19, 1867	D. B. 110 P. 141	Sept. 17, 1909	1426	
3.	City of Nelsonville, O	C. & H.V.R.R.	Agreement	About 1867				Right to Occupy & Cross Canal St.
4.	Eugene J. Cable	C. & H.V.R.R.	Grant	June 24, 1869	D. B. 110 P. 143	Sept. 17, 1909	1425	
5.	Henry C. Comstock, et al.	C. H.V. & T. Ry.	Deed	July 29, 1885	D. B. 57 P. 451	July 31, 1885	1424	
5.	C. & O. Ry. Co.	CHARLES VAUGHN & CO. QUICCLAIM		MAR 25, 1959			29/10	
6.	J.J. Robbins et al.	C. & H.V.R.R.	Deed	Oct. 17, 1872	D. B. 40 P. 112	Oct. 23, 1872	1423	Part of Land in Deed
7.	C. Robbins	C. H.V. & T. Ry.	Grant	Nov. 11, 1882	D. B. 110 P. 145	Sept. 17, 1909	1421	Part of Land in Grant
8.	G.D. Freer	C. & H.V.R.R.	Grant	Apr. 1, 1869	D. B. 110 P. 147	Sept. 17, 1909	1420	
9.	Polly Watkins	C. & H.V.R.R.	Condemnation	Dec. 1, 1869		Probate Court Record	1416	Same as Parcel No. 1, Map No. 55. Part of Land in Condemnation
9.	City of Nelsonville, O	C. & H.V.R.R.	Agreement	About 1869				Right to Occupy & Cross Watkins & Courtauld St.
9.	City of Nelsonville, O	C. & O. Ry.	Ordinance	March 2, 1931		C. & O. Ordinance No. 367		Closes Courtauld St. From N. to S. C. & O. R/W Lines
10.	Clarence J. Goe, by Guardian	C. H.V. & T. Ry.	Deed	March 14, 1896	D. B. 76 P. 303	March 24, 1896	1418	
11.	J.J. Robins, et al.	C. & H.V.R.R.	Deed	Oct. 17, 1872	D. B. 40 P. 112	Oct. 23, 1872	1423	Part of Land in Deed
11.	H.V. Ry.	Clinton D. Shafer, et al.	Quit Claim	Nov. 4, 1921	D. B. 140 P. 503	Apr. 1, 1924	1422	
12.	Clinton D. Shafer, et ux.	H.V. Ry.	Quit Claim	May 15, 1923	D. B. 139 P. 69	July 13, 1923	1417	
13.	City of Nelsonville, O.	C. & H.V.R.R.	Agreement	About 1869				Right to Occupy & Cross Fulton St.
14.	C. Robbins	C. H.V. & T. Ry.	Grant	Nov. 11, 1882	D. B. 110 P. 145	Sept. 17, 1909	1421	Part of Land in Grant
15.	State of Ohio	C. & O. Ry.	Governors Deed	Apr. 6, 1933	D. B. 174 P. 81	Apr. 25, 1933	2557	
16.	Col. G. South, Ohio Elect. Co.	C. & O. Ry.	EASEMENT	MAY 10, 1936	D. B. 196 P. 329	JUNE 2, 1936	2760	FOR RAILROAD PURPOSES
17.	G.D. FREER	C. & H.V.R.R.	GRANT	APR 1, 1869	D. B. 110 P. 147	SEPT. 17, 1909	1420	
17.	C. & O. Ry. Co.	THE W.B. BROOKS-SMITH CO. QUICCLAIM		OCT. 16, 1968			2844	

RIGHT OF WAY AND TRACK MAP
THE CHESAPEAKE AND OHIO RAILWAY COMPANY
HOCKING DIVISION

STATION 3244+68 TO STATION 3300+13

SCALE: 1 INCH = 100 FEET
 DECEMBER 31, 1927

Office of Chief Engineer
 Richmond, Virginia.

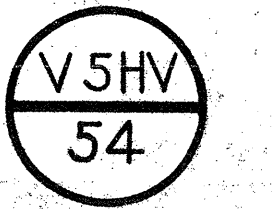

NOTE: "CUST. No." refers to deed numbers in Hocking Valley District.