

AUTHORITY	DATE INSTALLED OR RETIRED	DESCRIPTION
C 19235 A.F.E. 2511	Installed Oct. 15, 1921.	Construction of track 544E L+703 ft to serve Carbondale Coal Co. at Carbondale, P.S. of east end of station 228+65.
C 21174 A.F.E. 4431	Retired June 1, 1922	Removal of Xover 5A6A(1), L+162' including one No. 7 and one No. 8 turnout, was between main track and T-5A6A(1) with P.S. in main track at station 216+47.6, entirely owned by Railroad Co., served Carbondale Mine No. 2.
C 21279 A.F.E. 4494	Retired July 2, 1923	Removal of tracks 5A6B(1) and 5A6B(2), 1685' and 763' in length including 2 No. 7 and 2 No. 8 turnouts, east P.S. of T-5A6B(2) was in T-5A6B(1) opposite station 231+04. T, east P.S. of T-5A6B(1) was at station 231+03.7. Tracks served Carbondale Mine No. 2, and were owned by Railroad Co.
C-20336 A.F.E. 4247	Installed Oct. 16, 1923.	Bridge No. 426 A, east S.W. of station 212+81.5, a Rail Top Bridge was replaced with a timber trestle. See also sheets No. 1 and 2.
C 31288 A.F.E. 13637	Completed Nov. 8, 1926	Renewal of Bridge No. 427 A, station 258+53.5.
C 32015 A.F.E. 14391	Completed Dec. 26, 1928	Relocate Grade Crossing State Road No. 56, station 213+83.0.

ATHENS CO. OHIO
WATERLOO TWP
T 11 R 15

ATHENS CO. OHIO
YORK TWP
T 12 R 15

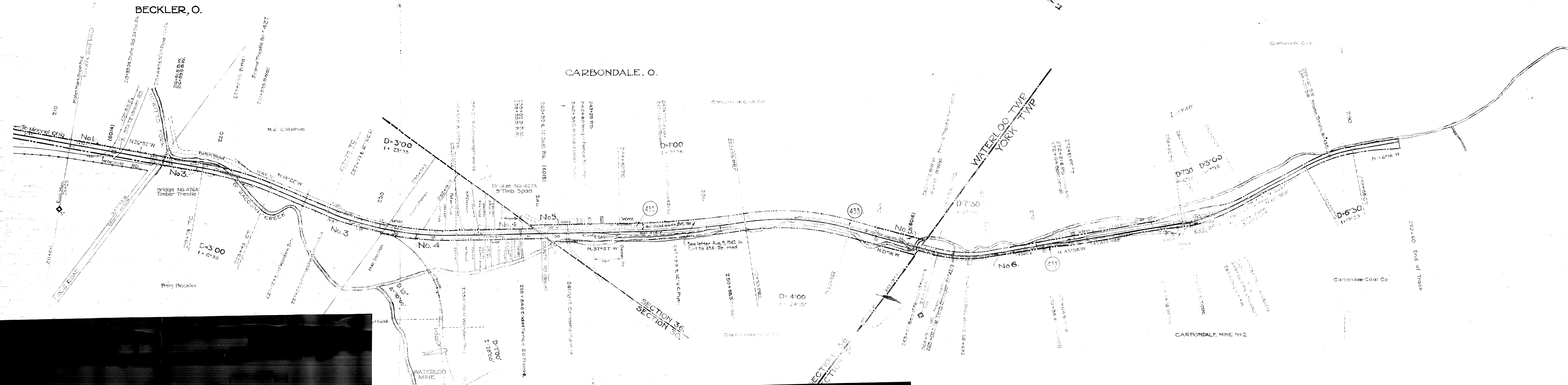

THIS PLAN IS PRESUMED TO BE CORRECT, BUT IS NOT WARRANTED UNTIL CHECKED AND APPROVED FOR PROPERTY LINES.

Note: All crossings were done on the right hand rail and all distances cut were measured from the center line of track.

Sheet No. 3 of 3 prepared and approved by the Surveyor & Co. S. H. ...
 Co. Ohio Div., C. T. ...
 300' N

A. M. ...
 Eng. ...

RIGHT-OF-WAY AND TRACK MAP
 THE BALTIMORE AND OHIO RAILROAD COMPANY
 OPERATED BY
THE BALTIMORE AND OHIO RAILROAD COMPANY
 OHIO DIVISION CARBONDALE BRANCH
 STATION 211+20 TO STATION 292+60
 SCALE: 1 IN. = 200 FT. JUNE 30, 1918
 OFFICE OF VALUATION ENGINEER
 BALTIMORE, MD.

REVISED TO
July 17, 1913
Oct. 27, 1914
Dec. 31, 1915
Dec. 23, 1916
June 1, 1918
June 16, 1918
Oct. 20, 1918
June 4, 1919